

EXHIBIT "A"

LEGAL DESCRIPTION

ESCROW NO.: 040801445

**The land referred to herein is situated in the
State of Nevada, County of Douglas
City of STATELINE described as follows:**

**Lot 3, of KINGSBURY VILLAGE SUBDIVISION UNIT NO. 3,
according to the map thereof, filed in the Office of the
County Record of Douglas County, State of Nevada, on August
12, 1963, Document No. 23166.**

Assessors Parcel No. 1319-19-210-003

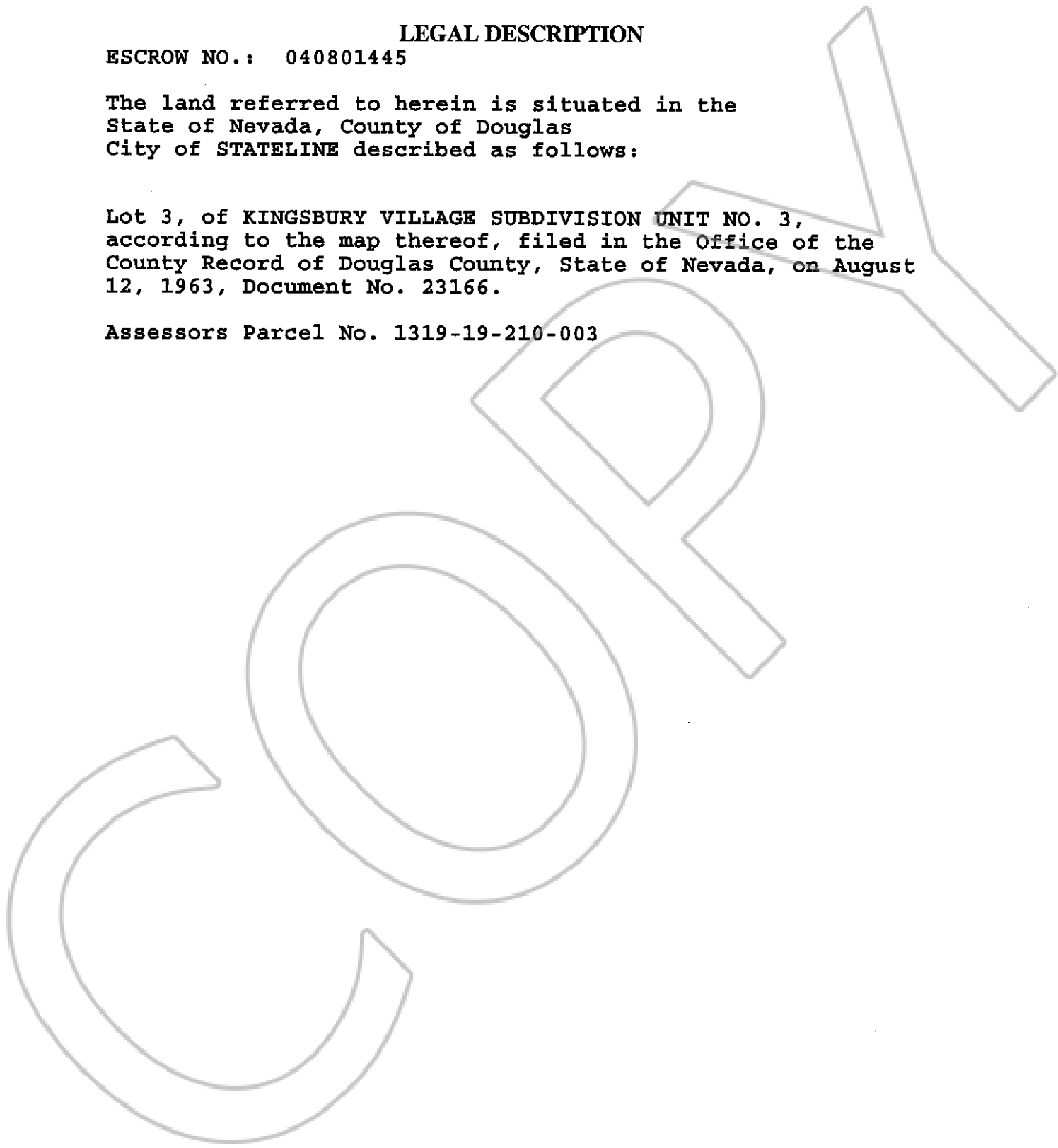

0615870

BK0604PG05717