

REQUESTED BY  
**MARQUIS TITLE & ESCROW**  
IN OFFICIAL RECORDS OF  
DOUGLAS CO., NEVADA

2004 JUN 14 AM 9:30

WERNER CHRISTEN  
RECORDER

\$16<sup>00</sup> PAID *KD* DEPUTY

*Exempt #5*

Assessor's Parcel No.: 1220-24-501-016

*526024 LCP* GRANT, BARGAIN AND SALE DEED

**THIS INDENTURE WITNESSETH;** That for a valuable consideration, receipt of which is hereby acknowledged,

**IVAN GENE LANDFATHER, JR., a married man , who acquired title as  
IVAN GENE LANDFATHER, JR., a single man**

**KIM L. LANDFATHER, a married woman, who acquired title as  
KIM L. COONROD, an unmarried woman**

**GRANT, BARGAIN SELL, and CONVEY to**

**IVAN GENE LANDFATHER, JR. and KIM L. LANDFATHER, husband and wife  
as joint tenants**

All that real property situated in the County of **Douglas** of Nevada, specifically described as follows:

**See Exhibit "A" attached hereto and made a part hereof**

Assessor's Parcel No: 1220-24-501-016

TOGETHER WITH all and singular the tenements, hereditaments, and appurtenances, including easement and water rights, if any, hereto belonging or in anywise appertaining, and any reversions, rents, issues, or profits thereof.

WITNESS my hand this *8th* day of June, 2004

*Ivan Gene Landfather Jr.*  
IVAN GENE LANDFATHER, JR.

*Kim L. Landfather*  
KIM L. LANDFATHER

0615976

BK0604PG06499

STATE OF NEVADA  
COUNTY OF Douglas

On 06/08/2004, personally appeared before me, a notary  
public, Ivan Gene Landfather Jr &

Kim L Landfather, who acknowledged that she

executed the above instrument.

WHEN RECORDED MAIL TO:

*Pat Rae Wallace*

Ivan Gene Landfather, Jr.  
Kim L. Landfather  
778 Mustang Lane  
Gardnerville, NV 89410

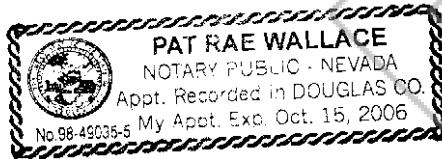

0615976

BK0604PG06500

"EXHIBIT A"

A parcel of land situated in and being a portion of the North ½ of the North ½ of the Northeast ¼ of Section 24, Township 12 North, Range 20 East, M.D.B. & M., more particularly described as follows:

Parcel D-3 of the parcel Map No. 3 for GARRY DENHEYER and CAROL JUNE DENHEYER recorded March 13, 1989, in Book 389, at Page 1681, as Document No. 198078, Official Records of Douglas County, Nevada.

Assessor's Parcel No.: 1220-24-501-016

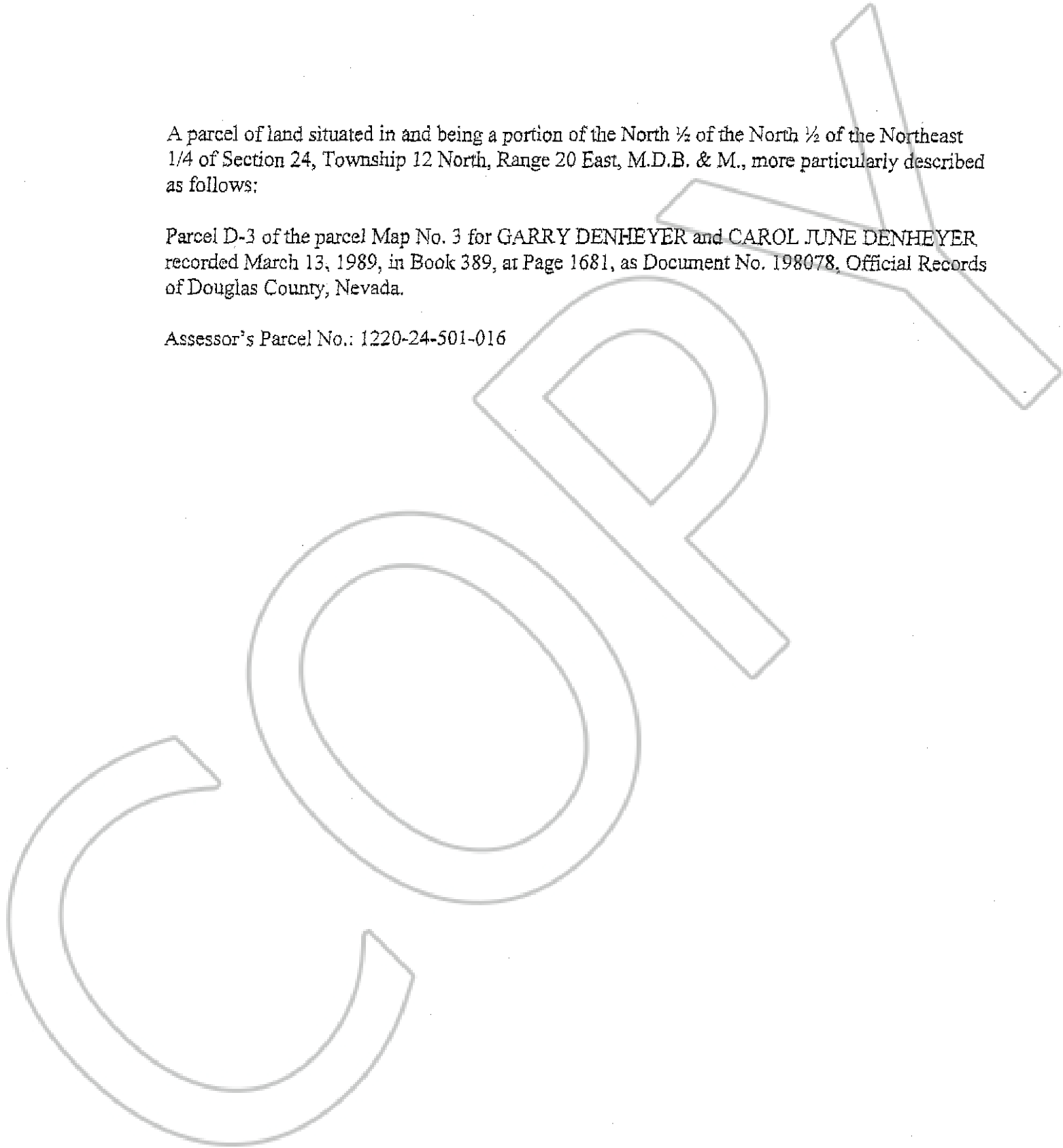

0615976

BK0604 PG06501