

A.P.N. # 1220-16-113-007

R.P.T.T. \$ 2086.50  
ESCROW NO. 040701510

RECORDING REQUESTED BY:  
**STEWART TITLE COMPANY**  
MAIL TAX STATEMENTS TO:  
**SAME AS BELOW**

WHEN RECORDED MAIL TO:  
**GRANTEE**  
**971 FIELDGATE WAY**  
**GARDNERVILLE, NV 89460**

(Space Above for Recorder's Use Only)

REQUESTED BY  
**Stewart Title of Douglas County**  
IN OFFICIAL RECORDS OF  
DOUGLAS CO., NEVADA

2004 JUN 14 PM 3:31

WERNER CHRISTEN  
RECORDER

\$15<sup>00</sup> PAID Kg DEPUTY

### GRANT, BARGAIN, SALE DEED

THIS INDENTURE WITNESSETH: That **LLOYD DOUGLAS STUMAN AND CATHY DARNLEY STUMAN, HUSBAND AND WIFE**

in consideration of \$10.00, the receipt of which is hereby acknowledged, does hereby Grant, Bargain Sell and Convey to **BETH AMOROSO AND LOUIS MC FADDEN, HUSBAND AND WIFE AS JOINT TENANTS**

and to the heirs and assigns of such Grantee forever, all that real property situated in the County of **Douglas** State of Nevada, bounded and described as:  
**SEE EXHIBIT "A" ATTACHED HERETO AND MADE A PART HEREOF**  
Together with all and singular the tenements, hereditaments and appurtenances thereunto belonging or in anywise appertaining, and any reversions, remainders, rents, issues or profits thereof.

DATE: **June 01, 2004**

*[Handwritten Signature]*  
**LLOYD DOUGLAS STUMAN**  
*[Handwritten Signature]*  
**CATHY DARNLEY STUMAN**

STATE OF NEVADA }  
  } ss.  
COUNTY OF CLARK }

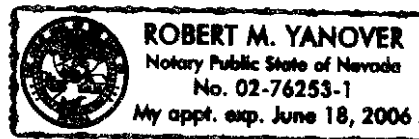

This instrument was acknowledged before me on \_\_\_\_\_  
by **LLOYD DOUGLAS STUMAN and CATHY DARNLEY STUMAN**

Signature *[Handwritten Signature]*  
Notary Public (One inch margin on all sides of document for Recorder's Use Only)

0616100

BK0604PG07163

**EXHIBIT "A"**

**LEGAL DESCRIPTION**

**ESCROW NO.: 040701510**

**The land referred to herein is situated in the  
State of Nevada, County of Douglas  
City of GARDNERVILLE described as follows:**

**Lot 41, in Block A, as shown on the final map of  
PLEASANTVIEW PHASE III, filed for record in the office of  
the County Recorder of Douglas County, State of Nevada, on  
December 4, 1992, in Book 1292, Page 815, as Document No.  
294729.**

**Assessors Parcel No. 1220-16-113-007**

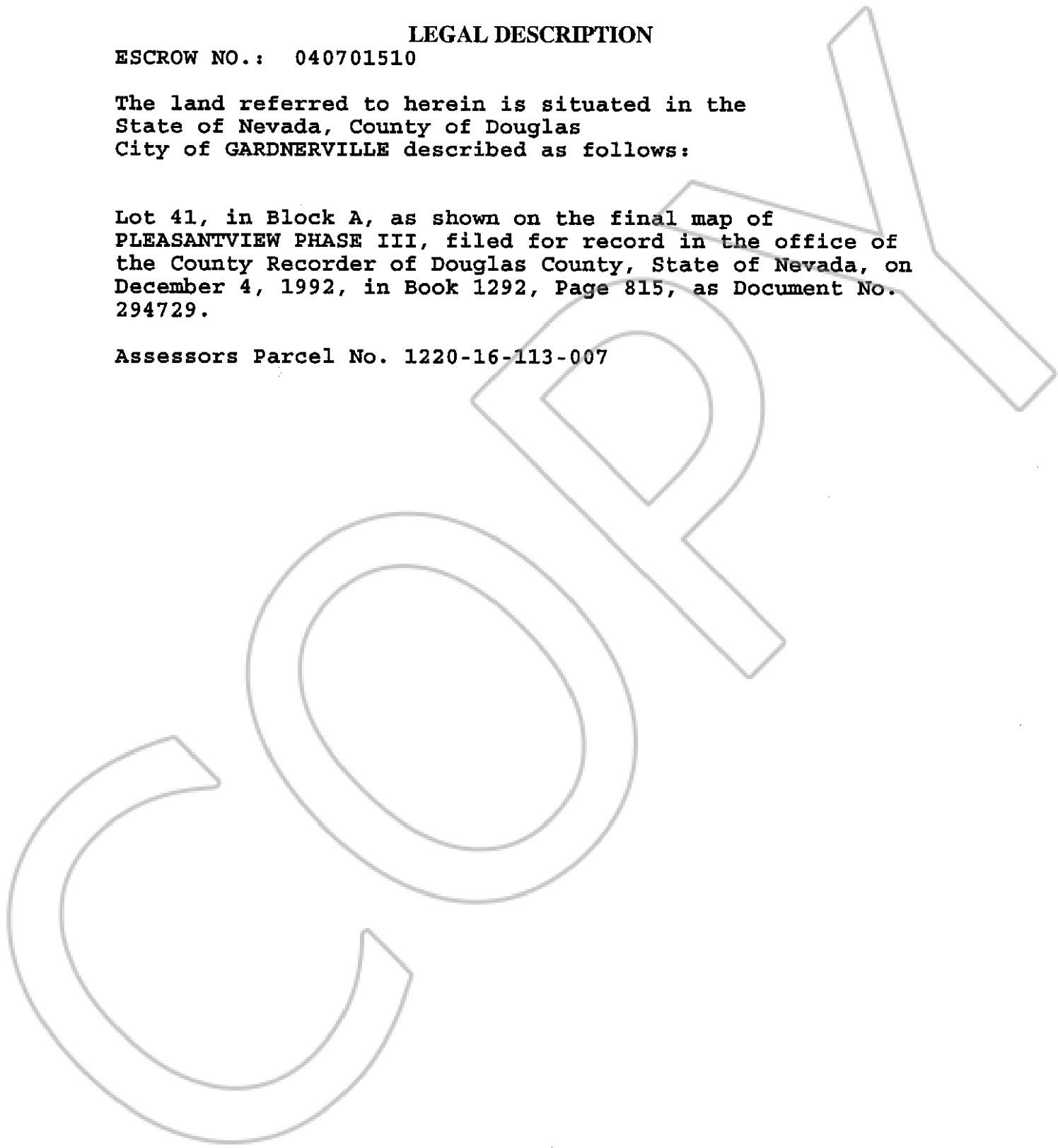

**0616100  
BK0604PG07164**