

A.P.N. # 1420-33-810-048

R.P.T.T. \$ 0#4

ESCROW NO. 040801573

RECORDING REQUESTED BY:
STEWART TITLE COMPANY
MAIL TAX STATEMENTS TO:
SAME AS BELOW

REQUESTED BY
Stewart Title of Douglas County
IN OFFICIAL RECORDS OF
DOUGLAS CO., NEVADA

2004 JUN 15 PM 3: 19

WERNER CHRISTEN
RECORDER

\$15⁰⁰ PAID kg DEPUTY

WHEN RECORDED MAIL TO:
MR. AND MRS RISHER
1369 JUDY STREET
MINDEN, NV 89423

(Space Above for Recorder's Use Only)

GRANT, BARGAIN, SALE DEED

THIS INDENTURE WITNESSETH: That **ROBERT SWINTEK and HELEN SWINTEK,**
Husband and Wife

in consideration of \$10.00, the receipt of which is hereby acknowledged, does hereby Grant, Bargain Sell
and Convey to **JAMES P RISHER AND LORETTA RISHER, Husband and**
Wife AS JOINT TENANTS

and to the heirs and assigns of such Grantee forever, all that real property situated in the
County of **DOUGLAS** State of Nevada, bounded and described as:

SEE EXHIBIT "A" ATTACHED HERETO AND MADE A PART HEREOF

Together with all and singular the tenements, hereditaments and appurtenances thereunto belonging or in
anywise appertaining, and any reversions, remainders, rents, issues or profits thereof

DATE: **June 03, 2004**

Robert Swintek
ROBERT SWINTEK

Helen Swintek
HELEN SWINTEK

STATE OF CALIFORNIA }
 } ss.
COUNTY OF SANTA CLARA }

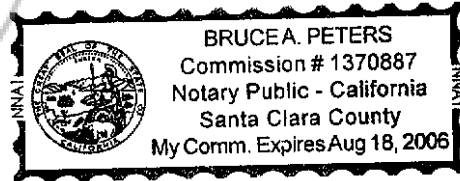

This instrument was acknowledged before me on 14 June 2004
by ROBERT SWINTEK and HELEN SWINTEK

Signature *Bruce A. Peters*
Notary Public (One inch margin on all sides of document for Recorder's Use Only)

0616194

BK0604 PG07726

EXHIBIT "A"

LEGAL DESCRIPTION

ESCROW NO.: 040801573

The land referred to herein is situated in the
State of Nevada, County of DOUGLAS
City of MINDEN described as follows:

Lot 31, as shown on the Official Map of IDLE ACRES
SUBDIVISION, filed in the office of the County Recorder of
Douglas County, Nevada, on April 5, 1960, in Book 01, Page
65 as File No. 15812.

APN 1420-33-810-048

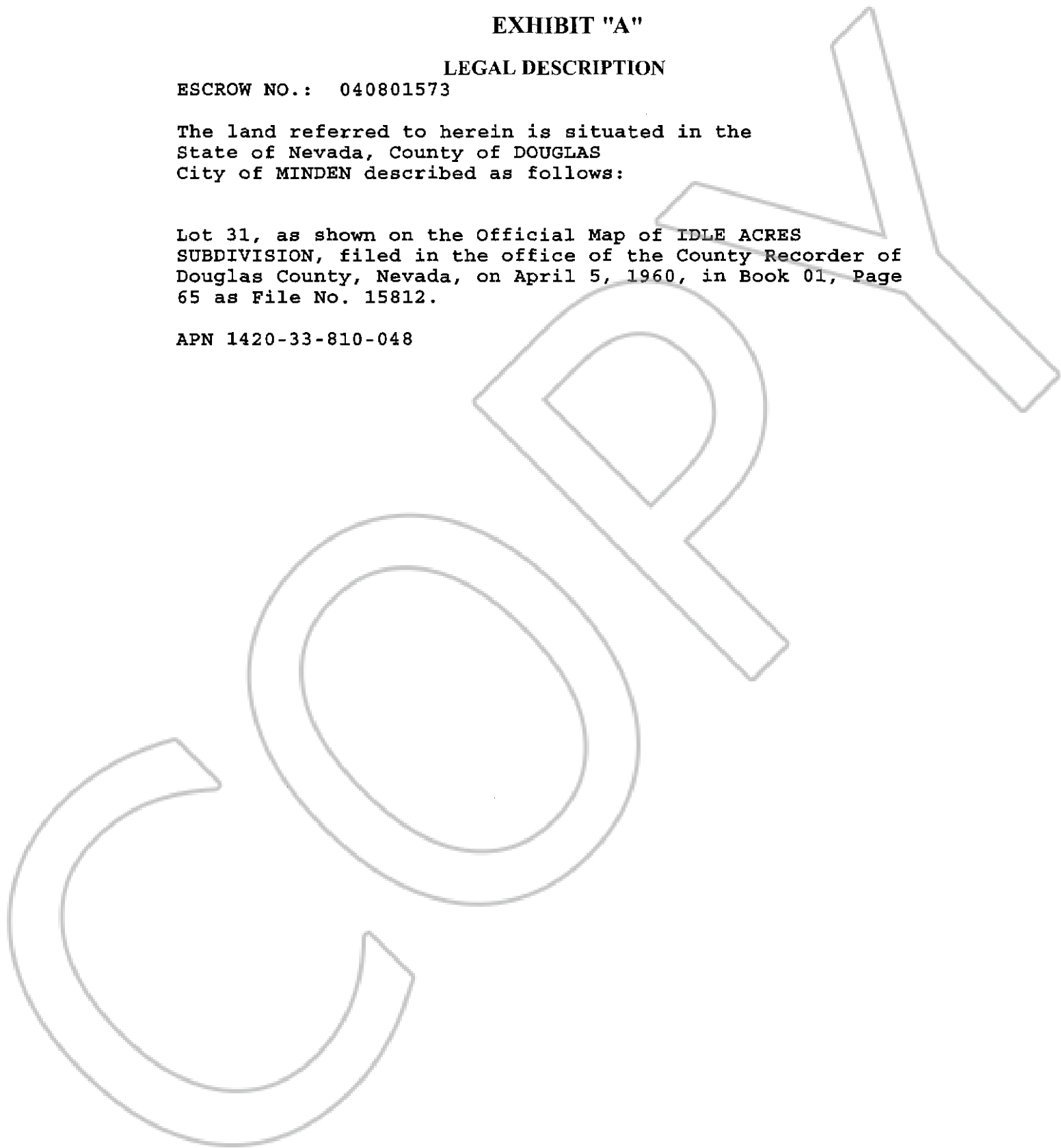

0616194

BK0604PG07727