

REQUESTED BY
WESTERN TITLE COMPANY, INC.
IN OFFICIAL RECORDS OF
DOUGLAS CO., NEVADA

APN: 1320-29-212-038
RPTT \$1,361.10 Full Value Full Value less liens

2004 JUN 16 PM 3:43

WERNER CHRISTEN
RECORDER

\$16⁰⁰ PAID *kg* DEPUTY

WHEN RECORDED MAIL TO:
Name HUGH STOCKERT
Street 1673 LANTANA DRIVE
Address
City,State MINDEN, NV
Zip 89423

MAIL TAX STATEMENTS TO:
Name HUGH STOCKERT
Street SAME AS ABOVE
Address
City,State
Zip
Order 00089823-201- KLS
No.

(SPACE ABOVE THIS LINE FOR RECORDERS USE)

GRANT, BARGAIN AND SALE DEED

THIS INDENTURE WITNESSETH: That

FOR A VALUABLE CONSIDERATION, receipt of which is hereby acknowledged, THOMAS GORDON DOOLEY AND BRENDA JOAN DOOLEY, TRUSTEES OF THE DECLARATION OF TRUST, DATED MAY 14, 1991, do(es) hereby GRANT(s) BARGAIN SELL and CONVEY to HUGH STOCKERT and JANET STOCKERT, HUSBAND AND WIFE AS COMMUNITY PROPERTY WITH RIGHT OF SURVIVORSHIP and to the heirs and assigns of such Grantee forever, all the following real property situated in the County of Douglas, State of Nevada bounded and described as follows:

See Exhibit A attached hereto and made a part hereof.

TOGETHER with all tenements, hereditaments and appurtenances, if any, thereto belonging or appertaining, and any reversions, remainders, rents, issues or profits thereof.

Dated: June 3, 2004

0616319

BK0604 PG08497

Thomas Gordon Dooley
THOMAS GORDON DOOLEY TRUSTEE

Brenda Joan Dooley
BRENDA JOAN DOOLEY TRUSTEE

STATE OF NEVADA

} ss

COUNTY OF Douglas

This instrument was acknowledged before me on
June 8, 2004

by Thomas Gordon Dooley & Brenda Joan Dooley



Kathy Swain
Notary Public

0616319

BK0604PG08498

Legal Description

All that real property situate in the County of Douglas, State of Nevada, described as follows:

Lot 112, in Block B, on Official Map of WINHAVEN UNIT NO. 1, a planned unit development, according to the map thereof, filed in the office of the County Recorder of Douglas County, State of Nevada, on January 13, 1989, in Book 189, Page 1590, as Document No. 194373.

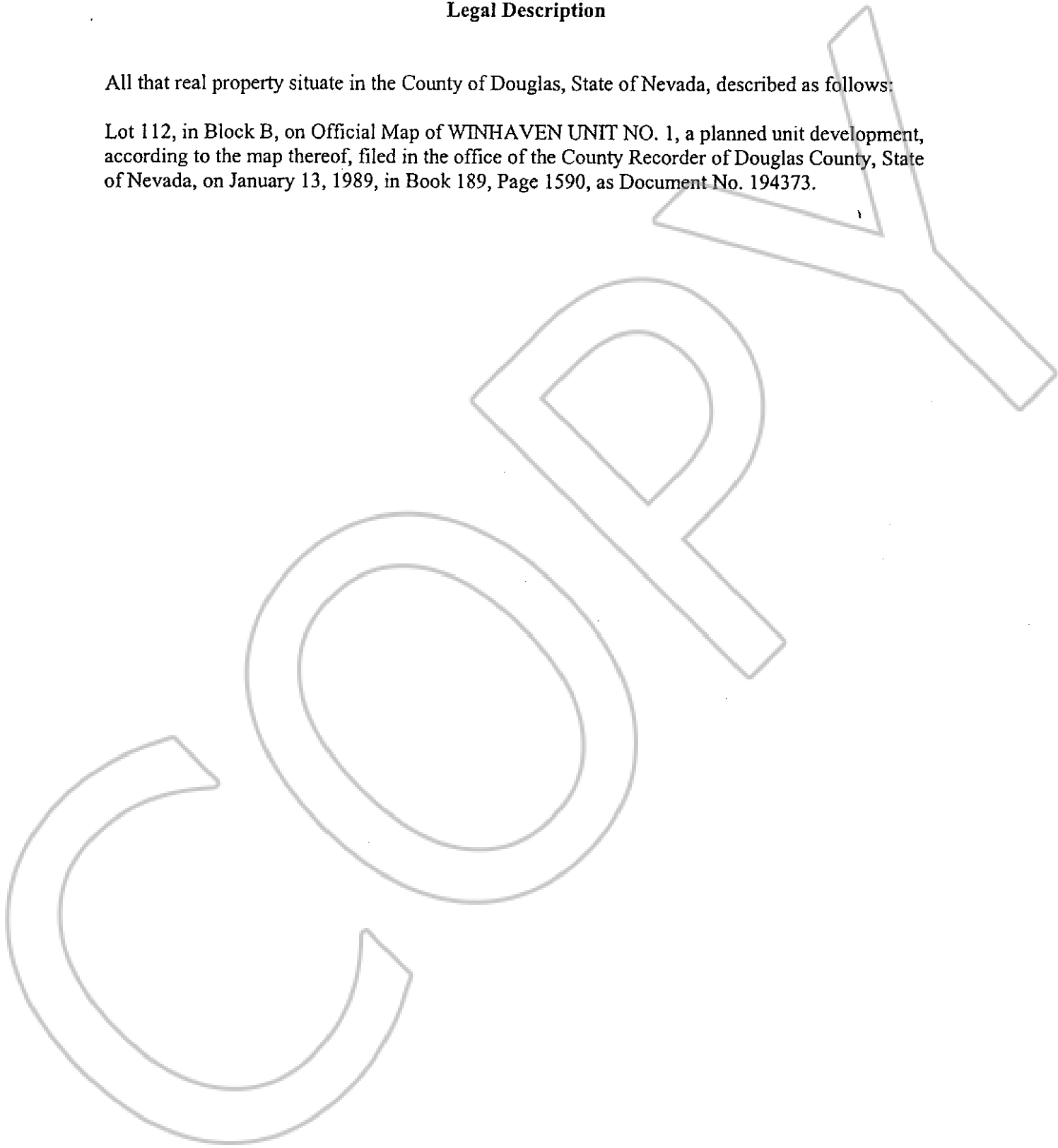

0616319

BK0604PG08499