

EXHIBIT "A"

LEGAL DESCRIPTION

ESCROW NO.: 040701525

The land referred to herein is situated in the
State of Nevada, County of Douglas
City of GARDNERVILLE described as follows:

Lot 265, as said lot is shown on the Official Plat of
GARDNERVILLE RANCHOS UNIT NO. 2, filed in the office of the
County Recorder of Douglas County, Nevada, on June 1, 1965,
in Book 1 of Maps, filed as No. 28309, and Title Sheet
amended on June 4, 1965, as Filing No. 28377.

Assessor's Parcel No. 1220-16-510-078

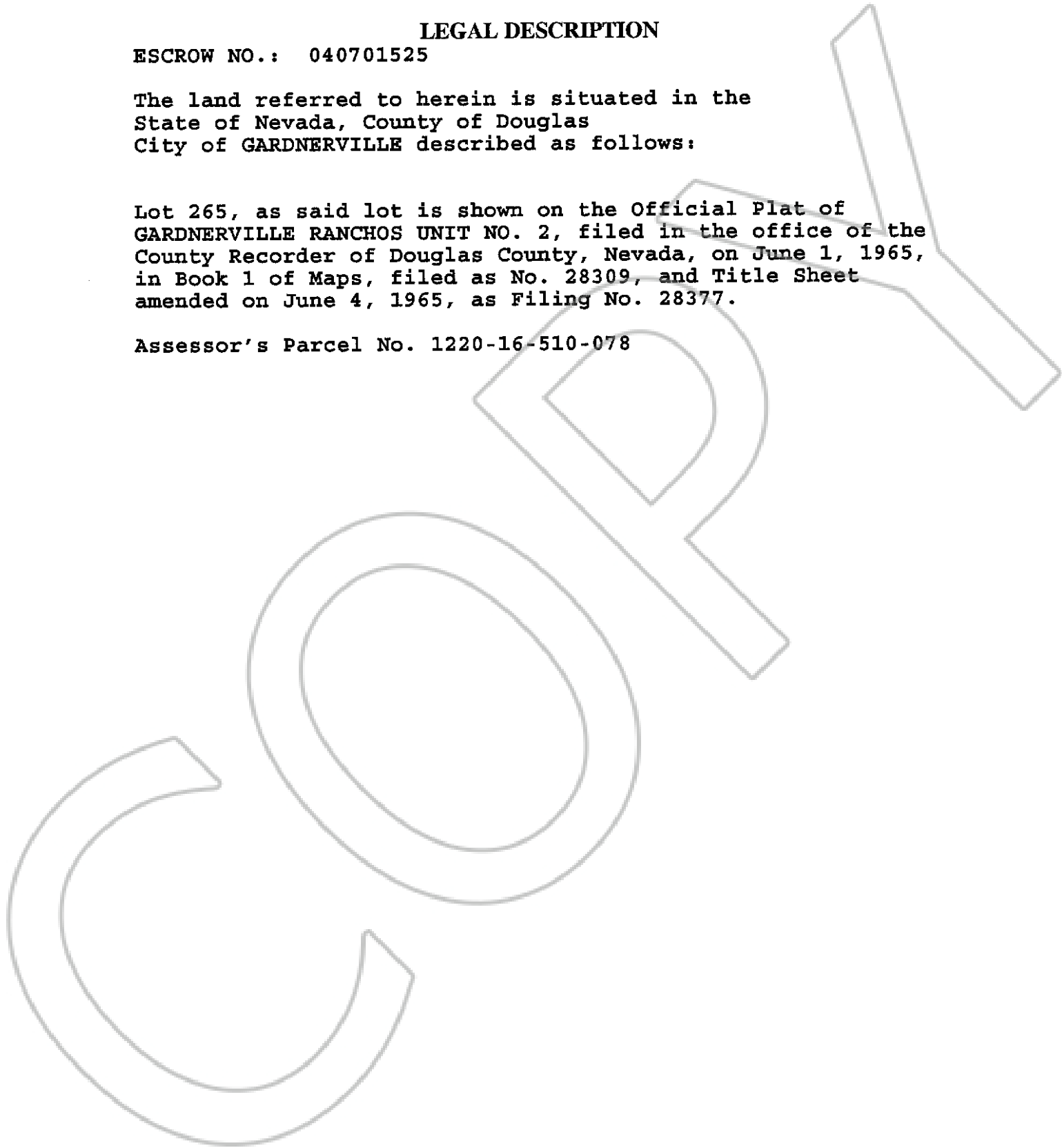

0616397

BK 0604 PG 08893