

EXHIBIT "A"

LEGAL DESCRIPTION

ESCROW NO.: 040200988

The land referred to herein is situated in the State of Nevada, County of Douglas City of STATELINE described as follows:

Lot 2, as shown on the Condominium Map of Lot 535, SECOND AMENDED MAP OF SUMMIT VILLAGE SUBDIVISION recorded May 27, 1982 in Book 582, Page 1539, as Document No. 68136, of Official Records of Douglas County, State of Nevada.

Assessor's Parcel No. 1319-19-712-002

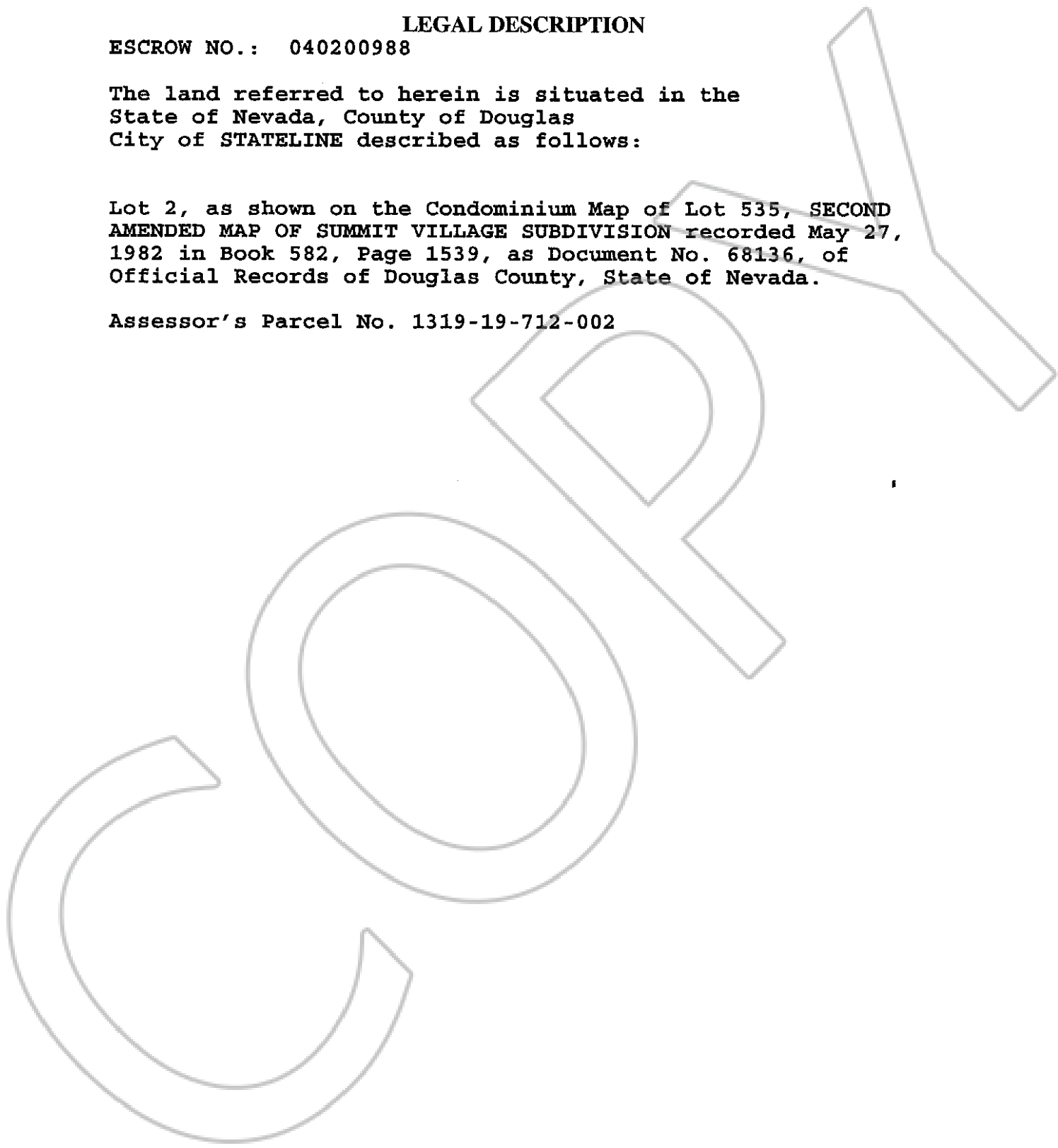

0616502

BK0604PG09370