

A.P.N. # 1420-07-214-010

R.P.T.T. \$ #5

ESCROW NO. 040301908

RECORDING REQUESTED BY:
STEWART TITLE COMPANY
MAIL TAX STATEMENTS TO:
SAME AS BELOW

WHEN RECORDED MAIL TO:
GREGORY A. MALAVAZOS
3537 SILVERADO DRIVE
CARSON CITY, NV 89705

REQUESTED BY
Stewart Title of Douglas County

IN OFFICIAL RECORDS OF
DOUGLAS COUNTY, NEVADA

2004 JUN 23 PM 3:09

WERNER CHRISTEN
RECORDER

\$15.00 PAID KO DEPUTY

(Space Above for Recorder's Use Only)

GRANT, BARGAIN, SALE DEED

THIS INDENTURE WITNESSETH: That **CAROL J. MALAVAZOS, spouse of**
Grantee herein

in consideration of \$10.00, the receipt of which is hereby acknowledged, does hereby Grant, Bargain Sell
and Convey to **GREGORY A. MALAVAZOS, a married man as his sole and**
separate property

and to the heirs and assigns of such Grantee forever, all that real property situated in the
County of **DOUGLAS** State of Nevada, bounded and described as :

SEE EXHIBIT "A" ATTACHED HERETO AND MADE A PART HEREOF

IT IS THE EXPRESS INTENT OF THE GRANTOR, BEING THE SPOUSE OF THE GRANTEE, TO
CONVEY ALL RIGHT, TITLE AND INTEREST OF THE GRANTOR, COMMUNITY OR OTHERWISE,
IN AND TO THE HEREIN DESCRIBED PROPERTY TO THE GRANTEE AS GRANTEE'S SOLE AND
SEPARATE PROPERTY.

Together with all and singular the tenements, hereditaments and appurtenances thereunto belonging or in
anywise appertaining, and any reversions, remainders, rents, issues or profits thereof.

DATE: **June 14, 2004**

Carol J. Malavazos
CAROL J. MALAVAZOS

STATE OF California

COUNTY OF El Dorado ss.

This instrument was acknowledged before me on June 19 2004
by, **CAROL J. MALAVAZOS**

Signature Becky Campini
Notary Public (One-inch Margin on all sides of Document for Recorder's Use Only)



0616919

BK0604PG11689

EXHIBIT "A"

LEGAL DESCRIPTION

ESCROW NO.: 040301908

The land referred to herein is situated in the State of Nevada, County of DOUGLAS described as follows:

Lot J10, as shown on the Final Map #97-1007-7 of VALLEY VISTA ESTATES, PHASE 6 recorded in the office of the Douglas County Recorder, State of Nevada, on April 24, 2002, in Book 0402, at Page 7191, as Document No. 540408, Official Records.

ASSESSOR'S PARCEL NO. 1420-07-214-010

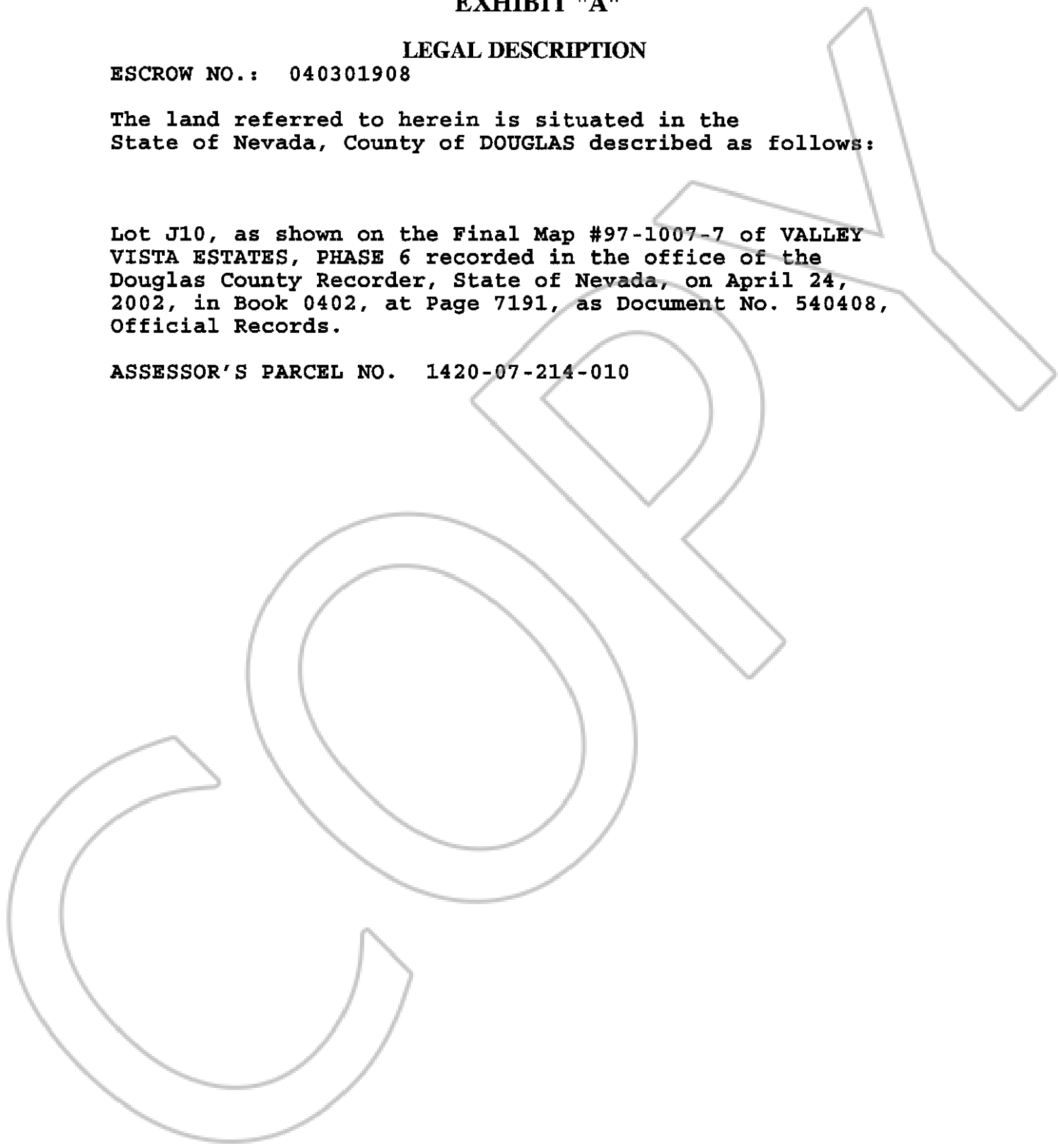

0616919

BK0604PG11690