

EXHIBIT "A"

LEGAL DESCRIPTION

ESCROW NO.: 040801558

The land referred to herein is situated in the State of Nevada, County of Douglas City of GARDNERVILLE described as follows:

Lot 14, Block K, as shown on the map of GARDNERVILLE RANCHOS UNIT NO. 4, filed in the office of the County Recorder of Douglas County, Nevada, on April 10, 1967, as Document No. 35914.

Assessors Parcel No. 1220-15-310-029

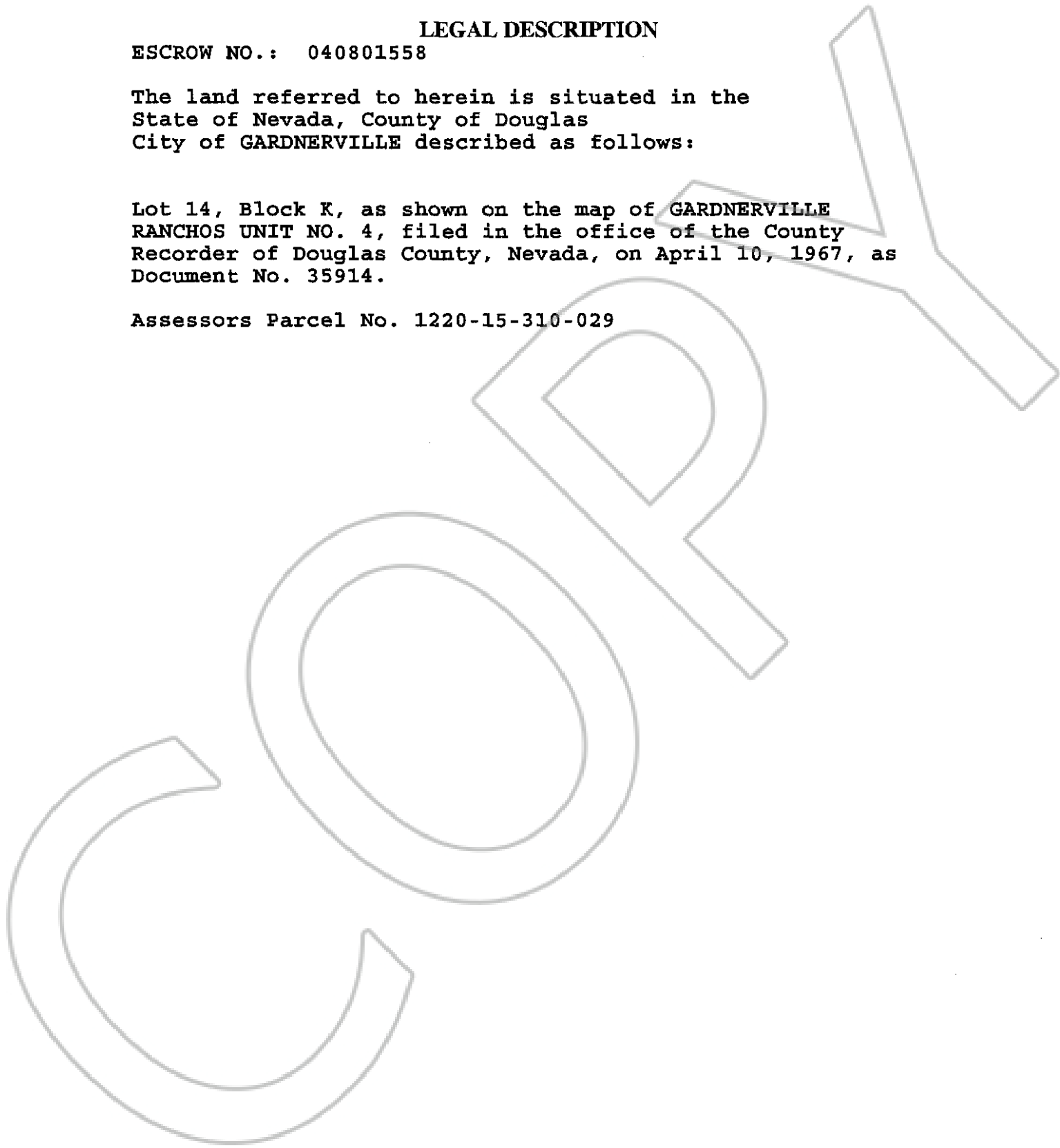

0617168

BK0604PG12794