

A.P.N. # 1320-32-610-002

R.P.T.T. \$ 1092.00

ESCROW NO. 040801588

RECORDING REQUESTED BY:

STEWART TITLE COMPANY

MAIL TAX STATEMENTS TO:

SAME AS BELOW

WHEN RECORDED MAIL TO:

GRANTEE

1525 WILDROSE DRIVE

MINDEN, NEVADA 89423

REQUESTED BY
Stewart Title of Douglas County

IN OFFICIAL RECORDS OF
DOUGLAS COUNTY, NEVADA

2004 JUN 30 PM 3:17

WERNER CHRISTEN
RECORDER

\$ 1500 PAID BR DEPUTY

(Space Above for Recorder's Use Only)

GRANT, BARGAIN, SALE DEED

THIS INDENTURE WITNESSETH: That **DANIEL D. MAKLEY AND GAIL A. MAKLEY, HUSBAND AND WIFE**

in consideration of \$10.00, the receipt of which is hereby acknowledged, does hereby Grant, Bargain Sell and Convey to

JULIE HOOPER, A MARRIED WOMAN AS HER SOLE AND SEPARATE PROPERTY

and to the heirs and assigns of such Grantee forever, all that real property situated in the County of **Douglas** State of Nevada, bounded and described as:

SEE EXHIBIT "A" ATTACHED HERETO AND MADE A PART HEREOF

Together with all and singular the tenements, hereditaments and appurtenances thereunto belonging or in anywise appertaining, and any reversions, remainders, rents, issues or profits thereof.

DATE: **June 14, 2004**

Daniel D. Makley

DANIEL D. MAKLEY

Gail A. Makley

GAIL A. MAKLEY

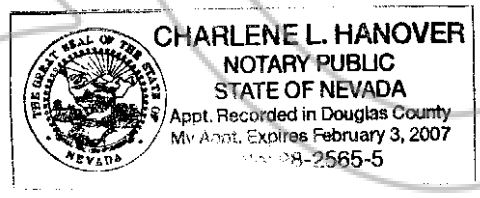

STATE OF NEVADA }

COUNTY OF DOUGLAS } ss.

This instrument was acknowledged before me on 6/24/2004
by DANIEL D. MAKLEY and GAIL A. MAKLEY

Signature *Charlene L. Hanover*

Notary Public (One inch margin on all sides of document for Recorder's Use Only)

0617585
BK0604PG15081

EXHIBIT "A"

LEGAL DESCRIPTION

ESCROW NO.: 040801588

The land referred to herein is situated in the State of Nevada, County of Douglas City of MINDEN described as follows:

Lot 11, in Block 1, as shown on the map of WILDROSE SUBDIVISION PLAT NO. 2, filed in the office of the County Recorder of Douglas County, Nevada on December 5, 1966 as Document No. 34825.

Assessors Parcel No. 1320-32-610-002

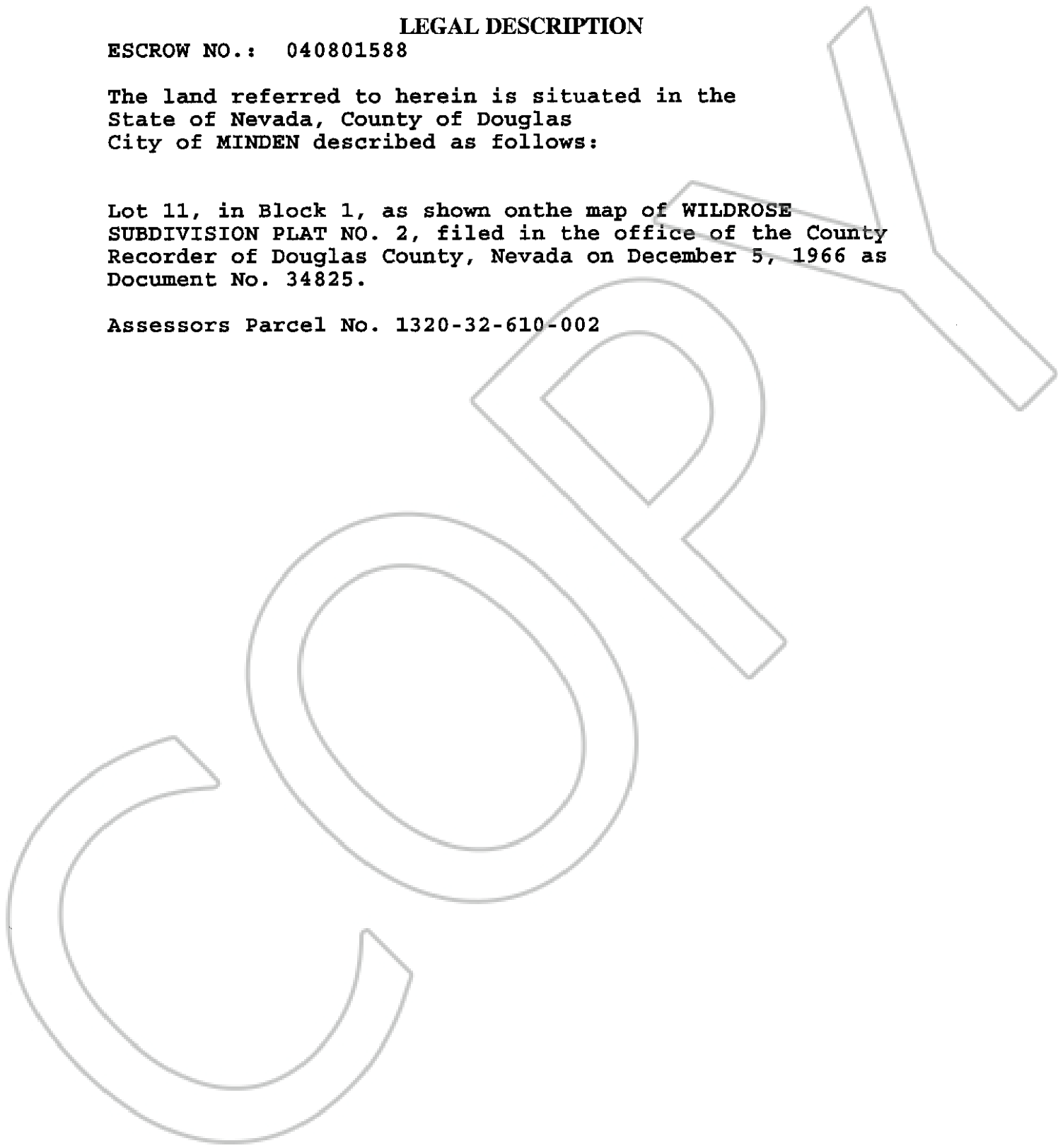

0617585

BK0604PG15082