

Assessor's Parcel Number: 1320-33-816-055

Recording Requested By:

Name: FIRST AMERICAN TITLE

Address: 1512 Highway 395 North #1

City/State/Zip Gardnerville, NV 89410

R.P.T.T.: Ø #3

REQUESTED BY  
**FIRST AMERICAN TITLE CO.**  
IN OFFICIAL RECORDS OF  
DOUGLAS CO., NEVADA

2004 JUL -8 PM 4: 38

WERNER CHRISTEN  
RECORDER

\$17<sup>00</sup> PAID BR DEPUTY

Grant Deed  
(Title of Document)

This document being re-recorded to add correct legal description

This page added to provide additional information required by NRS 111.312 Sections 1-2. (Additional recording fee applies)

*This cover page must be typed or legibly hand printed.*

C:\bc docs\Cover page for recording

0618278  
BK0704PG03327

REQUESTED BY  
**FIRST AMERICAN TITLE CO.**

IN OFFICIAL RECORDS OF  
DOUGLAS CO., NEVADA

2004 JUL -2 PM 1:02

WERNER CHRISTEN  
RECORDER

\$15.00 PAID CF DEPUTY

A.P. No. 1320-32-801-004

R.P.T.T. \$0.00 #6

WHEN RECORDED MAIL TO:  
West Ridge Homes, Inc.  
1528 Hwy 395, Suite 215  
Gardnerville, NV 89410  
MAIL TAX STATEMENT TO:  
Same as Above

**GRANT, BARGAIN and SALE DEED**

FOR A VALUABLE CONSIDERATION, receipt of which is hereby acknowledged,  
West Ridge Homes, Inc. A Nevada Corporation

do(es) hereby GRANT, BARGAIN and SELL to Peter M. Beekhof, Jr. and Linda S Beekhof,  
Trustees of the Beekhof Family Trust dated November 9, 1995

the real property situate in the County of Douglas, State of Nevada, described as follows:  
See Exhibit "A"

TOGETHER with all tenements, hereditaments and appurtenances, including easements and water rights,  
if any, thereto belonging or appertaining, and any reversions, remainders, rents, issues or profits thereof.

Date: 11/11/2003

THIS INSTRUMENT IS BEING RECORDED AS AN  
ACCOMODATION ONLY. NO LIABILITY, EXPRESS  
OR IMPLIED, IS ASSUMED AS TO ITS REGULARITY  
OR SUFFICIENCY NOR AS TO ITS EFFECT, IF ANY,  
UPON TITLE TO ANY REAL PROPERTY DESCRIBED  
HEREIN

FIRST AMERICAN TITLE CO.

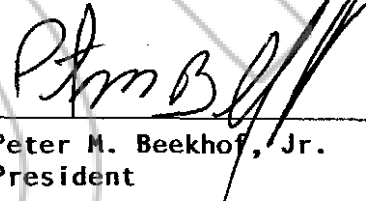
  
Peter M. Beekhof, Jr.  
President

STATE OF NEVADA )  
  ) :SS.  
COUNTY OF DOUGLAS )

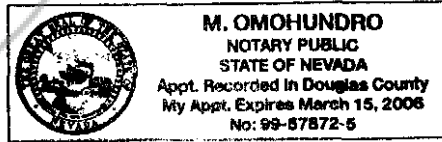

This instrument was acknowledged before me on  
3/15/04 by  
Peter M. Beekhof, Jr.

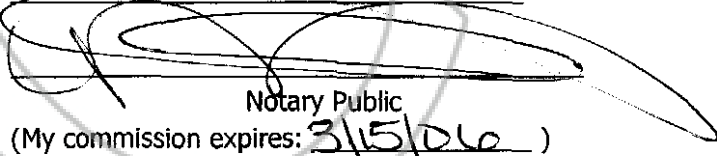
  
Notary Public  
(My commission expires: 3/15/06)

0618278

0617835

BK 0704 PG 03328

BK 0704 PG 01001

EXHIBIT "A"  
LEGAL DESCRIPTION

*see Attached  
Exhibit "A"*

A portion of the Southeast 1/4 of Section 32, Township 13 North, Range 20 East, M.D.B. & M. described as follows:

PARCEL 1:

Parcel 2 as shown on the Parcel Map for MATHILDA HUSSMAN "RESUBDIVISION OF PARCEL MAP NO. 87157" recorded December 16, 1977 in Book 1277, Page 729, Document No. 15874, Official Records, Douglas County, Nevada.

APN 1320-32-801-004

PARCEL 2:

An appurtenant perpetual private road easement, with incidents thereto dated February 27, 1984, executed by MATHILDA HUSSMAN, recorded March 8, 1984, in Book 384, of Official Records, at Page 648, Douglas County, Nevada, as Document No. 097890.

THIS INSTRUMENT IS BEING RECORDED AS AN ACCOMODATION ONLY. NO LIABILITY, EXPRESS OR IMPLIED, IS ASSUMED AS TO ITS REGULARITY OR SUFFICIENCY NOR AS TO ITS EFFECT, IF ANY, UPON TITLE TO ANY REAL PROPERTY DESCRIBED THEREIN

FIRST AMERICAN TITLE CO.

0618278

BK0704PG03329

0617835

BK0704PG01002

EXHIBIT "A"

LEGAL DESCRIPTION

LOT 28, BLOCK B AS SET FORTH ON FINAL SUBDIVISION MAP NO. 1006-11 FOR CHICHESTER ESTATES, PHASE 11, FILED IN THE OFFICE OF THE COUNTY RECORDER OF DOUGLAS COUNTY, NEVADA AND RECORDED DECEMBER 27, 2002 IN BOOK 1202, PAGE 12732, AS DOCUMENT NO. 562225, AND BY CERTIFICATE OF AMENDMENT RECORDED MARCH 27, 2003 IN BOOK 0303, PAGE 13037, AS DOCUMENT NO. 0571430.

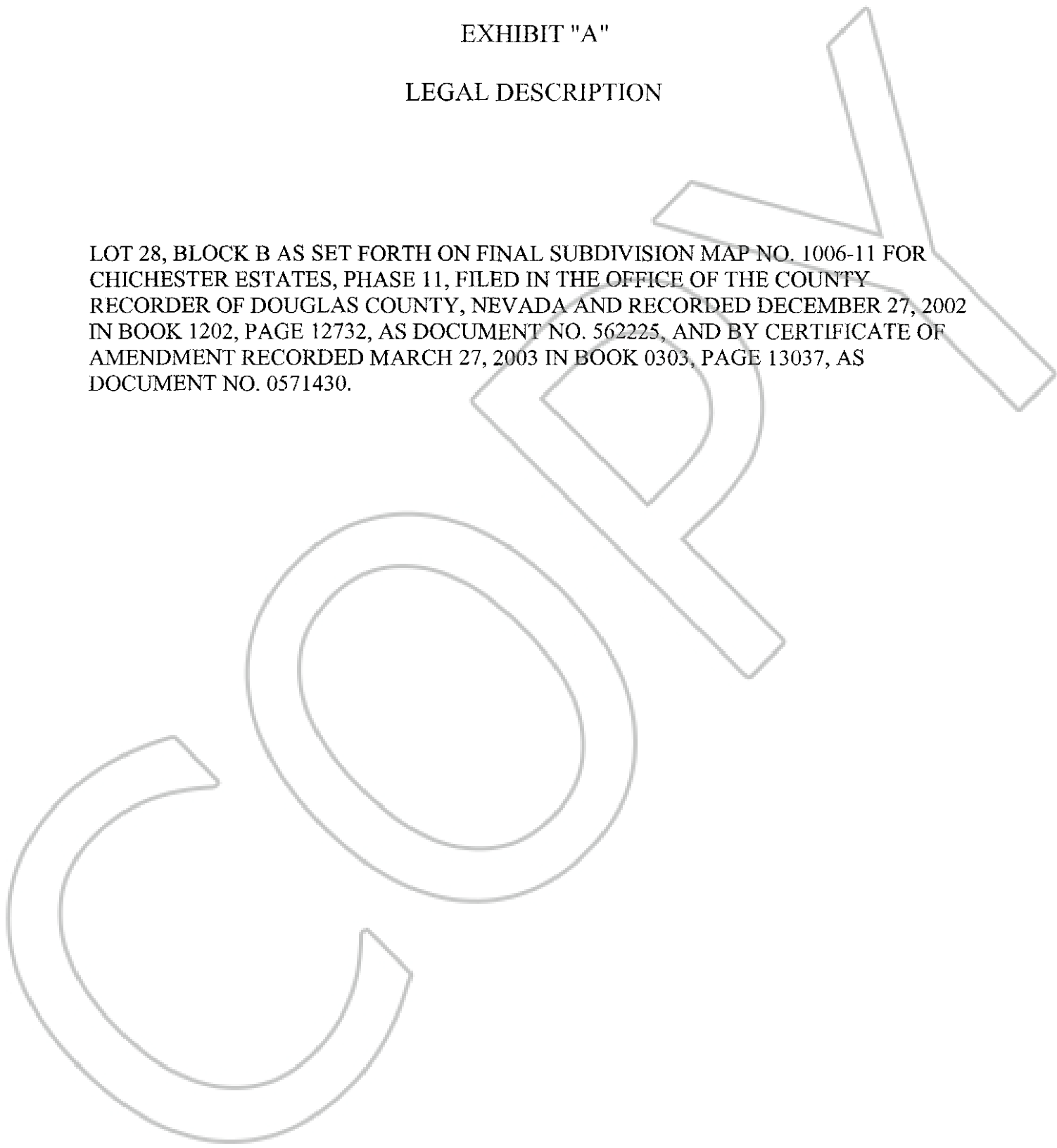

0618278

BK0704PG03330