

41-

REQUESTED BY  
*Peelle Mgmt Corp*  
IN OFFICIAL RECORDS OF  
DOUGLAS CO., NEVADA

2004 JUL -9 PM 2:47

WERNER CHRISTEN  
RECORDER

\$41<sup>00</sup> PAID *Kj* DEPUTY

APN NUMBER:

*8880088*

TITLE OF DOCUMENT:  
ASSIGNMENT OF DEED OF TRUST

RECORDING REQUESTED BY:  
PEELLE MANAGEMENT CORPORATION

RETURN TO:  
SEE ATTACHED

When Recorded, Return to:  
✓ PEELLE ASSIGNMENT DIVISION  
P.O. BOX 30014  
RENO, NV 89520-3014  
JOB #

This page added to provide additional information required by NRS 111.312 Sections 1-2.  
(Additional recording fee applies.)

This cover page must be typed or printed clearly in black ink only.

0618377

BK0704 PG03702

NCMC Loan Number: 0002879776  
ALTEPETER, LAWRENCE 0000803582

When Recorded, Return to:  
PEELLE ASSIGNMENT DIVISION  
P.O. BOX 30014  
RENO, NV 89520-3014  
JOB # 815

**ASSIGNMENT OF MORTGAGE AND PROMISSORY NOTE**

27.005  
8880088  
7788

FOR VALUE RECEIVED, **National City Mortgage Co.**, an Ohio Corporation, 3232 Newmark Drive, Miamisburg Ohio 45342 (NCMC), hereby sells, transfers, sets over, and assigns to:

**Deutsche Bank Trust Company Americas As Trustee  
F/k/a Bankers Trust Company, as Trustee  
3 Park Plaza, Irvine, CA 92714-8539**

NCMC's, entire right, title, and interest in and to the following described mortgage (the Mortgage) and promissory note (the Promissory Note) which are dated 11/3/03, and are in the original principal amount of **\$ \$201,000.00**. The Mortgage is described and identified by the following name(s) of the mortgagor(s), the date of recording, instrument number, and/or book number as recorded in Douglas County, NV.

<u>MORTGAGOR(S)</u>	<u>INSTRUMENT NUMBER</u>	<u>BOOK &amp; PAGE</u>
LAWRENCE J ALTEPETER VALERIE K ALTEPETER	# 0556168	bx. 1103 Pg. 03218

IN TESTIMONY WHEREOF, said **National City Mortgage Co** has hereunto set its hands this date, November 24, 2003.

**National City Mortgage Co**

BY: \_\_\_\_\_  
Name: **Cheryl Kreutzer**  
Title: **Mortgage Officer**

STATE OF TEXAS ) SS:  
COUNTY OF DALLAS

On this date, November 24, 2003, before me, the undersigned, a Notary Public in and for said County and State, personally appeared **Cheryl Kreutzer**, the **Mortgage Officer** for an on behalf of **National City Mortgage Co.**, and duly authorized to do so acknowledged the execution of the foregoing Assignment of Mortgage and Promissory Note as its voluntary act and deed for the uses and purposes therein contained.

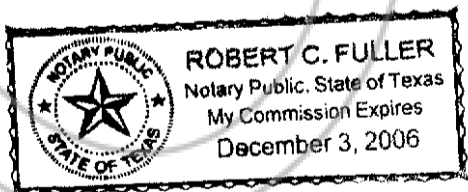

\_\_\_\_\_  
Robert C. Fuller Notary Public

My Commission Expires: 12/3/06 My County of Residence: **Dallas**

This Instrument Prepared by: **National City Mortgage Co**

0618377  
BK0704 PG03703

**Legal Description**

All that real property situate in the County of Douglas, State of Nevada, described as follows:

Lot 20, as set forth on that Subdivision Map entitled WILDHORSE ANNEX UNIT NO. 1, a Planned Unit Development, recorded January 6, 1994, in Book 194, Page 1080, Official Records of Douglas County, State of Nevada, as Document No. 327012.

Excepting therefrom all minerals, oil, gas and other hydrocarbons, as excepted in the Deed to STOCK PETROLEUM CO., INC., recorded March 13, 1980, in Book 380, Page 1315, Official Records of Douglas County, Nevada, as Document No. 42677.

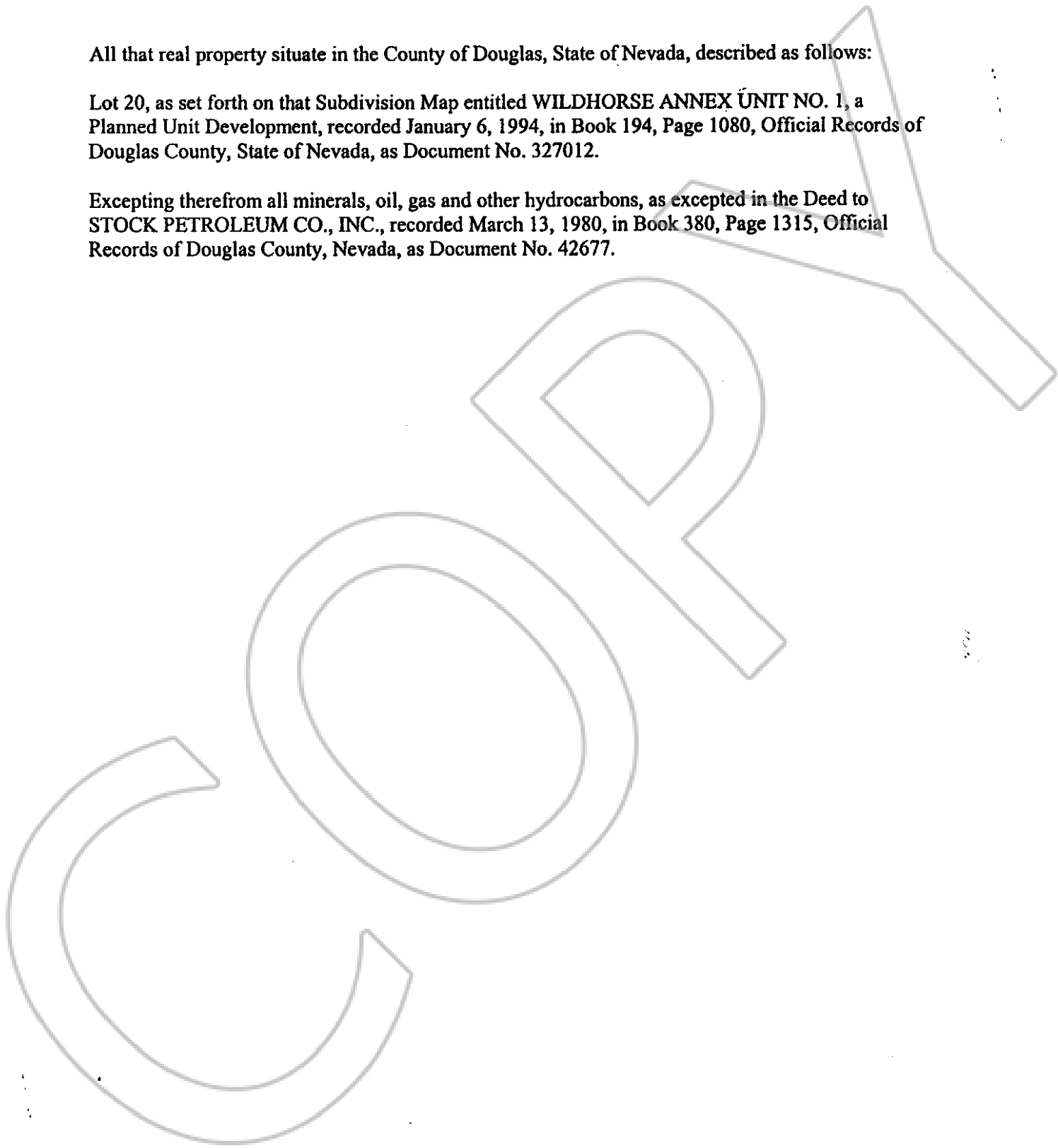

0618377

BK 0704 PG 03704