

A.P.N. # 1221-04-001-016
R.P.T.T. \$ 670.80
ESCROW NO. 040801406
RECORDING REQUESTED BY:
STEWART TITLE COMPANY
MAIL TAX STATEMENTS TO:
SAME AS BELOW

WHEN RECORDED MAIL TO:
GRANTEE
P.O. BOX 2478
STATELINE, NEVADA 89449

REQUESTED BY
Stewart Title of Douglas County
IN OFFICIAL RECORDS OF
DOUGLAS CO., NEVADA
2004 JUL -9 PM 3: 33
WERNER CHRISTEN
RECORDER
\$15⁰⁰ PAID KJ DEPUTY

(Space Above for Recorder's Use Only)

GRANT, BARGAIN, SALE DEED

THIS INDENTURE WITNESSETH: That **KENT R. NEDDENRIEP AND MARIE C. JOHNSON, HUSBAND AND WIFE**

in consideration of \$10.00, the receipt of which is hereby acknowledged, does hereby Grant, Bargain Sell and Convey to **CHRISTIAN B. BURKE AND MARILYN G. BURKE, HUSBAND AND WIFE** AS COMMUNITY PROPERTY WITH RIGHT OF SURVIVORSHIOP

and to the heirs and assigns of such Grantee forever, all that real property situated in the County of **Douglas** State of Nevada, bounded and described as:

SEE EXHIBIT "A" ATTACHED HERETO AND MADE A PART HEREOF

Together with all and singular the tenements, hereditaments and appurtenances thereunto belonging or in anywise appertaining, and any reversions, remainders, rents, issues or profits thereof.

DATE: **July 01, 2004**

Kent R. Neddenriep

KENT R. NEDDENRIEP
Marie C. Johnson

MARIE C. JOHNSON

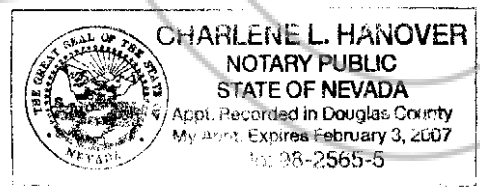

STATE OF NEVADA }
 } ss.
COUNTY OF DOUGLAS }

This instrument was acknowledged before me on 7/7/2004,
by **KENT R. NEDDENRIEP and MARIE C. JOHNSON**

Signature *Charlene L. Hanover*
Notary Public (One inch margin on all sides of document for Recorder's Use Only)

0618400
BK0704PG03829

EXHIBIT "A"

LEGAL DESCRIPTION

ESCROW NO.: 040801406

The land referred to herein is situated in the
State of Nevada, County of Douglas
City of GARDNERVILLE described as follows:

Lot 2, as set forth on FINAL SUBDIVISION MAP PD 03-009, for
BLUE SKY, filed in the office of the County Recorder of
Douglas County, State of Nevada on May 27, 2004, in Book
0504, Page 13571, as Document No. 614400.

ASSESSOR'S PARCEL NO. 1221-04-001-016

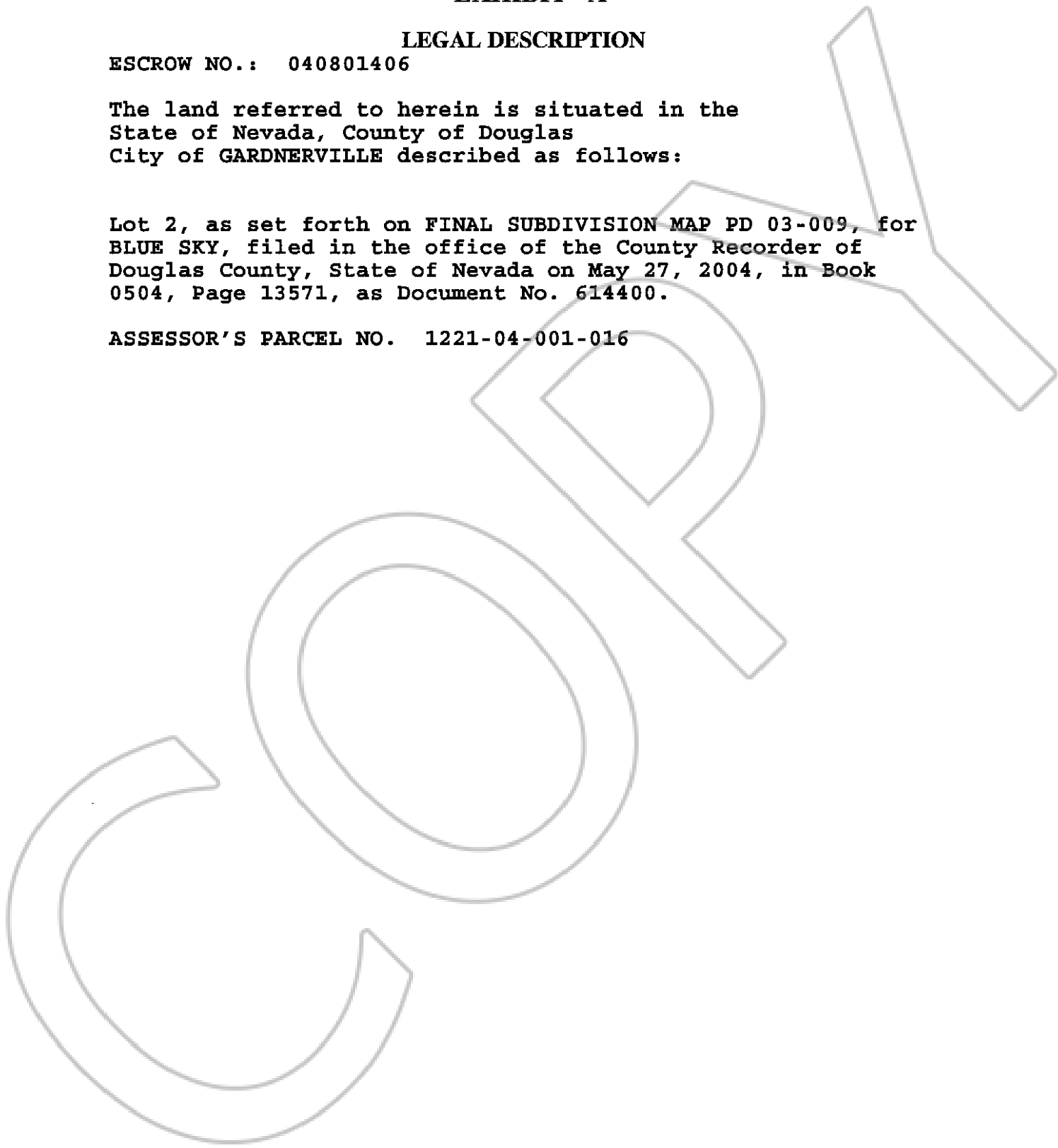

0618400

BK0704PG03830