

A.P.N. # 1220-21-510-053

R.P.T.T. \$ 1244.10

ESCROW NO. 040101884

RECORDING REQUESTED BY:  
**STEWART TITLE COMPANY**

MAIL TAX STATEMENTS TO:  
**SAME AS BELOW**

WHEN RECORDED MAIL TO:  
**GRANTEE**  
**1450 KERRY COURT**  
**GARDNERVILLE, NV 89460**

REQUESTED BY  
**Stewart Title of Douglas County**  
IN OFFICIAL RECORDS OF  
DOUGLAS CO., NEVADA

2004 JUL -9 PM 3:36

WERNER CHRISTEN  
RECORDER

\$ 15.00 PAID KG DEPUTY

(Space Above for Recorder's Use Only)

**GRANT, BARGAIN, SALE DEED**



THIS INDENTURE WITNESSETH: That **BRUCE BRUNDIGE AND CAROL BRUNDIGE, HUSBAND AND WIFE**

in consideration of \$10.00, the receipt of which is hereby acknowledged, does hereby Grant, Bargain Sell and Convey to **CRAIG . McMORRIS AND SHERRYE McMORRIS, HUSBAND AND WIFE** AS JOINT TENANTS WITH RIGHTS OF SURVIVORSHIP

and to the heirs and assigns of such Grantee forever, all that real property situated in the County of **Douglas** State of Nevada, bounded and described as:  
**SEE EXHIBIT "A" ATTACHED HERETO AND MADE A PART HEREOF**

Together with all and singular the tenements, hereditaments and appurtenances thereunto belonging or in anyway appertaining, and any reversions, remainders, rents, issues or profits thereof.

DATE: **July 01, 2004**

  
**BRUCE BRUNDIGE**  
  
**CAROL BRUNDIGE**

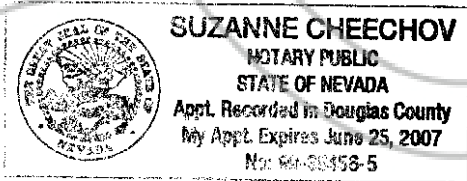

STATE OF NV }  
  } ss.  
COUNTY OF Douglas }

This instrument was acknowledged before me on 7/7/04  
by BRUCE BRUNDIGE and CAROL BRUNDIGE

Signature Suzanne Cheechov  
Notary Public (One inch margin on all sides of document for Recorder's Use Only)

0618402  
BK0704PG03853

**EXHIBIT "A"**

**LEGAL DESCRIPTION**

ESCROW NO.: 040101884

The land referred to herein is situated in the  
State of Nevada, County of Douglas  
City of GARDNERVILLE described as follows:

Lot 99, as shown on the official map of GARDNERVILLE  
RANCHOS UNIT NO. 6, filed for record on May 29, 1973, in  
the office of the County Recorder of Douglas County, Nevada  
as Document No. 66512.

Assessors Parcel No. 1220-21-510-053

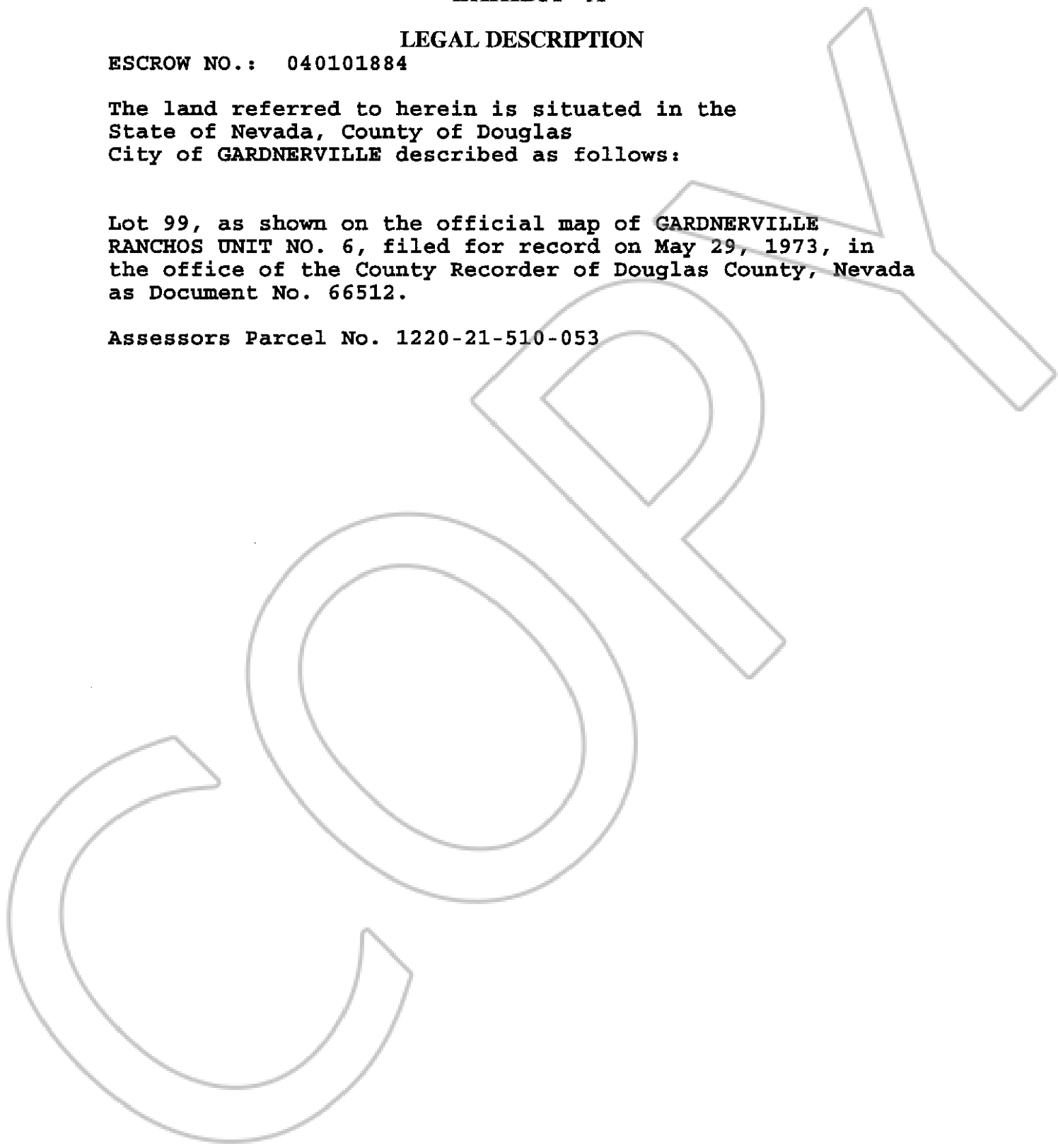

0618402

BK0704PG03854