

A.P.N. # 1320-32-115-001

ADTT 1501.50
ESCROW NO. 040101867

RECORDING REQUESTED BY:
STEWART TITLE COMPANY
MAIL TAX STATEMENTS TO:
SAME AS BELOW

WHEN RECORDED MAIL TO:
GRANTEE
1615 WILDROSE
MINDEN, NEVADA

REQUESTED BY
Stewart Title of Douglas County
IN OFFICIAL RECORDS OF
DOUGLAS CO., NEVADA

2004 JUL 13 PM 3:28

WERNER CHRISTEN
RECORDER

\$ 15.00 PAID rc DEPUTY

(Space above for Recorder's Use Only)

CORPORATION
GRANT, BARGAIN, SALE DEED

THIS INDENTURE WITNESSETH: That
KIM POSNIEN CONSTRUCTION AND DEVELOPMENT COMPANY, A NEVADA
CORPORATION

in consideration of \$10.00, the receipt of which is hereby acknowledged, does hereby Grant, Bargain Sell
and Convey to
JON S. ERB, A MARRIED MAN AS HIS SOLE AND SEPARATE PROPERTY

and to the heirs and assigns of such Grantee forever, all that real property situated in the
County of **Douglas** State of Nevada,

bounded and described as follows:

SEE EXHIBIT "A" ATTACHED HERETO AND MADE A PART HEREOF

Together with all and singular the tenements, hereditaments and appurtenances thereunto belonging or in
anywise appertaining, and any reversions, remainders, rents, issues or profits thereof.

DATE: **June 10, 2004**

KIM POSNIEN CONSTRUCTION AND
DEVELOPMENT COMPANY, A NEVADA



SUZANNE CHEECHOV
NOTARY PUBLIC
STATE OF NEVADA
App. Recorded in Douglas County
Commission Expires June 25, 2007
NOTARY PUBLIC

BY: [Signature]
KIMBALL A. POSNIEN
PRESIDENT

BY: _____

STATE OF W }
COUNTY OF Douglas } ss.

This instrument was acknowledged before me on 7/13/04
by, **KIMBALL A. POSNIEN**

Signature [Signature]

Notary Public (One Inch Margin on all sides of Document for Recorder's Use Only)

0618617

BK0704PG04805

EXHIBIT "A"

LEGAL DESCRIPTION

ESCROW NO.: 040101867

The land referred to herein is situated in the
State of Nevada, County of Douglas
City of MINDEN described as follows:

Lot 4, Block A, as shown on the Official Map of WILDROSE
NO. 3, Unit 1, recorded in the Office of the County
Recorder October 22, 1971, Book 1 of Maps, as Document No.
55071, Douglas County, Nevada.

Assessor's Parcel No. 1320-32-115-001

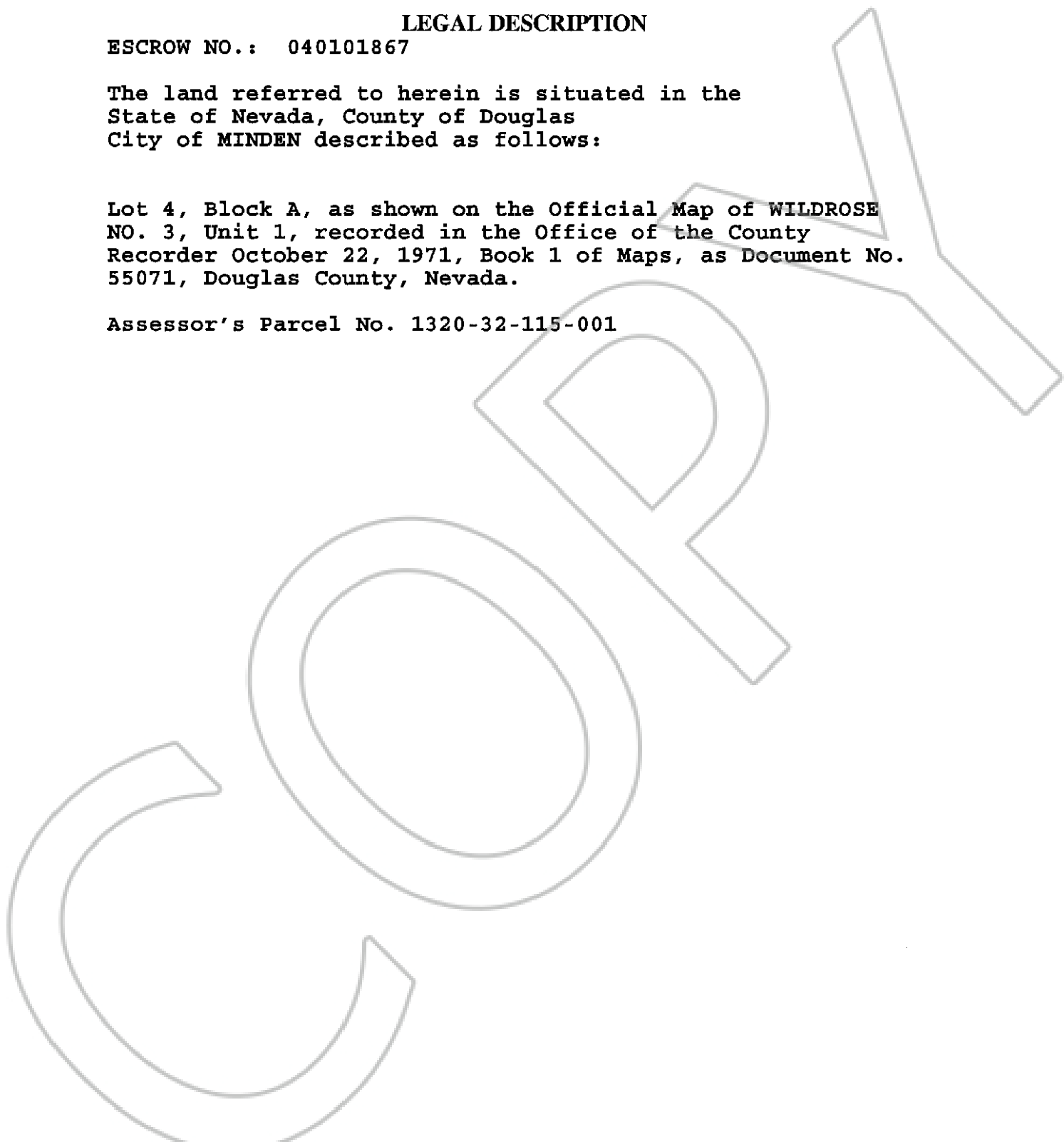

0618617

BK0704PG04806