

**EXHIBIT "A"
LEGAL DESCRIPTION**

Order No.: 040301918

The land referred to herein is situated in the State of Nevada,
County of Douglas, described as follows:

Lot 5, in Block D, as shown on the official map of VALLEY
VISTA ESTATES II, UNIT 1, a Planned Unit Development
recorded in the office of the Douglas County Recorder,
State of Nevada, on December 17, 1993, in Book 1293, at
Page 3652, as Document No. 325265, Official Records.

Assessors Parcel No. 1420-18-212-005

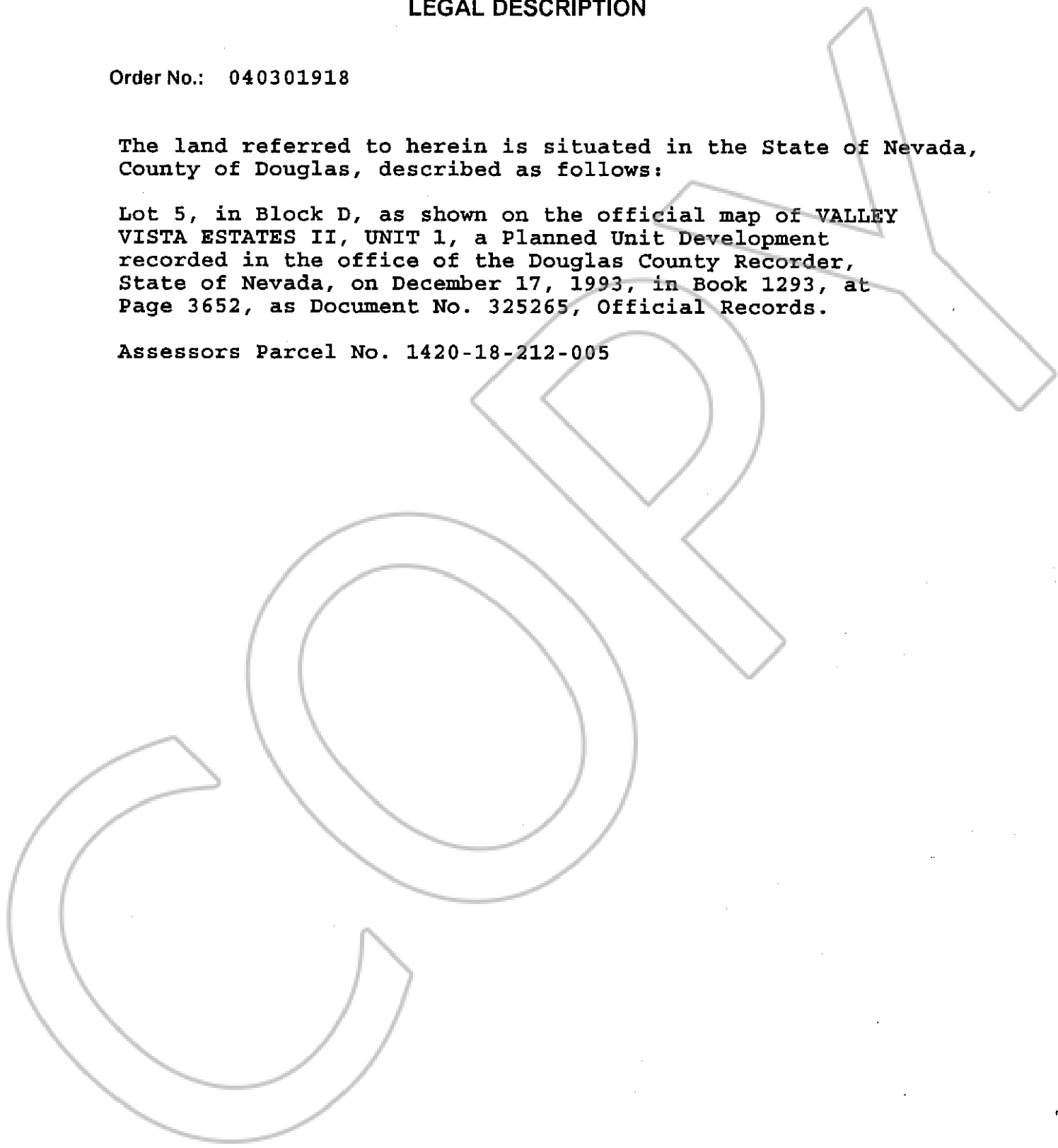

0618762

BK0704PG05462