

15-  
A.P.N. # 1318-03-212-059

R.P.T.T. \$ 217.05

ESCROW NO. \_\_\_\_\_

RECORDING REQUESTED BY:  
**STEWART TITLE COMPANY**

MAIL TAX STATEMENTS TO:  
**MARY MCENEANY**  
9900 Wilber May Pwy #1201  
Reno, NV 89521

✓ WHEN RECORDED MAIL TO:  
**MARY MCENEANY**  
9900 Wilber May Pwy #1201  
~~MORAGA CA 94570~~  
Reno NV 89521

REQUESTED BY  
Mary McENEANY  
IN OFFICIAL RECORDS OF  
DOUGLAS CO., NEVADA

2004 JUL 26 AM 10:30

WERNER CHRISTEN  
RECORDER

\$ 15.00 PAID KJ DEPUTY

(Space Above for Recorder's Use Only)

**GRANT, BARGAIN, SALE DEED**

THIS INDENTURE WITNESSETH: That MARY McENEANY, A SINGLE PERSON

in consideration of \$10.00, the receipt of which is hereby acknowledged, does hereby Grant, Bargain Sell and Convey to **MARY McENEANY, A SINGLE PERSON AND GREGORY KALINOWSKI AND PATRICIA KALINOWSKI, HUSBAND AND WIFE ALL AS JOINT TENANTS**

and to the heirs and assigns of such Grantee forever, all that real property situated in the **unincorporated area** County of **DOUGLAS** State of Nevada, bounded and described as:  
**SEE EXHIBIT "A" ATTACHED HERETO AND MADE A PART HEREOF**

Together with all and singular the tenements, hereditaments and appurtenances thereunto belonging or in anyway appertaining, and any reversions, remainders, rents, issues or profits thereof.

DATE: **July 23, 2004**

Mary McENEANY  
**MARY McENEANY**



STATE OF Nevada }  
COUNTY OF Douglas } ss.

This instrument was acknowledged before me on 7-23-04  
by MARY McENEANY

Signature Mary H. Kelsh  
Notary Public (One inch margin on all sides of document for Recorder's Use Only)

0619709

BK0704PG10663

**EXHIBIT "A"**

**LEGAL DESCRIPTION**

ESCROW NO.: 030202466

The land referred to herein is situated in the  
State of Nevada, County of DOUGLAS  
City of ZEPHYR COVE described as follows:

Lot 170, as shown on the map of SKYLAND SUBDIVISION NO. 3,  
filed in the office of the County Recorder of Douglas  
County, Nevada, on February 24, 1960, as Document No. 15653.

Assessor's Parcel No. 1318-03-212-059

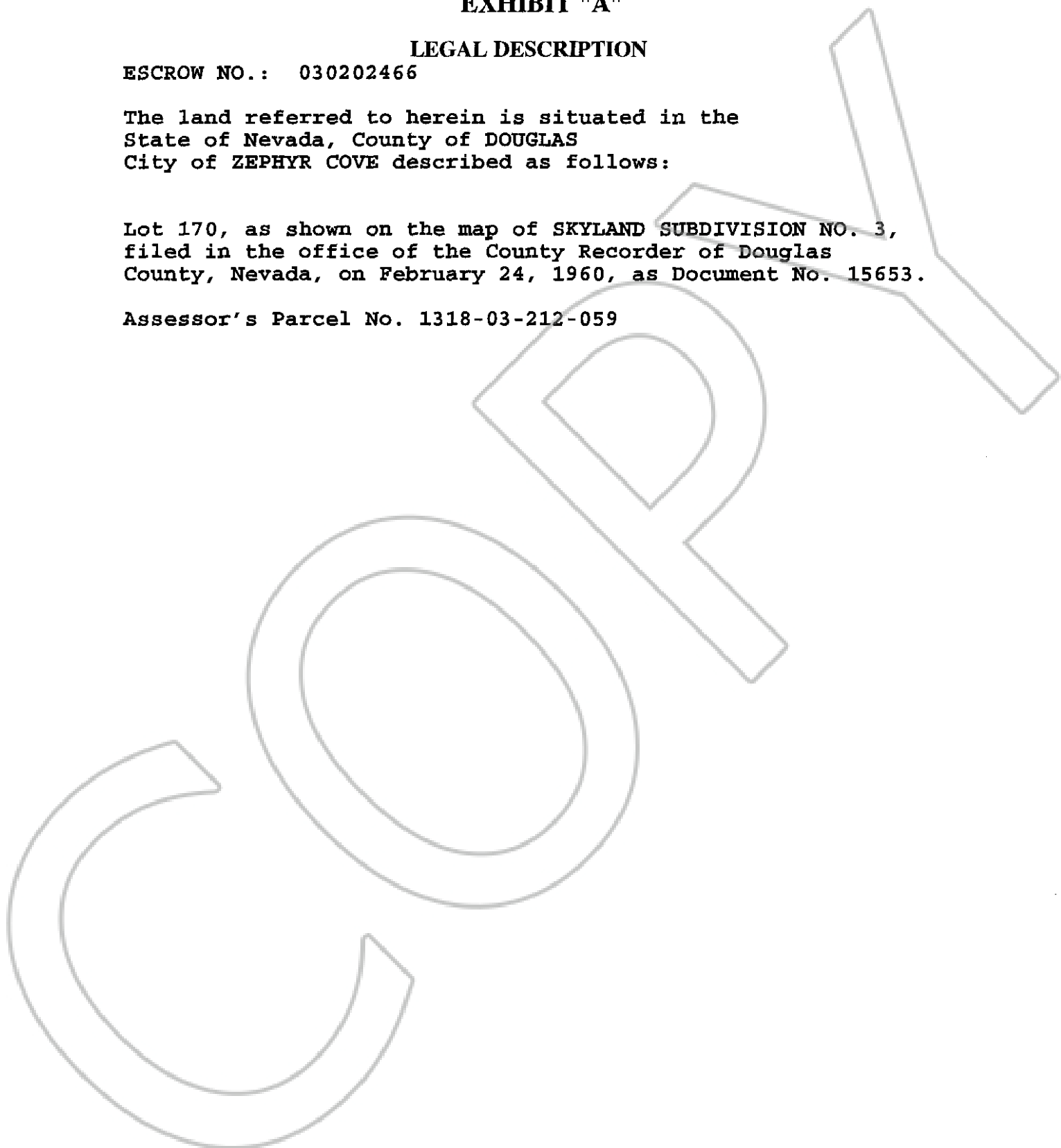

0619709

BK0704PG10664