

EXHIBIT "A"

LEGAL DESCRIPTION

ESCROW NO.: 040102125

**The land referred to herein is situated in the
State of Nevada, County of DOUGLAS
City of GENOA described as follows:**

**Lot 26, Block A as set forth on the final map of GENOA LAKES
PHASE 4, A Planned Unit Development, recorded May 8, 2000, in
Book 500 of Official Records at Page 1613, Douglas County,
Nevada, as Document No. 491480.**

Assessors Parcel No. 1319-03-413-013

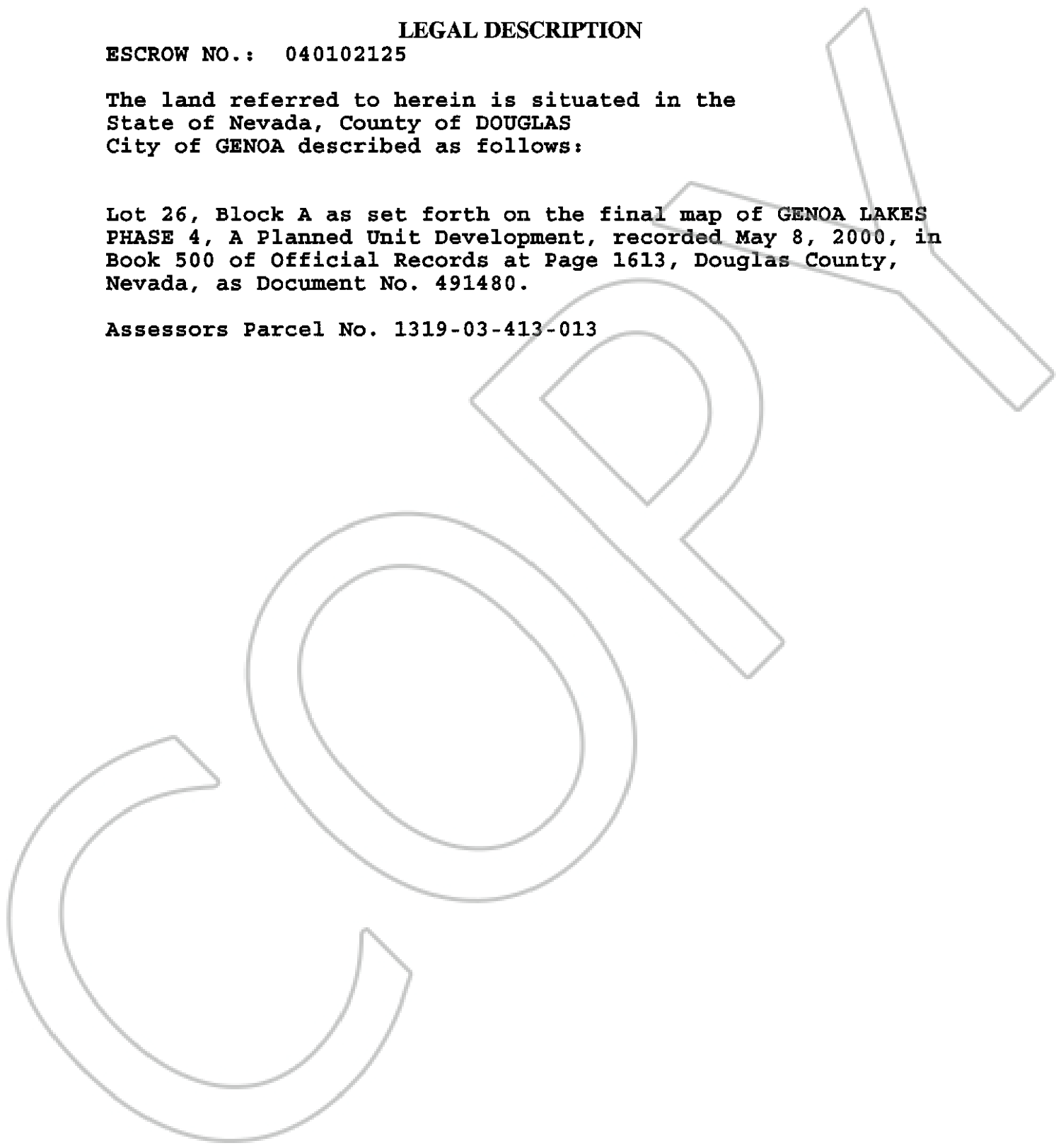

0619873

BK0704PG11573