



**EXHIBIT "A"**

**LEGAL DESCRIPTION**

ESCROW NO.: char

The land referred to herein is situated in the State of Nevada, County of DOUGLAS described as follows:

Lot 27, as set forth on the Final Map of TILLMAN ESTATES, filed for record in the Office of the County Recorder of Douglas County, State of Nevada, on april 12, 1994, in Book 494, at Page 2192, as Document No. 334956.

A.P.N. 1220-21-110-050

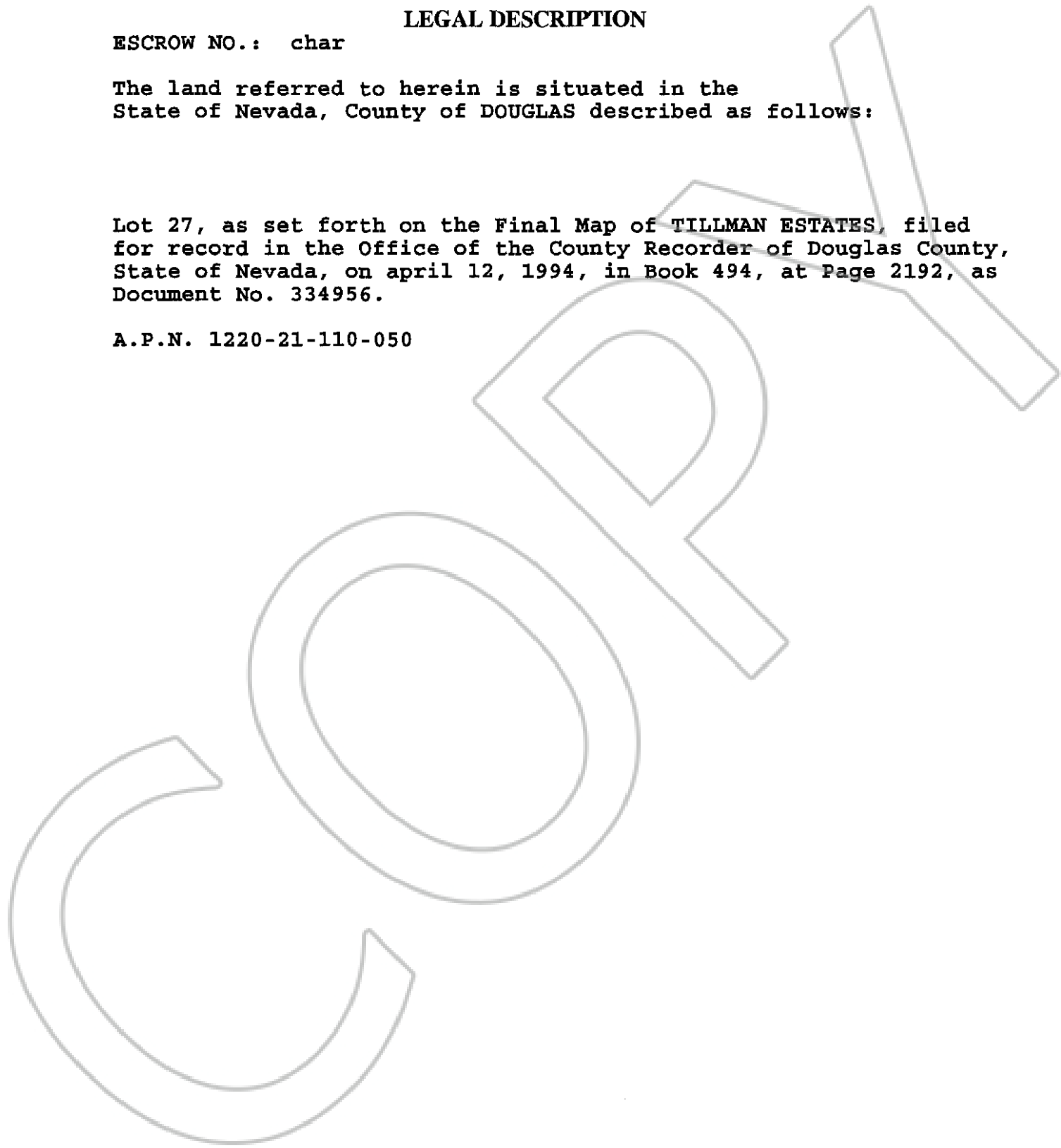

0620514

BK0804PG00910