

A.P.N. # 1220-21-110-051

R.P.T.T. \$ 0#4
ESCROW NO. char

RECORDING REQUESTED BY:
STEWART TITLE COMPANY
MAIL TAX STATEMENTS TO:
SAME AS BELOW

WHEN RECORDED MAIL TO:
GRANTEE
P.O. BOX 7262
SOUTH LAKE TAHOE, CA 96158

REQUESTED BY
Ronald Koepf
IN OFFICIAL RECORDS OF
DOUGLAS CO., NEVADA

2004 AUG -3 PM 1:48

WERNER CHRISTEN
RECORDER

\$1500 PAID RE DEPUTY

(Space Above for Recorder's Use Only)

GRANT, BARGAIN, SALE DEED

THIS INDENTURE WITNESSETH: That **RONALD H. KOEPP and MARCIA M. KOEPP, Husband and Wife**

in consideration of \$10.00, the receipt of which is hereby acknowledged, does hereby Grant, Bargain Sell and Convey to **RONALD H. KOEPP AND MARCIA M. KOEPP, TRUSTEES, OR THEIR SUCCESSORS IN TRUST, UNDER THE KOEPP LIVING TRUST DATED MAY 10, 2004, AND ANY AMENDMENTS THERETO**

and to the heirs and assigns of such Grantee forever, all that real property situated in the **unincorporated area** County of **DOUGLAS** State of Nevada, bounded and described as:
SEE EXHIBIT "A" ATTACHED HERETO AND MADE A PART HEREOF

Together with all and singular the tenements, hereditaments and appurtenances thereunto belonging or in anywise appertaining, and any reversions, remainders, rents, issues or profits thereof.

DATE: **July 29, 0404**

Ronald H Koepf
RONALD H KOEPP

Marcia M Koepf
MARCIA M. KOEPP

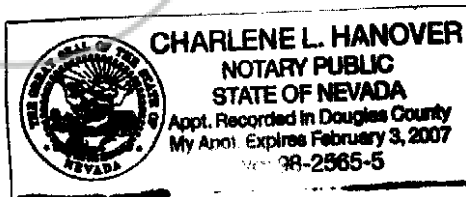

STATE OF NEVADA }
 } ss.
COUNTY OF DOUGLAS }

This instrument was acknowledged before me on 8/3/2004
by RONALD H KOEPPOLL and MARCIA M. KOEPP

Signature Charlene L Hanover
Notary Public (One inch margin on all sides of document for Recorder's Use Only)

0620516
BK0804PG00913

EXHIBIT "A"

LEGAL DESCRIPTION

ESCROW NO.: char

The land referred to herein is situated in the State of Nevada, County of DOUGLAS described as follows:

Lot 26, as shown on the Final Map of TILLMAN ESTATES, filed in the office of the County Recorder of Douglas County, Nevada, on April 12, 1994 in Book 494, Page 2192, as Document No. 334956.

A.P.N. 1220-21-110-051

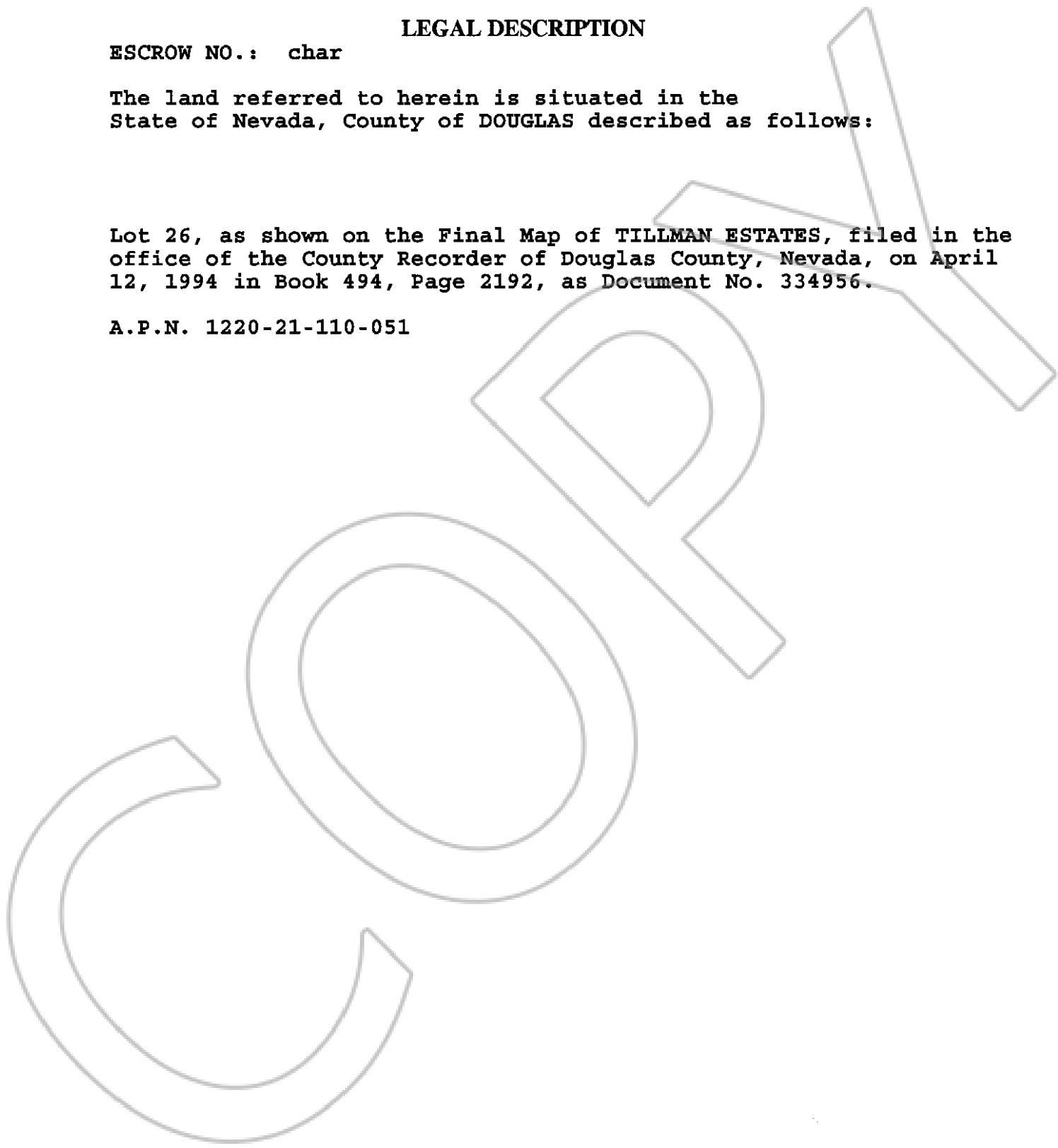

0620516

BK0804PG00914