

A.P.N. # 1220-16-210-197

R.P.T.T. \$ 0.00 Ex # 5
ESCROW NO. 040701509

RECORDING REQUESTED BY:
STEWART TITLE COMPANY
MAIL TAX STATEMENTS TO:
SAME AS BELOW

WHEN RECORDED MAIL TO:
GRANTEE

**18515 ANNIE LANE
SAN JOSE, CA 95120**

REQUESTED BY
STEWART TITLE of DOUGLAS COUNTY
IN OFFICIAL RECORDS OF
DOUGLAS CO. NEVADA

2004 AUG -6 AM 11:59

WERNER CHRISTEN
RECORDER

\$ 15⁰⁰ PAID Bh DEPUTY

(Space Above for Recorder's Use Only)

GRANT, BARGAIN, SALE DEED

THIS INDENTURE WITNESSETH: That **PEGGY SCHOETTNER, SPOUSE OF THE GRANTEE**

in consideration of \$10.00, the receipt of which is hereby acknowledged, does hereby Grant, Bargain Sell and Convey to **GARY SCHOETTNER, A MARRIED MAN AS HIS SOLE AND SEPARATE PROPERTY**

and to the heirs and assigns of such Grantee forever, all that real property situated in the **unincorporated area** County of **DOUGLAS** State of Nevada, bounded and described as :

SEE EXHIBIT "A" ATTACHED HERETO AND MADE A PART HEREOF

IT IS THE EXPRESS INTENT OF THE GRANTOR, BEING THE SPOUSE OF THE GRANTEE, TO CONVEY ALL RIGHT, TITLE AND INTEREST OF THE GRANTOR, COMMUNITY OR OTHERWISE, IN AND TO THE HEREIN DESCRIBED PROPERTY TO THE GRANTEE AS GRANTEE'S SOLE AND SEPARATE PROPERTY.

Together with all and singular the tenements, hereditaments and appurtenances thereunto belonging or in anywise appertaining, and any reversions, remainders, rents, issues or profits thereof.

DATE: **July 20, 2004**

Peggy Schoettner
PEGGY SCHOETTNER

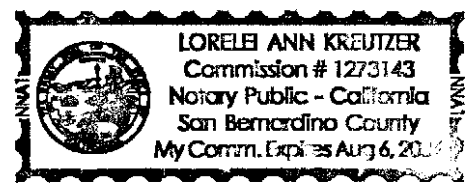

STATE OF California
COUNTY OF San Bernardino } ss.

This instrument was acknowledged before me on July 24, 2004
by, PEGGY SCHOETTNER

Signature Lorelei Ann Kreutzer
Notary Public (One Inch Margin on all sides of Document for Recorder's Use Only)

0620839

BK0804PG02544

EXHIBIT "A"

LEGAL DESCRIPTION

ESCROW NO.: 040701509

The land referred to herein is situated in the
State of Nevada, County of Douglas
City of GARDNERVILLE described as follows:

Lot 11, Block G, as said Lot and Block are shown on the
Amended map of RANCHOS ESTATES, filed in the office of the
County Recorder of Douglas County, State of Nevada, on
October 30, 1972, as Document No. 62493.

Assessor's Parcel No. 1220-16-210-197

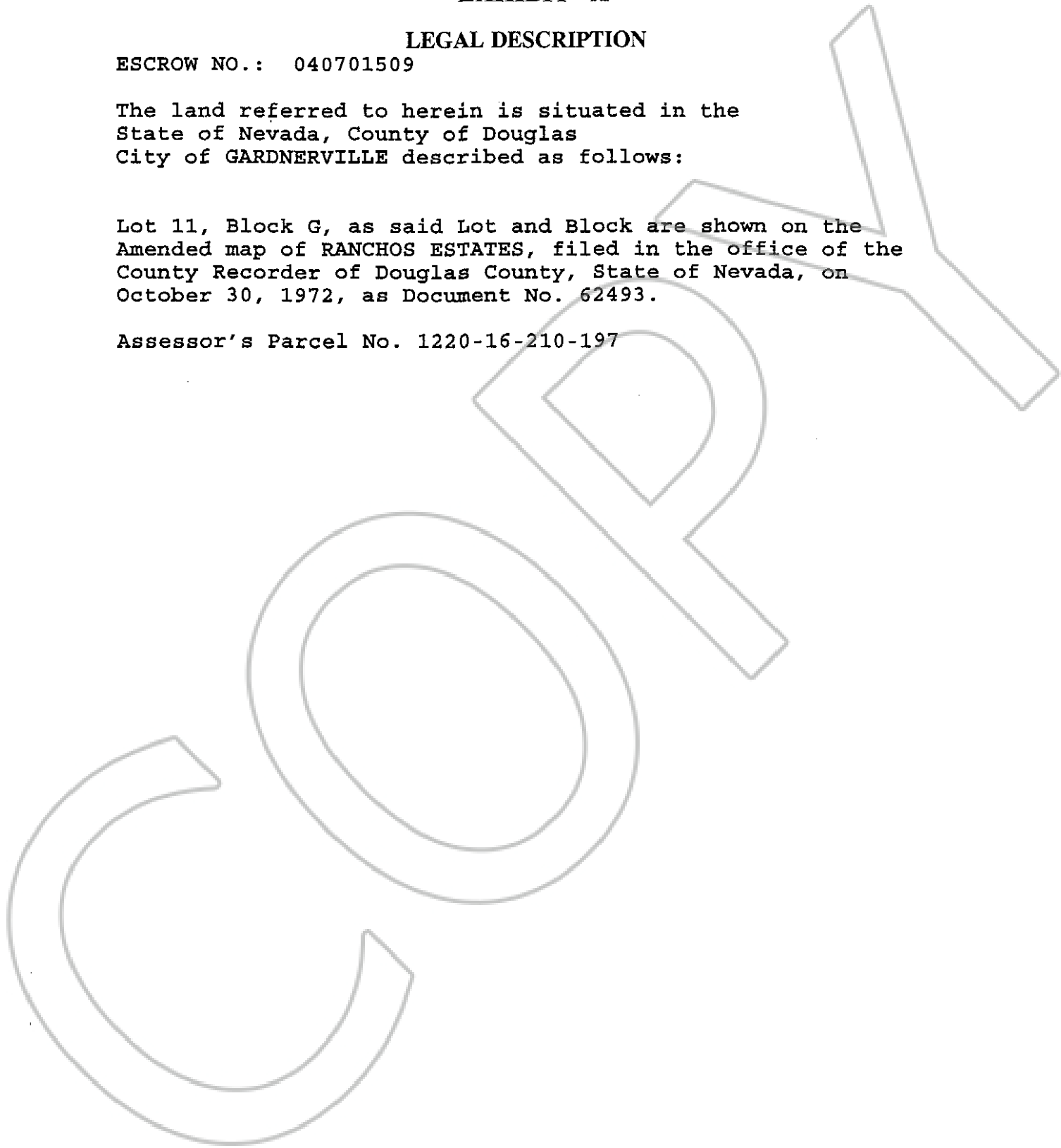

0620839

BK0804PG02545