

A.P.N. # 1420-07-610-040

R.P.T.T. \$ 1002.30

ESCROW NO. 040802001

RECORDING REQUESTED BY:  
**STEWART TITLE COMPANY**

MAIL TAX STATEMENTS TO:  
**SAME AS BELOW**

WHEN RECORDED MAIL TO:  
**GRANTEE**  
**874 MAHOGANY DRIVE**  
**MINDEN, NV 89423**

REQUESTED BY  
**Stewart Title of Douglas County**

IN OFFICIAL RECORDS OF  
DOUGLAS CO., NEVADA

2004 AUG -9 AM 11: 21

WERNER CHRISTEN  
RECORDER

\$15<sup>00</sup> PAID *kg* DEPUTY

(Space Above for Recorder's Use Only)

**GRANT, BARGAIN, SALE DEED**

THIS INDENTURE WITNESSETH: That **PAUL B. GIBBS AND L. EARLENE GIBBS, HUSBAND AND WIFE** as joint tenants

in consideration of \$10.00, the receipt of which is hereby acknowledged, does hereby Grant, Bargain Sell and Convey to **ROBERT L. FRISCHE AND SANDRA A. FRISCHE, HUSBAND AND WIFE** as joint tenants

and to the heirs and assigns of such Grantee forever, all that real property situated in the County of **Douglas** State of Nevada, bounded and described as:  
**SEE EXHIBIT "A" ATTACHED HERETO AND MADE A PART HEREOF**

Together with all and singular the tenements, hereditaments and appurtenances thereunto belonging or in anywise appertaining, and any reversions, remainders, rents, issues or profits thereof.

DATE: **July 12, 2004**

*Paul B Gibbs*  
\_\_\_\_\_  
**PAUL B. GIBBS**  
*Earlene Gibbs*  
\_\_\_\_\_  
**L. EARLENE GIBBS**

STATE OF Idaho }  
COUNTY OF Blaine } ss.

This instrument was acknowledged before me on 7-26-04  
by PAUL B. GIBBS and L. EARLENE GIBBS

Signature *Pam Williams*  
\_\_\_\_\_  
Notary Public (One inch margin on all sides of document for Recorder's Use Only)

*Commission expires May 9 2006*

**PAM WILLIAMS**  
**NOTARY PUBLIC**  
**STATE OF IDAHO**

0620941

BK0804PG03080

**EXHIBIT "A"**

**LEGAL DESCRIPTION**

**ESCROW NO.: 040802001**

**The land referred to herein is situated in the  
State of Nevada, County of Douglas  
City of CARSON CITY described as follows:**

**Lot 23, in Block B, of the Final Map of SUNRIDGE HEIGHTS  
PHASE 1, A PLANNED UNIT DEVELOPMENT, filed for record in  
the office of the County Recorder of Douglas County, State  
of Nevada, on June 11, 1993 as Document No. 309550.**

**Assessors Parcel No. 1420-07-610-040**

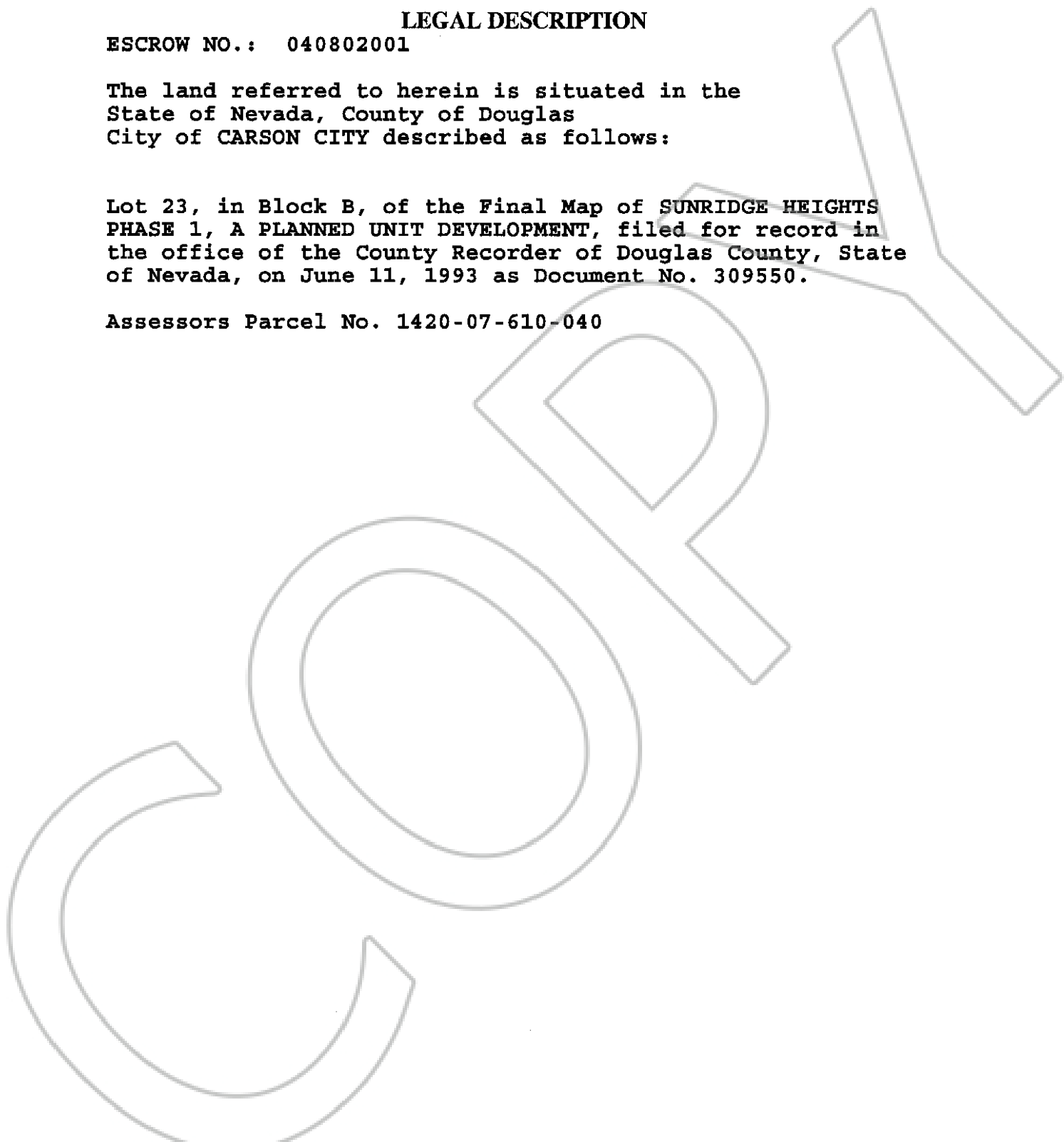

**0620941**

**BK0804PG03081**