

15

A.P.N. # 1420-29-810-021

R.P.T.T. \$ 0.00 #6

ESCROW NO. 040702160

RECORDING REQUESTED BY:
STEWART TITLE COMPANY

MAIL TAX STATEMENTS TO:
SAME AS BELOW

WHEN RECORDED MAIL TO:
GRANTEE

✓ **TJ DOWLING, TRUSTEE**
PO BOX 2218
MINDEN NV 89423

REQUESTED BY
Thomas Dowling
IN OFFICIAL RECORDS OF
DOUGLAS CO., NEVADA

2004 AUG 10 AM 9:33

WERNER CHRISTEN
RECORDER

\$ 15⁰⁰ PAID KJ DEPUTY

(Space Above for Recorder's Use Only)

GRANT, BARGAIN, SALE DEED

THIS INDENTURE WITNESSETH: That **THOMAS J. DOWLING, A SINGLE MAN**

in consideration of \$10.00, the receipt of which is hereby acknowledged, does hereby Grant, Bargain Sell and Convey to **TRUST OF THOMAS J. DOWLING, THOMAS J. DOWLING, TRUSTEE**

and to the heirs and assigns of such Grantee forever, all that real property situated in the **unincorporated area** County of **DOUGLAS** State of Nevada, bounded and described as:

SEE EXHIBIT "A" ATTACHED HERETO AND MADE A PART HEREOF

Together with all and singular the tenements, hereditaments and appurtenances thereunto belonging or in anywise appertaining, and any reversions, remainders, rents, issues or profits thereof.

DATE: **July 28, 2004**

Thomas J. Dowling

THOMAS J. DOWLING



STATE OF NEVADA }

COUNTY OF DOUGLAS } SS.

This instrument was acknowledged before me on 7-29-04
by THOMAS J. DOWLING

Signature *L. Hendrick*
Notary Public (One inch margin on all sides of document for Recorder's Use Only)

0621057

BK0804 PG03666

EXHIBIT "A"

LEGAL DESCRIPTION

ESCROW NO.: 040702160

The land referred to herein is situated in the
State of Nevada, County of DOUGLAS
City of MINDEN described as follows:

Lot 14, Block B, of SARATOGA SPRINGS ESTATES, UNIT 1, as
shown on the Official Map recorded in the Office of the
County Recorder on June 16, 1990, in Book 690, Page 525, as
Document No. 227472.

Assessor's Parcel No. 1420-29-810-021

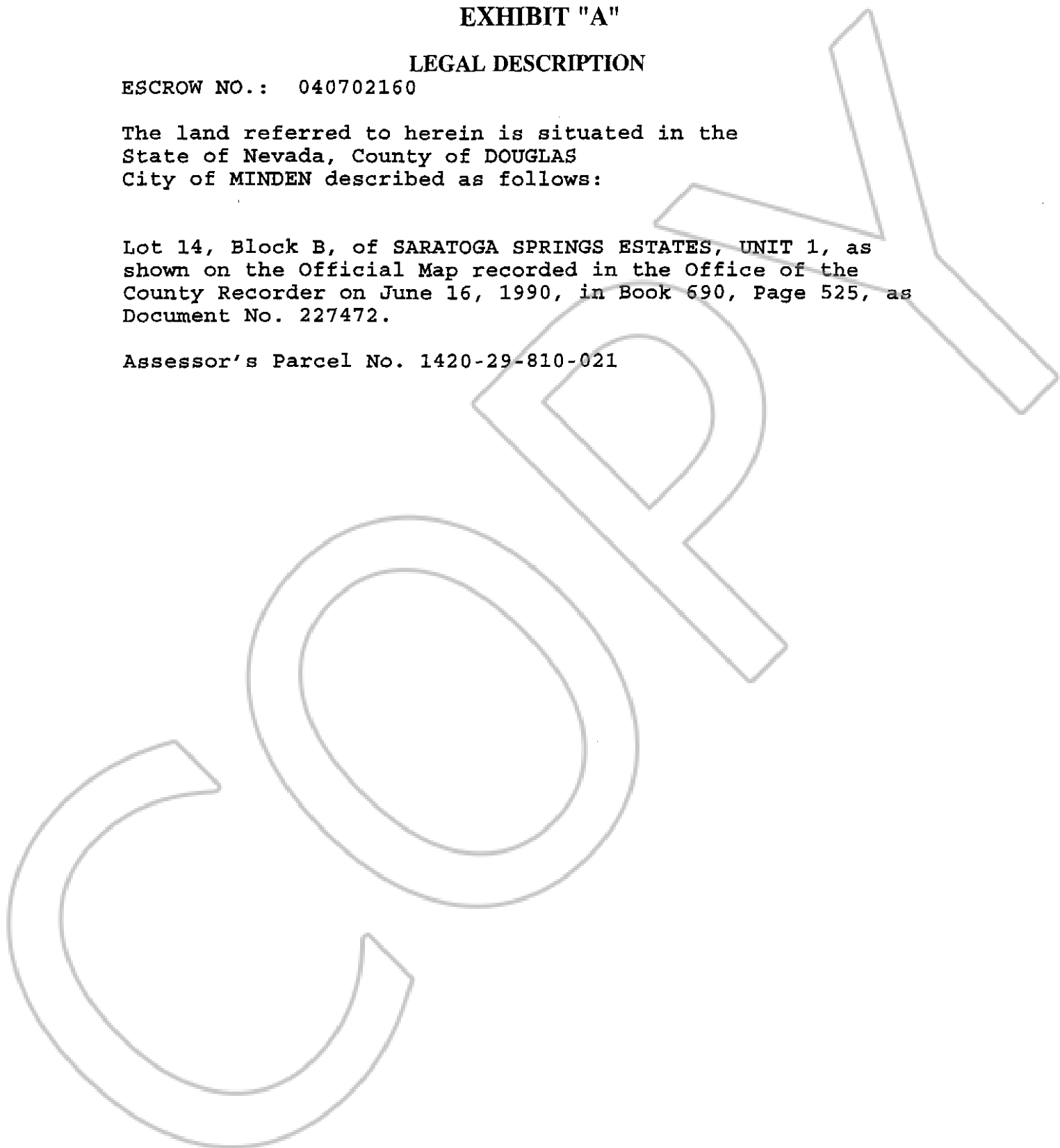

0621057
BK0804PG03667