



**EXHIBIT "A"**

**LEGAL DESCRIPTION**

ESCROW NO.: 040702267

The land referred to herein is situated in the  
State of Nevada, County of DOUGLAS  
City of GARDNERVILLE described as follows:

Lot 4, Block I, as said Lot and Block are shown on the  
Amended map of RANCHOS ESTATES, filed in the office of the  
County Recorder of Douglas County, State of Nevada, on  
October 30, 1972, as Document No. 62493.

Assessor's Parcel No. 1220-16-210-136.

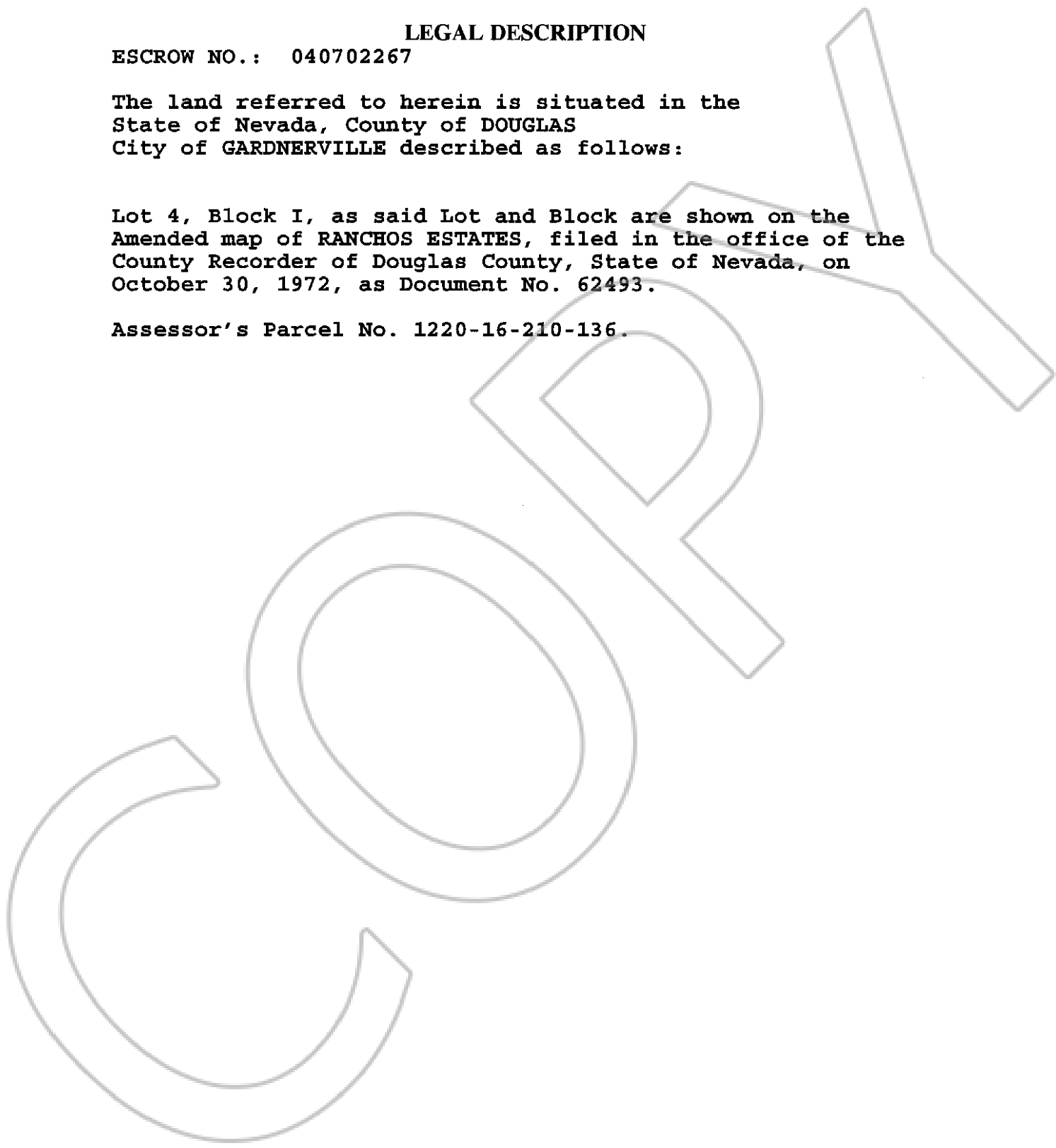

0621214  
BK0804PG04493