

A.P.N. # 1320-33-817-023

R.P.T.T. \$ 1,201.20

ESCROW NO. 040301314

RECORDING REQUESTED BY:
STEWART TITLE COMPANY
MAIL TAX STATEMENTS TO:
SAME AS BELOW

WHEN RECORDED MAIL TO:
ALAYNE MEEKS
2621 N. RODEO GULCH ROAD
SOQUEL, CA 95073

REQUESTED BY
Stewart Title of Douglas County

IN OFFICIAL RECORDS OF
DOUGLAS CO., NEVADA

2004 AUG 13 PM 3:23

WERNER CHRISTEN
RECORDER

s/5⁰⁰ PAID kg DEPUTY

(Space above for Recorder's Use Only)

**CORPORATION
GRANT, BARGAIN, SALE DEED**

THIS INDENTURE WITNESSETH: That
WEST RIDGE HOMES, INC., a Nevada corporation

in consideration of \$10.00, the receipt of which is hereby acknowledged, does hereby Grant, Bargain Sell
and Convey to
ALAYNE MEEKS, A SINGLE WOMAN

and to the heirs and assigns of such Grantee forever, all that real property situated in the
County of **DOUGLAS** State of Nevada,

bounded and described as follows:

SEE EXHIBIT "A" ATTACHED HERETO AND MADE A PART HEREOF

Together with all and singular the tenements, hereditaments and appurtenances thereunto belonging or in
anywise appertaining, and any reversions, remainders, rents, issues or profits thereof.

DATE: **August 03, 2004**

**WEST RIDGE HOMES, INC.
A NEVADA CORPORATION**

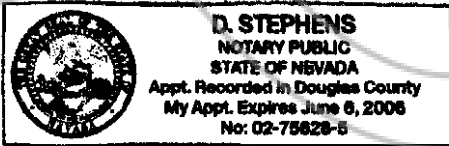

BY: *[Signature]*
**PETER M. BEEKHOF, JR.
PRESIDENT**

BY: _____

STATE OF Nevada }
} ss.
COUNTY OF DOUGLAS }

This instrument was acknowledged before me on 8-11-04
by PETER M. BEEKHOF, JR.

Signature *[Signature]*
Notary Public (One Inch Margin on all sides of Document for Recorder's Use Only)

0621419
BK0804PG05765

EXHIBIT "A"

LEGAL DESCRIPTION

ESCROW NO.: 040301314

The land referred to herein is situated in the State of Nevada, County of DOUGLAS described as follows:

Lot 23, in Block D, as set forth on FINAL SUBDIVISION MAP No. 1006-12 for CHICHESTER ESTATES, PHASE 12, filed in the office of the County Recorder of Douglas County, Nevada and recorded January 8, 2004 in Book 0104, Page 2012, as Document No. 601490.

ASSESSOR'S PARCEL NO. 1320-33-817-023

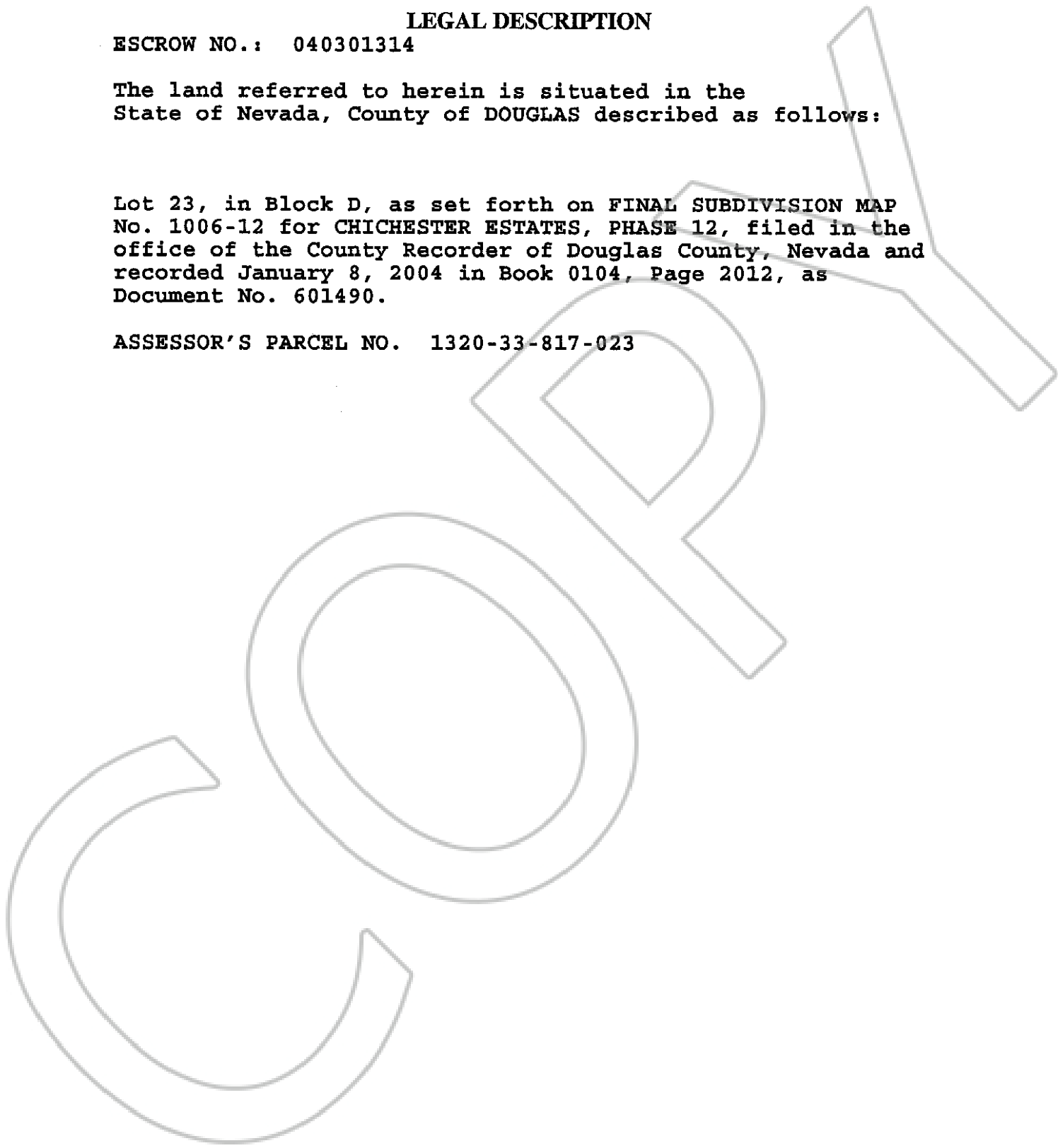

0621419

BK0804PG05766