

A.P.N. # 1022-15-001-148

GOODWIN T.T. \$ 253.50
ESCROW NO. 040702197
~~THE GM GOODWIN REQUESTER~~
STEWART TITLE COMPANY
MAIL TAX STATEMENTS TO:
SAME AS BELOW

REQUESTED BY
Stewart Title of Douglas County
IN OFFICIAL RECORDS OF
DOUGLAS CO., NEVADA

2004 AUG 16 PM 3:01

WERNER CHRISTEN
RECORDER

\$15⁰⁰ PAID KJ DEPUTY

WHEN RECORDED MAIL TO:
GRANTEE
81-276 SIROCCO AVENUE
INDIO, CA 92201

(Space Above for Recorder's Use Only)

GRANT, BARGAIN, SALE DEED

THIS INDENTURE WITNESSETH: That ALICE MAY GOODWIN, TRUSTEE OF THE
THE GM GOODWIN FAMILY TRUST DATED JULY 10, 2003, AND RONALD
B. GOODWIN,

in consideration of \$10.00, the receipt of which is hereby acknowledged, does hereby Grant, Bargain Sell
and Convey to LENORA PHILIBERT, AN UNMARRIED WOMAN AS HER SOLE AND
SEPARATE PROPERTY

and to the heirs and assigns of such Grantee forever, all that real property situated in the
County of Douglas State of Nevada, bounded and described as:
SEE EXHIBIT "A" ATTACHED HERETO AND MADE A PART HEREOF

Together with all and singular the tenements, hereditaments and appurtenances thereunto belonging or in
anywise appertaining, and any reversions, remainders, rents, issues or profits thereof.

DATE: August 13, 2004

BY: Alice M. Goodwin / Trustee
ALICE M. GOODWIN
TRUSTEE

BY: Ronald B. Goodwin
RONALD B. GOODWIN, INDIVIDUALLY

STATE OF Arizona }
 } ss.
COUNTY OF Yavapai }

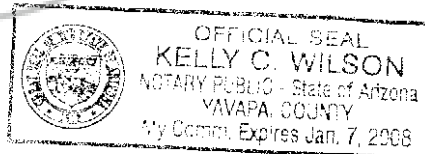

This instrument was acknowledged before me on _____
by, ALICE M. GOODWIN and Ronald B. Goodwin

Signature Kelly C. Wilson

Notary Public (One Inch Margin on all sides of Document for Recorders Use Only)

0621552

BK0804PG06454

EXHIBIT "A"

LEGAL DESCRIPTION

ESCROW NO.: 040702197

The land referred to herein is situated in the State of Nevada, County of Douglas City of WELLINGTON described as follows:

Lot 3, in Block I, as shown on the map entitled TOPAZ RANCH ESTATES, UNIT NO. 4, filed for record November 16, 1970, in the Office of the County Recorder of Douglas County, Nevada, as Document No. 50212.

Assessor's Parcel No. 1022-15-001-148

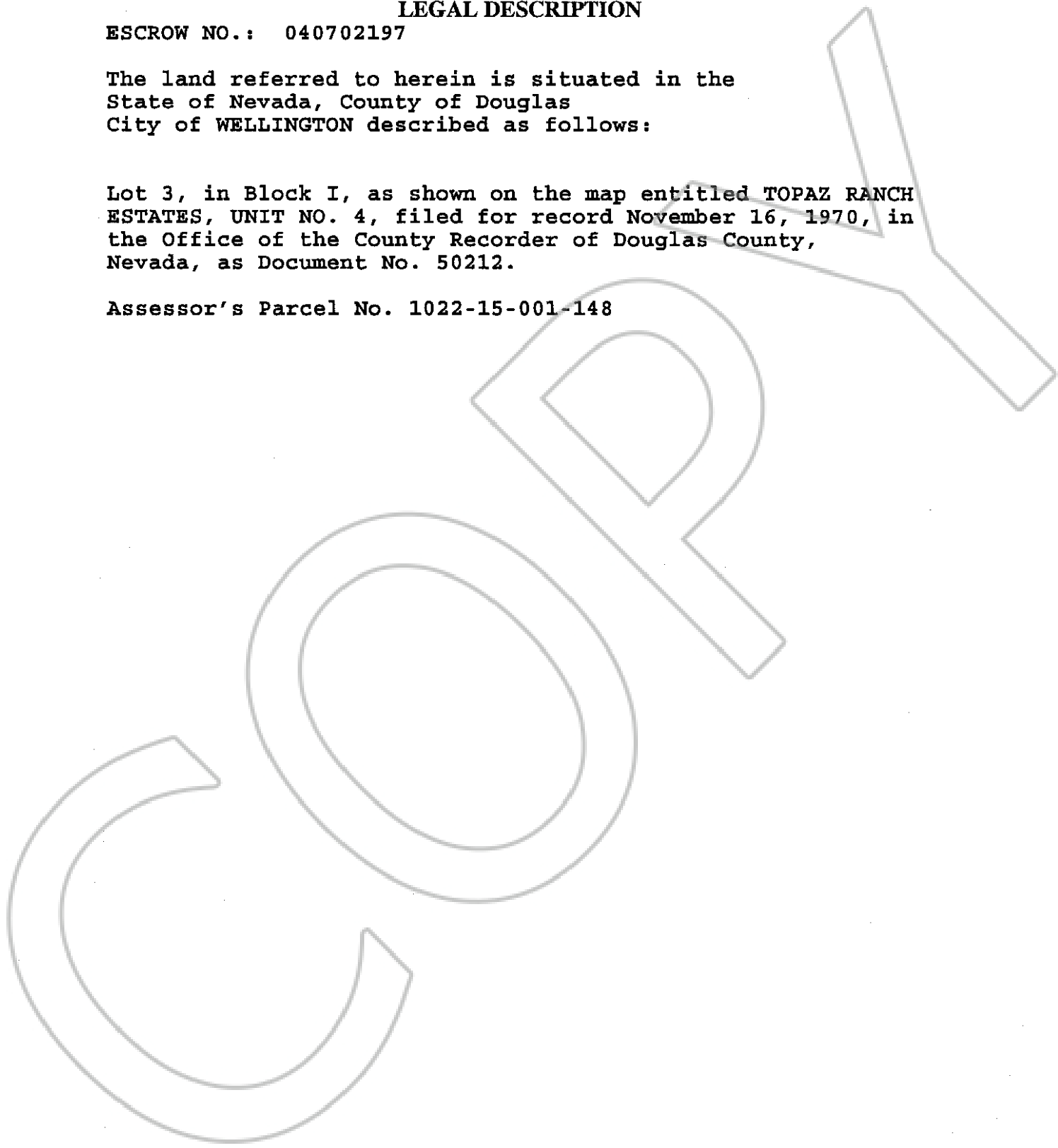

0621552
BK0804PG06455