

A.P.N. # 1220-21-710-165

R.P.T.T. \$ 988.65

ESCROW NO. 040802040

RECORDING REQUESTED BY:  
**STEWART TITLE COMPANY**

MAIL TAX STATEMENTS TO:  
**SAME AS BELOW**

WHEN RECORDED MAIL TO:  
**GRANTEE**  
**1319 LEONARD ROAD**  
**GARDNERVILLE, NV 89460**

REQUESTED BY  
**Stewart Title of Douglas County**  
IN OFFICIAL RECORDS OF  
DOUGLAS CO., NEVADA

2004 AUG 20 PM 3:00

WERNER CHRISTEN  
RECORDER

\$150 PAID CF DEPUTY

(Space Above for Recorder's Use Only)

**GRANT, BARGAIN, SALE DEED**

THIS INDENTURE WITNESSETH: That **EMANUEL P. PALILLA AND BARBARA N. PALILLA, HUSBAND AND WIFE AS COMMUNITY PROPERTY**

in consideration of \$10.00, the receipt of which is hereby acknowledged, does hereby Grant, Bargain Sell and Convey to **MIKE LIDDELL A SINGLE MAN**

and to the heirs and assigns of such Grantee forever, all that real property situated in the **unincorporated area** County of **DOUGLAS** State of Nevada, bounded and described as:  
**SEE EXHIBIT "A" ATTACHED HERETO AND MADE A PART HEREOF**

Together with all and singular the tenements, hereditaments and appurtenances thereunto belonging or in anywise appertaining, and any reversions, remainders, rents, issues or profits thereof.

DATE: **August 15, 2004**

*Emanuel Palilla*  
\_\_\_\_\_  
EMANUEL P. PALILLA

*Barbara N. Palilla*  
\_\_\_\_\_  
BARBARA N. PALILLA

STATE OF Calif }  
COUNTY OF Los Angeles } ss.



This instrument was acknowledged before me on 8/17/2004  
by EMANUEL P. PALILLA and BARBARA N. PALILLA

Signature [Signature]  
Notary Public (One inch margin on all sides of document for Recorder's Use Only)

0622092

BK0804PG08876

**EXHIBIT "A"**

**LEGAL DESCRIPTION**

ESCROW NO.: 040802040

The land referred to herein is situated in the  
State of Nevada, County of DOUGLAS  
City of GARDNERVILLE described as follows:

Lot 446, as shown on the map of GARDNERVILLE RANCHOS UNIT  
NO. 7, filed for record in the office of the County  
Recorder of Douglas County, Nevada, on March 27, 1974, as  
Document No. 72456.

Assessors Parcel No. 1220-21-710-165

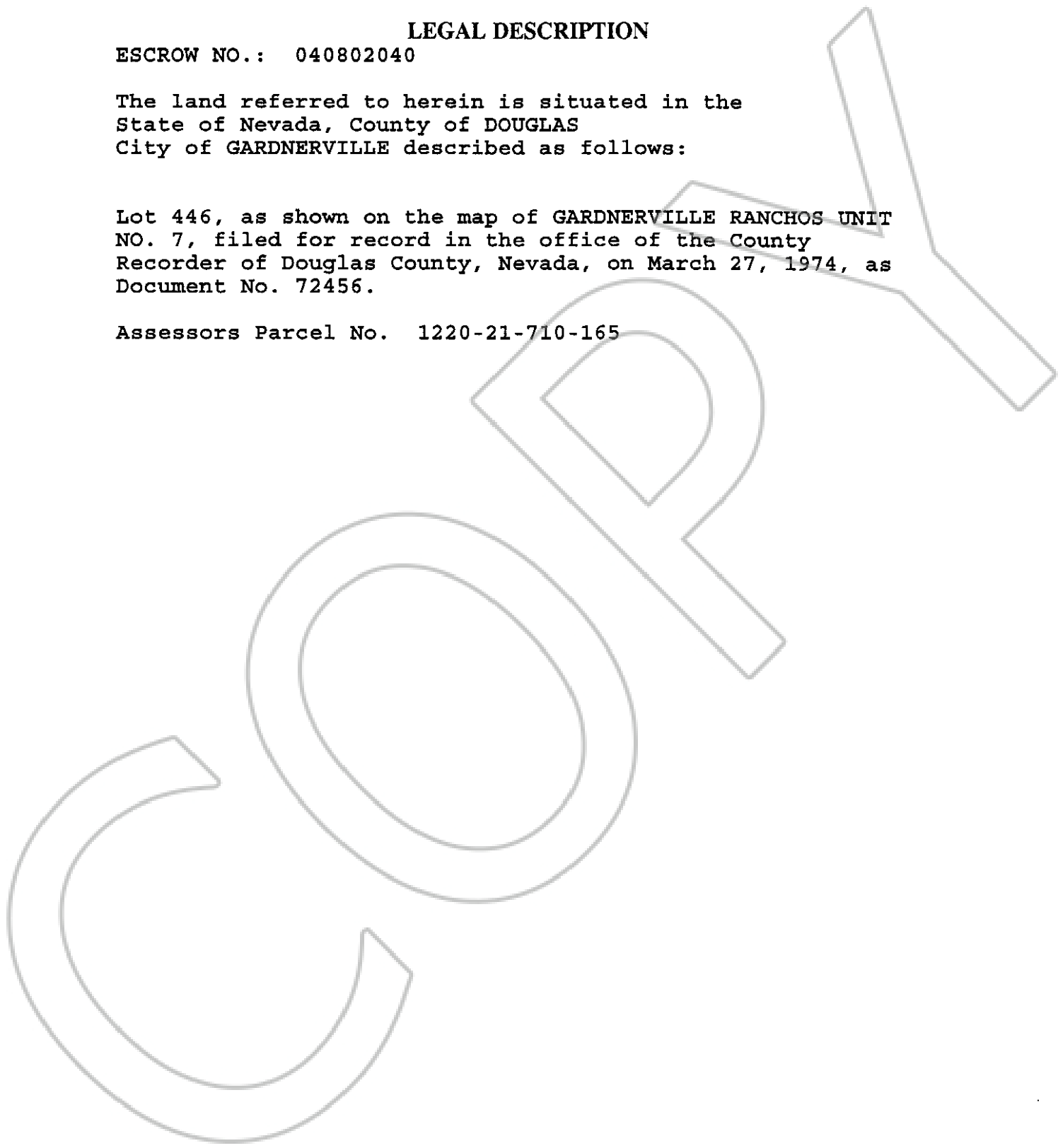

0622092

BK0804PG08877