

EXHIBIT "A"

LEGAL DESCRIPTION

ESCROW NO.: 040201815

The land referred to herein is situated in the
State of Nevada, County of Douglas
City of GARDNERVILLE described as follows:

Lot 10, as shown on the Final Map of SILVERANCH UNIT 2-A,
filed for record in the office of the County Recorder of
Douglas County, State of Nevada, on September 2, 1994, in
Book 994, Page 342, as Document No. 345409.

Assessors Parcel No. 1220-09-413-010

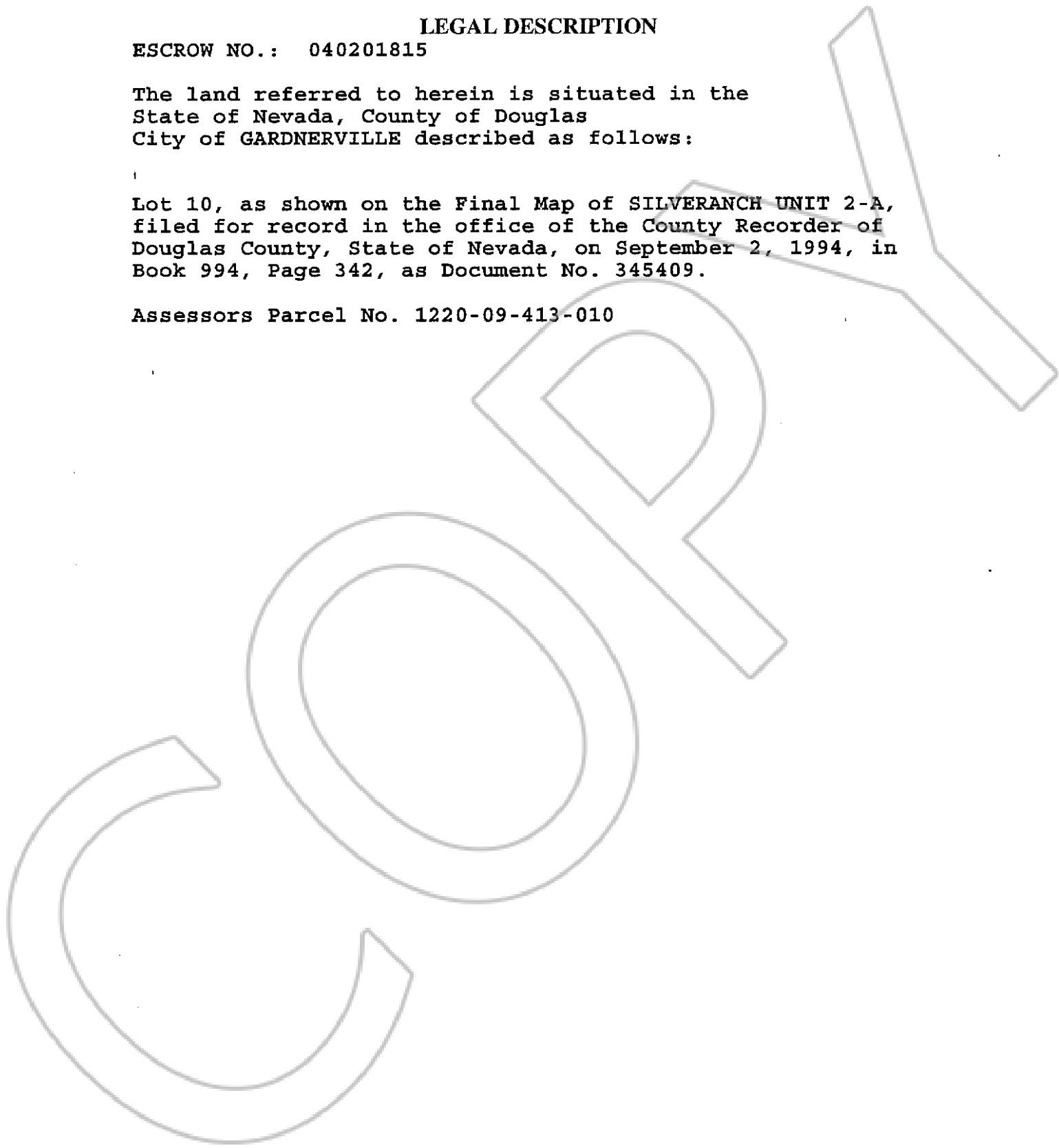

0622223
BK0804PG09347