



**EXHIBIT "A"**

**LEGAL DESCRIPTION**

ESCROW NO.: 040302250

The land referred to herein is situated in the State of Nevada, County of DOUGLAS described as follows:

Lot 1, as shown on the map of GARDNERVILLE RANCHOS UNIT NO. 7, filed for record in the office of the County Recorder of Douglas County, Nevada, on March 27, 1974, as Document No. 72456.

Assessors Parcel No. 1220-21-710-018

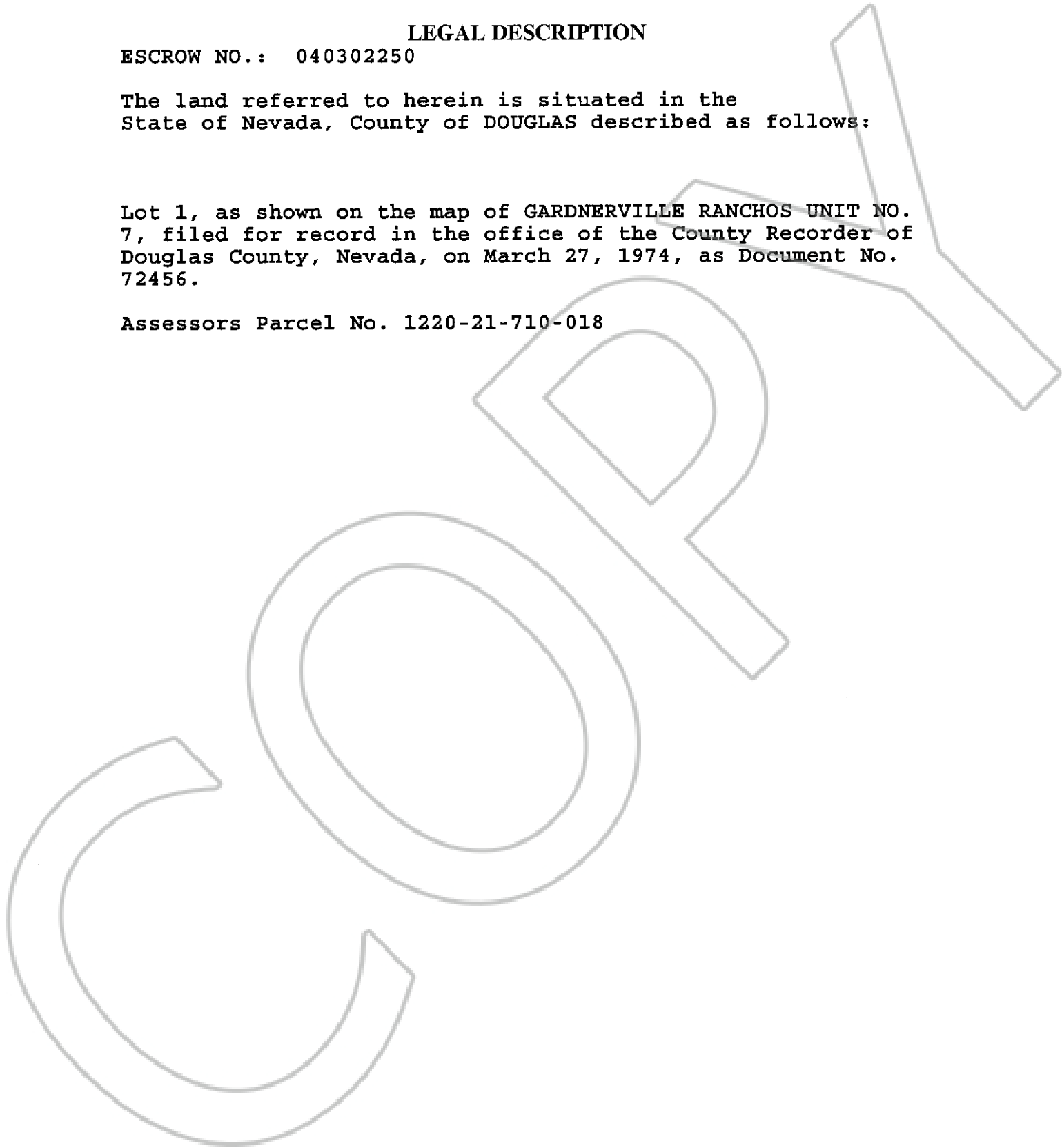

0622275

BK0804PG09522