

A.P.N. # 1420-21-810-001

R.P.T.T. \$ 1907.10

ESCROW NO. 040802007

RECORDING REQUESTED BY:
STEWART TITLE COMPANY

MAIL TAX STATEMENTS TO:
SAME AS BELOW

WHEN RECORDED MAIL TO:
GRANTEE
8484 LOMITA DRIVE
ALTA LOMA, CA 91701

REQUESTED BY
Stewart Title of Douglas County

IN OFFICIAL RECORDS OF
DOUGLAS CO., NEVADA

2004 AUG 25 PM 3:16

WERNER CHRISTEN
RECORDER

\$15⁰⁰ PAID *kg* DEPUTY

(Space Above for Recorder's Use Only)

GRANT, BARGAIN, SALE DEED

THIS INDENTURE WITNESSETH: That **DUANE E. CHRISTIAN AND JEANETTE M. CHRISTIAN, TRUSTEES OF THE CHRISTIAN FAMILY TRUST DATED JUNE 7, 1983 AND FURTHER SECOND AMENDED, ON APRIL 30, 2001 AND THIRD AMENDED ON DECEMBER 5, 2002**

in consideration of \$10.00, the receipt of which is hereby acknowledged, does hereby Grant, Bargain Sell and Convey to **JAMES H. CLINE, JR AND LORITA F. CLINE, HUSBAND AND WIFE AS JOINT TENANTS**

and to the heirs and assigns of such Grantee forever, all that real property situated in the County of **Douglas** State of Nevada, bounded and described as:

SEE EXHIBIT "A" ATTACHED HERETO AND MADE A PART HEREOF

Together with all and singular the tenements, hereditaments and appurtenances thereunto belonging or in anywise appertaining, and any reversions, remainders, rents, issues or profits thereof.

DATE: **August 05, 2004** **CHRISTIAN FAMILY TRUST**
DATED JUNE 7, 1983

BY: *Duane E. Christian*
DUANE E. CHRISTIAN
TRUSTEE

BY: *Jeanette M. Christian*
JEANETTE M. CHRISTIAN
TRUSTEE

STATE OF NEVADA }
COUNTY OF DOUGLAS } ss.

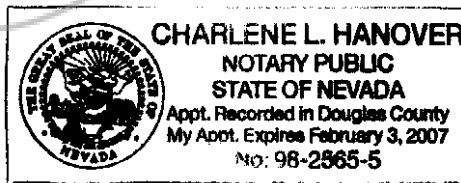

This instrument was acknowledged before me on 8/10/2004,
by DUANE E. CHRISTIAN and JEANETTE M. CHRISTIAN TRUSTEES

Signature *Charlene L. Hanover*

Notary Public (One Inch Margin on all sides of Document for Recorders Use Only)

0622508

BK0804PG10820

EXHIBIT "A"

LEGAL DESCRIPTION

ESCROW NO.: 040802007

The land referred to herein is situated in the
State of Nevada, County of Douglas
City of MINDEN described as follows:

Lot 1, Block A, as shown on the map of MISSION HOT SPRINGS
III, filed for record in the Office of the County Recorder
of Douglas County, State of Nevada, on June 30, 1992, Book
692, Page 6000, Document No. 282411.

Assessors Parcel No. 1420-21-810-001

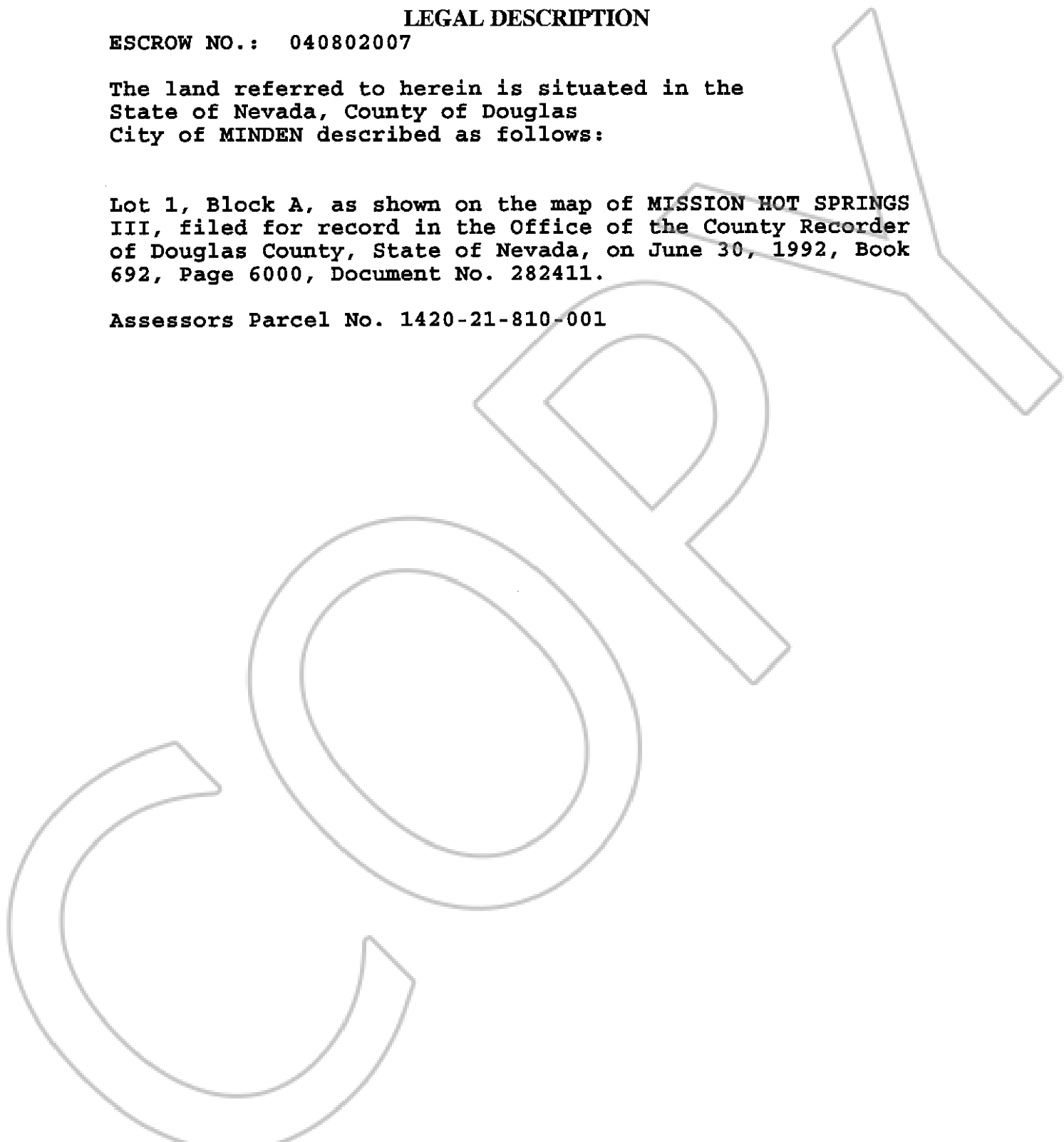

0622508
BK0804PG10821