

EXHIBIT "A"

LEGAL DESCRIPTION

ESCROW NO.: 040302232

The land referred to herein is situated in the State of Nevada, County of Douglas described as follows:

Lot 239, as shown on the map of GARDNERVILLE RANCHOS UNIT NO. 7, filed for record in the office of the County Recorder of Douglas County, Nevada, on March 27, 1974, as Document No. 72456.

Assessors Parcel No. 1220-21-810-101

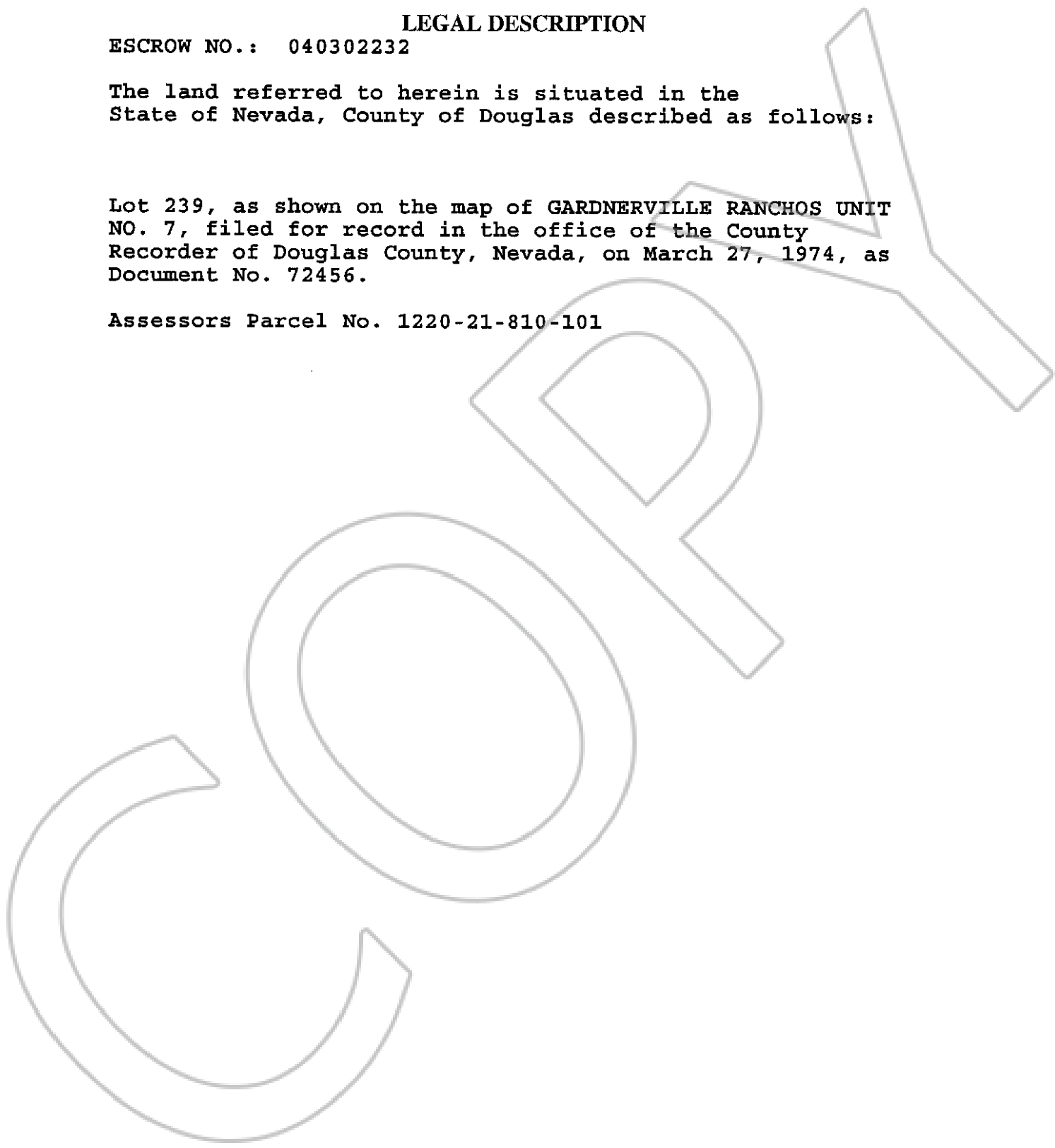

0622601

BK0804PG11375