

A.P.N. # 1320-32-118-002

R.P.T.T. \$ -0- Ex # 6

MAIL TAX STATEMENTS TO:
SAME AS BELOW

WHEN RECORDED MAIL TO:
GRANTEE
✓ 1552 COUNTY ROAD
MINDEN, NEVADA

REQUESTED BY
Catherine Bishop
IN OFFICIAL RECORDS OF
DOUGLAS CO., NEVADA

2004 AUG 30 AM 9:12

WERNER CHRISTEN
RECORDER
\$ 15.00 PAID Be DEPUTY

(Space Above for Recorder's Use Only)

GRANT, BARGAIN, SALE DEED

THIS INDENTURE WITNESSETH: That **GODFREY BISHOP AND CATHARINE BISHOP, HUSBAND AND WIFE AND JANET F. FRANKLIN, AN UNMARRIED WOMAN, ALL AS JOINT TENANTS**

in consideration of \$10.00, the receipt of which is hereby acknowledged, does hereby Grant, Bargain Sell and Convey to **GODFREY M. BISHOP, TRUSTEE AND CATHARINE D. BISHOP, TRUSTEE OF THE GODFREY M. BISHOP AND CATHARINE D. BISHOP REVOCABLE TRUST, DATED FEBRUARY 24, 1999**

and to the heirs and assigns of such Grantee forever, all that real property situated in the County of **Douglas** State of Nevada, bounded and described as:
SEE EXHIBIT "A" ATTACHED HERETO AND MADE A PART HEREOF

Together with all and singular the tenements, hereditaments and appurtenances thereunto belonging or in anywise appertaining, and any reversions, remainders, rents, issues or profits thereof.

DATE: **August 24, 2004**

Godfrey Bishop
GODFREY BISHOP
Catharine Bishop
CATHARINE BISHOP,
Janet F. Franklin
JANET F. FRANKLIN

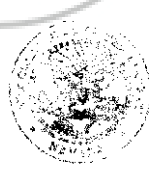
 **SUZANNE CHEECHOV**
NOTARY PUBLIC
STATE OF NEVADA
Recorded in Douglas County
Exp. Expires June 25, 2007
No. 00-0000-5

STATE OF NV }
COUNTY OF Douglas } ss.

This instrument was acknowledged before me on 8/30/04
by GODFREY BISHOP and CATHARINE BISHOP,
and JANET F. FRANKLIN

Signature *Suzanne Cheechev*
Notary Public (One inch margin on all sides of document for Recorder's Use Only)

0622790

BK0804PG12288

EXHIBIT "A"

LEGAL DESCRIPTION

The land referred to herein is situated in the State of Nevada, County of Douglas described as follows:

Lot 2, in Block A, as shown on the map of SOUTHEAST ADDITION to TOWN OF MINDEN, filed in the Office of the County Recorder of Douglas County, Nevada, on November 27, 1961, as Document No. 19150.

Assessors Parcel No. 1320-32-118-002

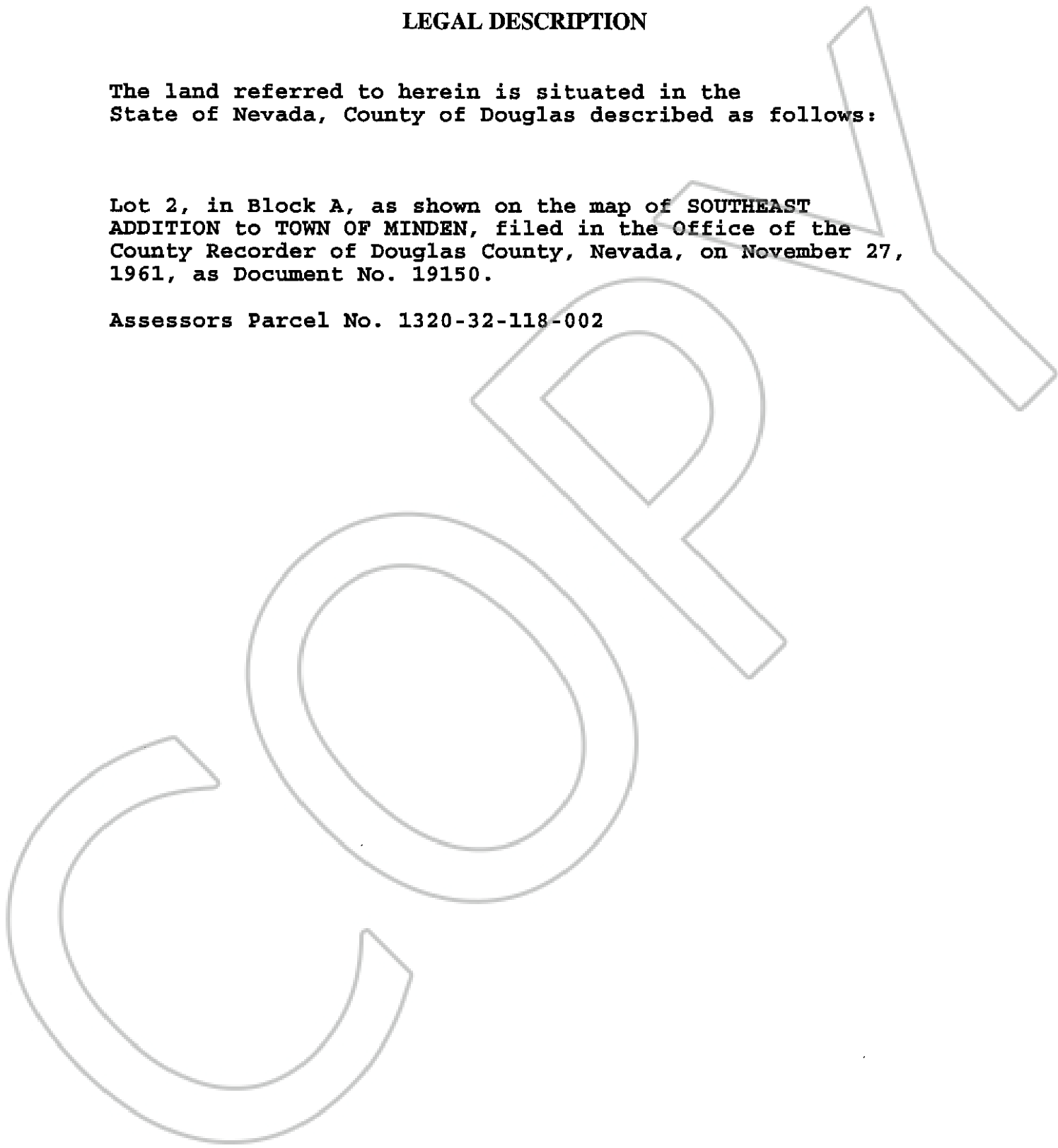

0622790

BK0804PG12289