

A.P.N. # 1022-16-001-032

R.P.T.T. \$ 546.00
ESCROW NO. 040102337

RECORDING REQUESTED BY:
STEWART TITLE COMPANY
MAIL TAX STATEMENTS TO:
SAME AS BELOW

WHEN RECORDED MAIL TO:
GRANTEE
211 SANDY COURT
DIAMOND SPRINGS, CA 95619

REQUESTED BY
Stewart Title of Douglas County

IN OFFICIAL RECORDS OF
DOUGLAS CO., NEVADA

2004 AUG 30 PM 3:44

WERNER CHRISTEN
RECORDER

\$ 15.00 PAID BC DEPUTY

(Space Above for Recorder's Use Only)

GRANT, BARGAIN, SALE DEED

THIS INDENTURE WITNESSETH: That **DANIEL G. BOWMAN AND REGINA C. BOWMAN, HUSBAND AND WIFE**

in consideration of \$10.00, the receipt of which is hereby acknowledged, does hereby Grant, Bargain Sell and Convey to **PAUL THOMAS CONVERSE AND CORYNNE DEE CONVERSE, TRUSTEES OF THE CONVERSE FAMILY 1998 REVOCABLE TRUST**

and to the heirs and assigns of such Grantee forever, all that real property situated in the County of **Douglas** State of Nevada, bounded and described as:

SEE EXHIBIT "A" ATTACHED HERETO AND MADE A PART HEREOF

Together with all and singular the tenements, hereditaments and appurtenances thereunto belonging or in anywise appertaining, and any reversions, remainders, rents, issues or profits thereof.

DATE: **August 18, 2004**

Daniel G. Bowman

DANIEL G. BOWMAN
Regina C. Bowman

REGINA C. BOWMAN

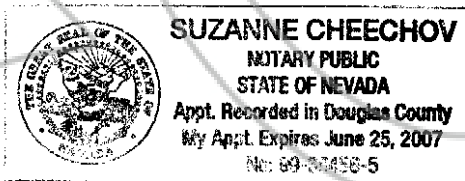

STATE OF NV }
COUNTY OF Douglas } ss.

This instrument was acknowledged before me on 8/26/04
by DANIEL G. BOWMAN and REGINA C. BOWMAN

Signature Suzanne Cheechov

Notary Public (One inch margin on all sides of document for Recorder's Use Only)

0622965
BK0804PG12997

EXHIBIT "A"

LEGAL DESCRIPTION

ESCROW NO.: 040102337

The land referred to herein is situated in the
State of Nevada, County of Douglas
City of WELLINGTON described as follows:

Lot 3, in Block M, as shown on the map entitled TOPAZ RANCH
ESTATES, UNIT NO. 4, filed for record November 16, 1970, in
the Office of the County Recorder of Douglas County,
Nevada, as Document No. 50212.

Assessor's Parcel No. 1022-16-001-032.

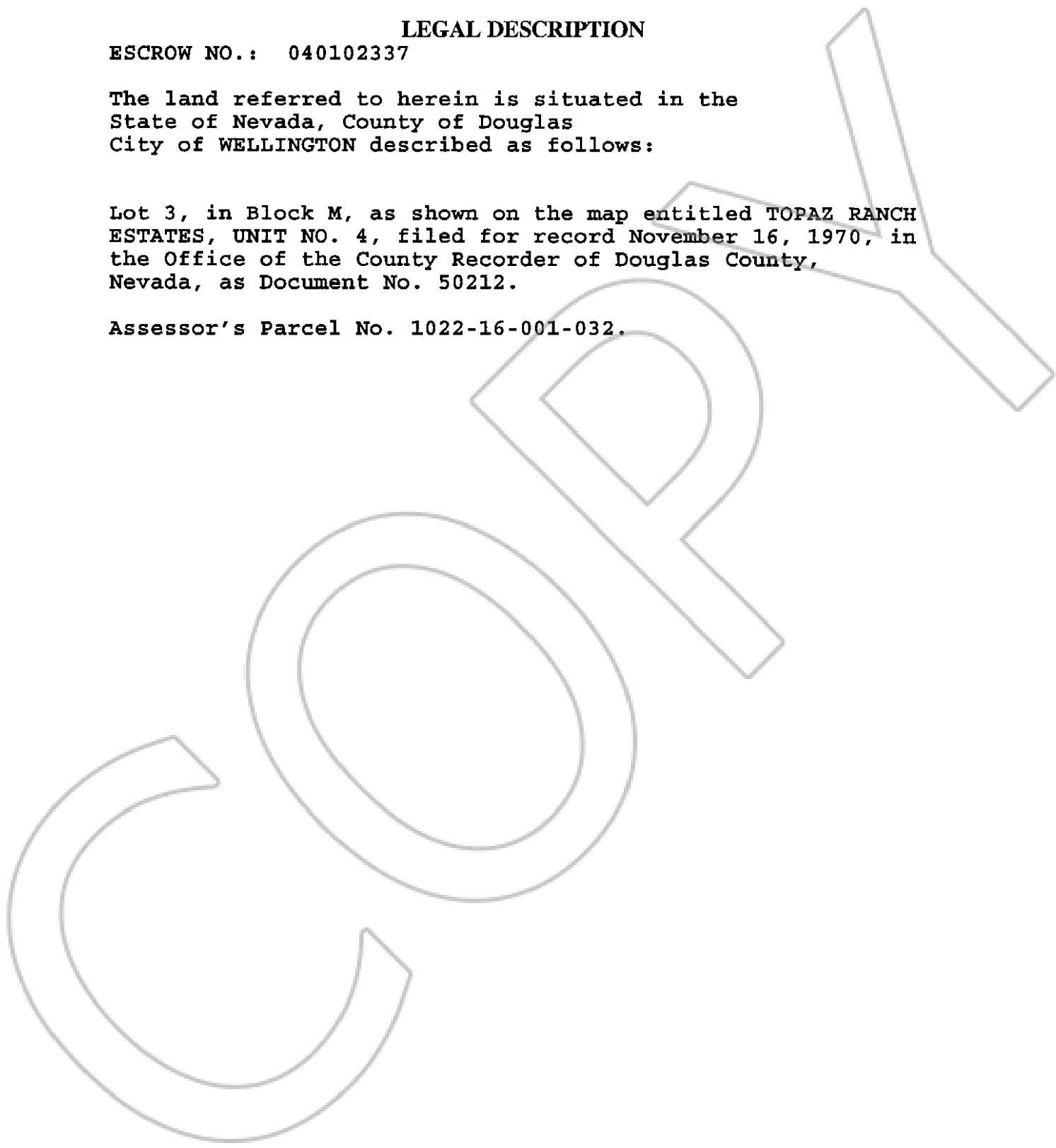

0622965

BK0804PG12998