

A.P.N. # 1420-33-312-038

R.P.T.T.S. 0#5  
ESCROW NO. 04042556 / 040502570

RECORDING REQUESTED BY:  
**STEWART TITLE COMPANY**  
MAIL TAX STATEMENTS TO:  
**SAME**

WHEN RECORDED MAIL TO:  
**RACHAL**  
**1257 WRANGLER CIRCLE**  
**MINDEN, NV 89423**

REQUESTED BY  
**Stewart Title of Douglas County**  
IN OFFICIAL RECORDS OF  
DOUGLAS CO., NEVADA

2004 AUG 30 PM 3:49

WERNER CHRISTEN  
RECORDER  
\$ 1500 PAID BE DEPUTY

(Space Above for Recorder's Use Only)

### GRANT, BARGAIN, SALE DEED

THIS INDENTURE WITNESSETH: That **MICHELLE P. RACHAL, AN UNMARRIED WOMAN**

in consideration of \$10.00, the receipt of which is hereby acknowledged, does hereby Grant, Bargain Sell and Convey to **LOUIS T. RACHAL, AN UNMARRIED MAN**

and to the heirs and assigns of such Grantee forever, all that real property situated in the  
County of **DOUGLAS COUNTY** State of Nevada, bounded and described as :

**SEE EXHIBIT "A" ATTACHED HERETO AND MADE A PART HEREOF**

IT IS THE EXPRESS INTENT OF THE GRANTOR, BEING THE SPOUSE OF THE GRANTEE, TO CONVEY ALL RIGHT, TITLE AND INTEREST OF THE GRANTOR, COMMUNITY OR OTHERWISE, IN AND TO THE HEREIN DESCRIBED PROPERTY TO THE GRANTEE AS GRANTEE'S SOLE AND SEPARATE PROPERTY.

Together with all and singular the tenements, hereditaments and appurtenances thereunto belonging or in anywise appertaining, and any reversions, remainders, rents, issues or profits thereof.

DATE: **August 24, 2004**

  
**MICHELLE P. RACHAL**

STATE OF Nevada }  
  } ss.  
COUNTY OF CARSON CITY }

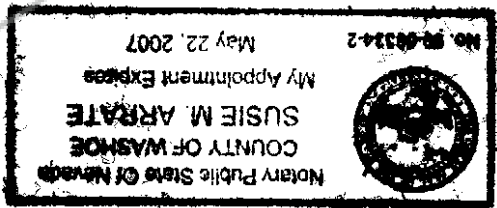

This instrument was acknowledged before me on Aug 24, 2004,  
by MICHELLE P. RACHAL

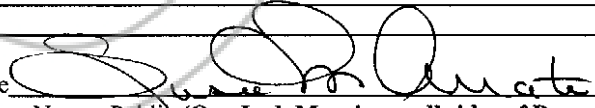
Signature   
\_\_\_\_\_  
Notary Public

(One Inch Margin on all sides of Document for Recorder's Use Only)

0622969

BK 0804 PG 13009

## LEGAL DESCRIPTION

The land referred to herein is situated in the State of Nevada,  
County of DOUGLAS, described as follows:

Lot 221, as shown on the Final Map of WILDHORSE UNIT 6, A  
PLANNED UNIT DEVELOPMENT, filed for record in the office of  
the County Recorder of Douglas County, State of Nevada, on  
March 15, 1994 in Book 394, Page 2741, as Document No.  
332336.

Assessors Parcel No. 1420-33-312-038

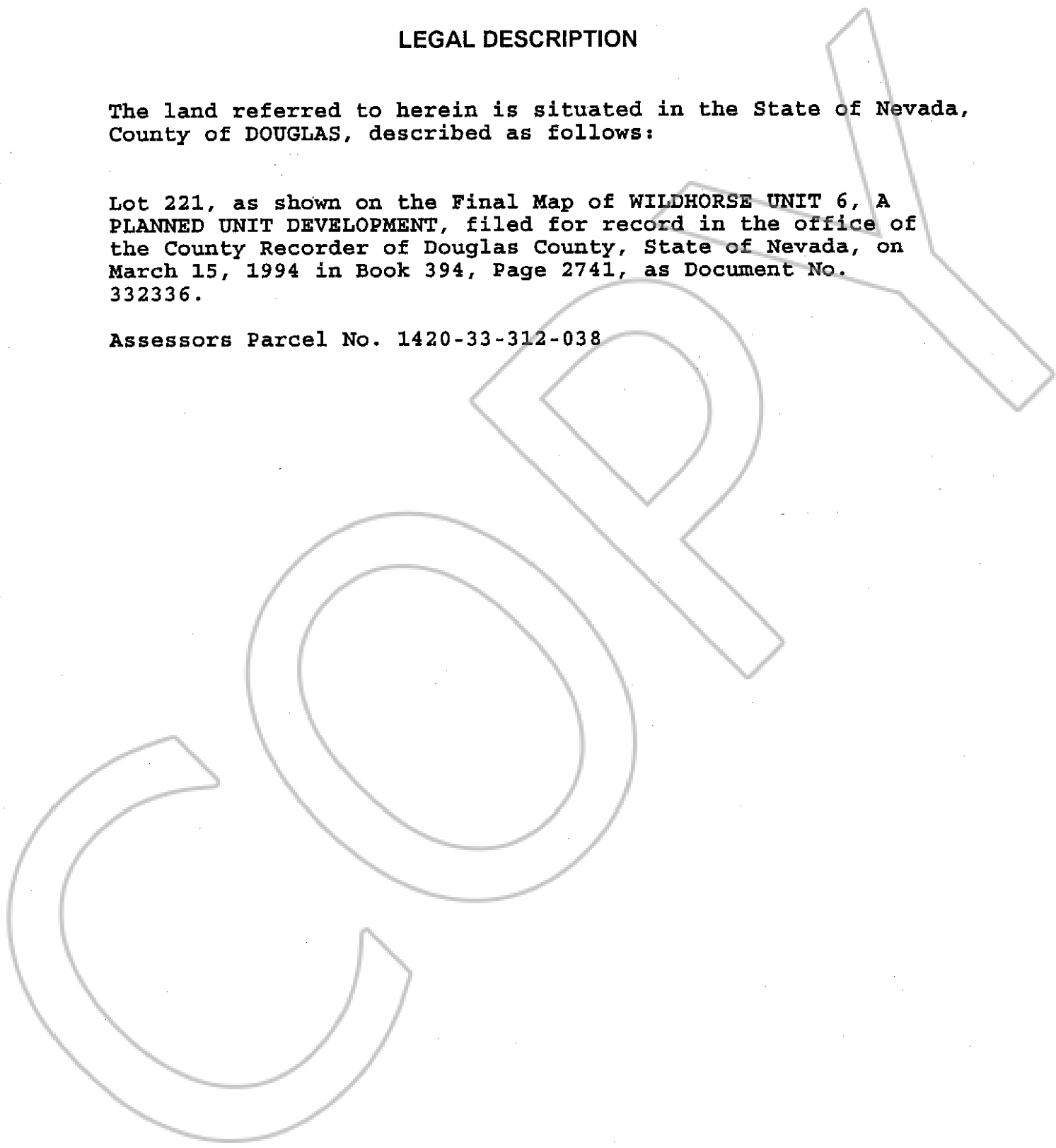

0622969

BK0804PG13010