

A.P.N. # 1220-16-610-060

R.P.T.T. \$ 910.65
ESCROW NO. 040200996

RECORDING REQUESTED BY:
STEWART TITLE COMPANY
MAIL TAX STATEMENTS TO:

Mr & Mrs. Parker
2055 Lukins Way
S. Lake Tahoe CA 96150

WHEN RECORDED MAIL TO:
Mr & Mrs. Parker
2055 Lukins Way
S. Lake Tahoe CA 96150

REQUESTED BY
Stewart Title of Douglas County
IN OFFICIAL RECORDS OF
DOUGLAS CO., NEVADA

2004 SEP -1 PM 2:58

WERNER CHRISTEN
RECORDER

\$ 15.00 PAID W DEPUTY

(Space Above for Recorder's Use Only)

GRANT, BARGAIN, SALE DEED

THIS INDENTURE WITNESSETH: That **ROBERTA ROSS, A SINGLE WOMAN**

in consideration of \$10.00, the receipt of which is hereby acknowledged, does hereby Grant, Bargain Sell and Convey to **DARRELL PARKER AND TERRENE PARKER, HUSBAND AND WIFE**
AS JOINT TENANTS

and to the heirs and assigns of such Grantee forever, all that real property situated in the
County of **Douglas** State of Nevada, bounded and described as:

SEE EXHIBIT "A" ATTACHED HERETO AND MADE A PART HEREOF

Together with all and singular the tenements, hereditaments and appurtenances thereunto belonging or in anywise appertaining, and any reversions, remainders, rents, issues or profits thereof.

DATE: **August 05, 2004**

ROBERTA ROSS



STATE OF Nevada }
COUNTY OF Douglas } ss.

This instrument was acknowledged before me on 8.31.04
by **ROBERTA ROSS**

Signature Mary H Kesh

Notary Public (One inch margin on all sides of document for Recorder's Use Only)

0623218

BK0904PG00379

EXHIBIT "A"

LEGAL DESCRIPTION

ESCROW NO.: 040200996

The land referred to herein is situated in the State of Nevada, County of Douglas City of GARDNERVILLE described as follows:

Lot 189, as said lot is shown on the Official Plat of GARDNERVILLE RANCHOS UNIT NO. 2, filed in the office of the County Recorder of Douglas County, Nevada, on June 1, 1965, in Book 1 of Maps, filed as No. 28309, and Title Sheet amended on June 4, 1965, as Filing No. 28377.

Assessor's Parcel No. 1220-16-610-060

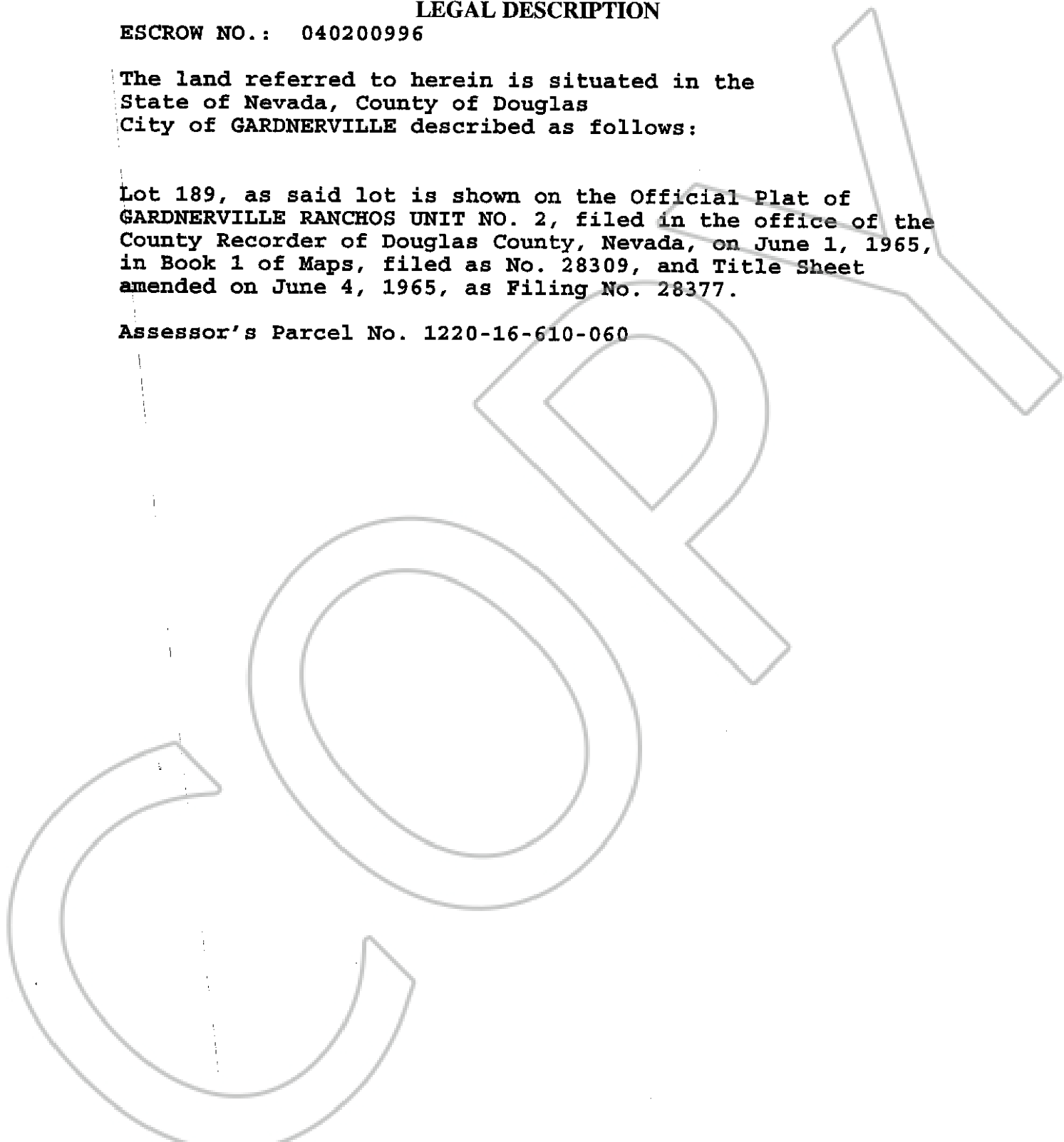

0623218
BK0904PG00380