

A.P.N. # 1220-21-810-086

R.P.T.T. \$ 1,021.80

ESCROW NO. 040102310

RECORDING REQUESTED BY:
STEWART TITLE COMPANY
MAIL TAX STATEMENTS TO:
SAME AS BELOW

WHEN RECORDED MAIL TO:
GRANTEE
643 BLUEROCK ROAD
GARDNERVILLE, NV

REQUESTED BY
Stewart Title of Douglas County
IN OFFICIAL RECORDS OF
DOUGLAS CO., NEVADA

2004 SEP -2 PM 3:50

WERNER CHRISTEN
RECORDER

\$ 15.00 PAID AK DEPUTY

(Space Above for Recorder's Use Only)

GRANT, BARGAIN, SALE DEED

THIS INDENTURE WITNESSETH: That **CARL E. GILREATH AND MABEL W. GILREATH, HUSBAND AND WIFE**

in consideration of \$10.00, the receipt of which is hereby acknowledged, does hereby Grant, Bargain Sell and Convey to **SHEILA ANN JONES, A MARRIED WOMAN AS HER SOLE AND SEPARATE PROPERTY**

and to the heirs and assigns of such Grantee forever, all that real property situated in the County of **Douglas** State of Nevada, bounded and described as:

SEE EXHIBIT "A" ATTACHED HERETO AND MADE A PART HEREOF

Together with all and singular the tenements, hereditaments and appurtenances thereunto belonging or in anywise appertaining, and any reversions, remainders, rents, issues or profits thereof.

DATE: **August 18, 2004**

Carl E. Gilreath
CARL E. GILREATH

Mabel W. Gilreath
MABEL W. GILREATH

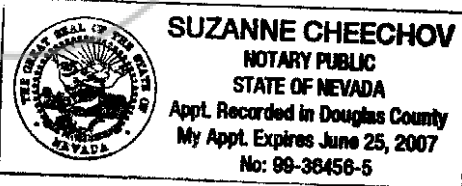

STATE OF NV }
COUNTY OF Douglas } ss.

This instrument was acknowledged before me on 9/1/04
by CARL E. GILREATH and MABEL W. GILREATH

Signature Suzanne Cheechov
Notary Public (One inch margin on all sides of document for Recorder's Use Only)

0623310
BK0904PG00962

EXHIBIT "A"

LEGAL DESCRIPTION

ESCROW NO.: 040102310

**The land referred to herein is situated in the
State of Nevada, County of Douglas
City of GARDNERVILLE described as follows:**

**Lot 186, as shown on the map of GARDNERVILLE RANCHOS UNIT
NO. 7, filed for record in the office of the County
Recorder of Douglas County, Nevada, on March 27, 1974, as
Document No. 72456.**

Assessors Parcel No. 1220-21-810-086

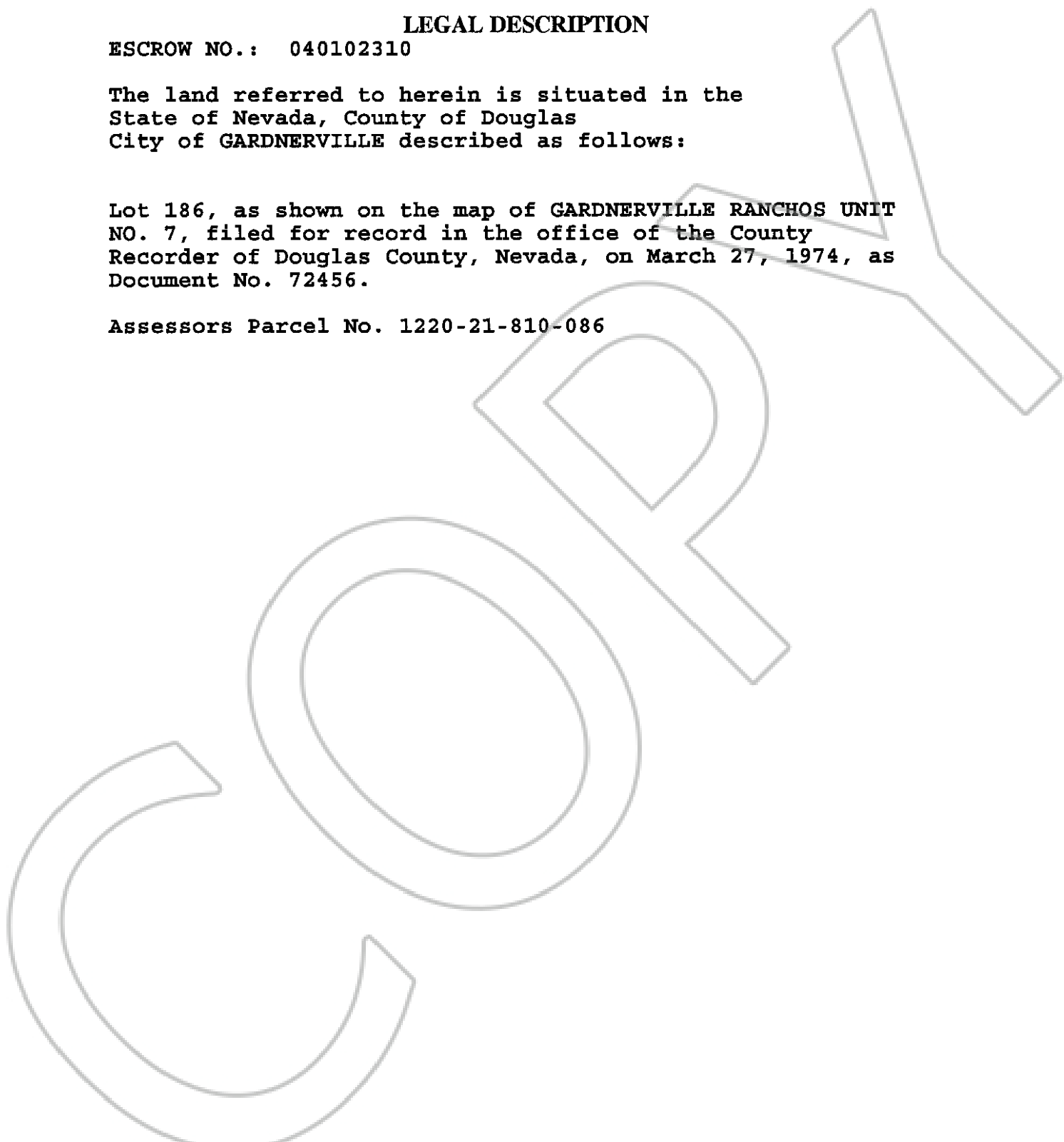

0623310

BK0904PG00963