

A.P.N. # 1220-15-611-017

R.P.T.T. \$ 1501.50

ESCROW NO. 040201834

RECORDING REQUESTED BY:
STEWART TITLE COMPANY

MAIL TAX STATEMENTS TO:
SHOU MEE TRUST
P.O. 55
Zephyr Cove, NV 89448

WHEN RECORDED MAIL TO:
SHOU MEE TRUST
p.o. 55
Zephyr Cove, NV 89448

REQUESTED BY

Stewart Title of Douglas County
IN OFFICIAL RECORDS OF
DOUGLAS CO., NEVADA

2004 SEP -8 PM 3:44

WERNER CHRISTEN
RECORDER

\$ 1500 PAID rc DEPUTY

(Space Above for Recorder's Use Only)

GRANT, BARGAIN, SALE DEED

THIS INDENTURE WITNESSETH: That **MICHAEL N. DONAHOE AND PATRICIA D. STOCK, SUCCESSOR TRUSTEES OF THE FRANK B. DONAHOE, TRUST AGREEMENT DATED MARCH 12, 2001**

in consideration of \$10.00, the receipt of which is hereby acknowledged, does hereby Grant, Bargain Sell and Convey to **RICHARD GLASSON AND SUSAN GLASSON TRUSTEES OF THE SHOU MEE TRUST DATED JUNE 10, 1998**

and to the heirs and assigns of such Grantee forever, all that real property situated in the **unincorporated area** County of **DOUGLAS** State of Nevada, bounded and described as:

SEE EXHIBIT "A" ATTACHED HERETO AND MADE A PART HEREOF

Together with all and singular the tenements, hereditaments and appurtenances thereunto belonging or in anywise appertaining, and any reversions, remainders, rents, issues or profits thereof.

DATE: **August 18, 2004**

MICHAEL N. DONAHOE, SUCCESSOR

PATRICIA D. STOCK, SUCCESSOR

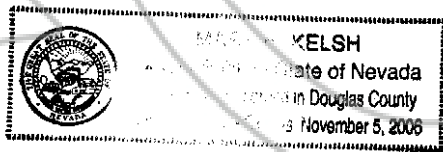

STATE OF Nevada }
COUNTY OF Douglas } ss.

This instrument was acknowledged before me on 8-27-04
by MICHAEL N. DONAHOE, SUCCESSOR and
PATRICIA D. STOCK, SUCCESSOR TRUSTE

Signature Mary H Kelsch
Notary Public (One inch margin on all sides of document for Recorder's Use Only)

0623660
BK0904PG02538

EXHIBIT "A"

LEGAL DESCRIPTION

ESCROW NO.: 040201834

The land referred to herein is situated in the
State of Nevada, County of DOUGLAS
City of GARDNERVILLE described as follows:

Lot 43, as said lot is shown on the Official Plat of GARDNERVILLE
RANCHOS UNIT NO. 3, filed in the office of the County Recorder
of Douglas County, Nevada, on June 1, 1965, and Title Sheet
amended on June 4, 1965, as Document No. 28378.

Assessor's Parcel No. 1220-15-611-017

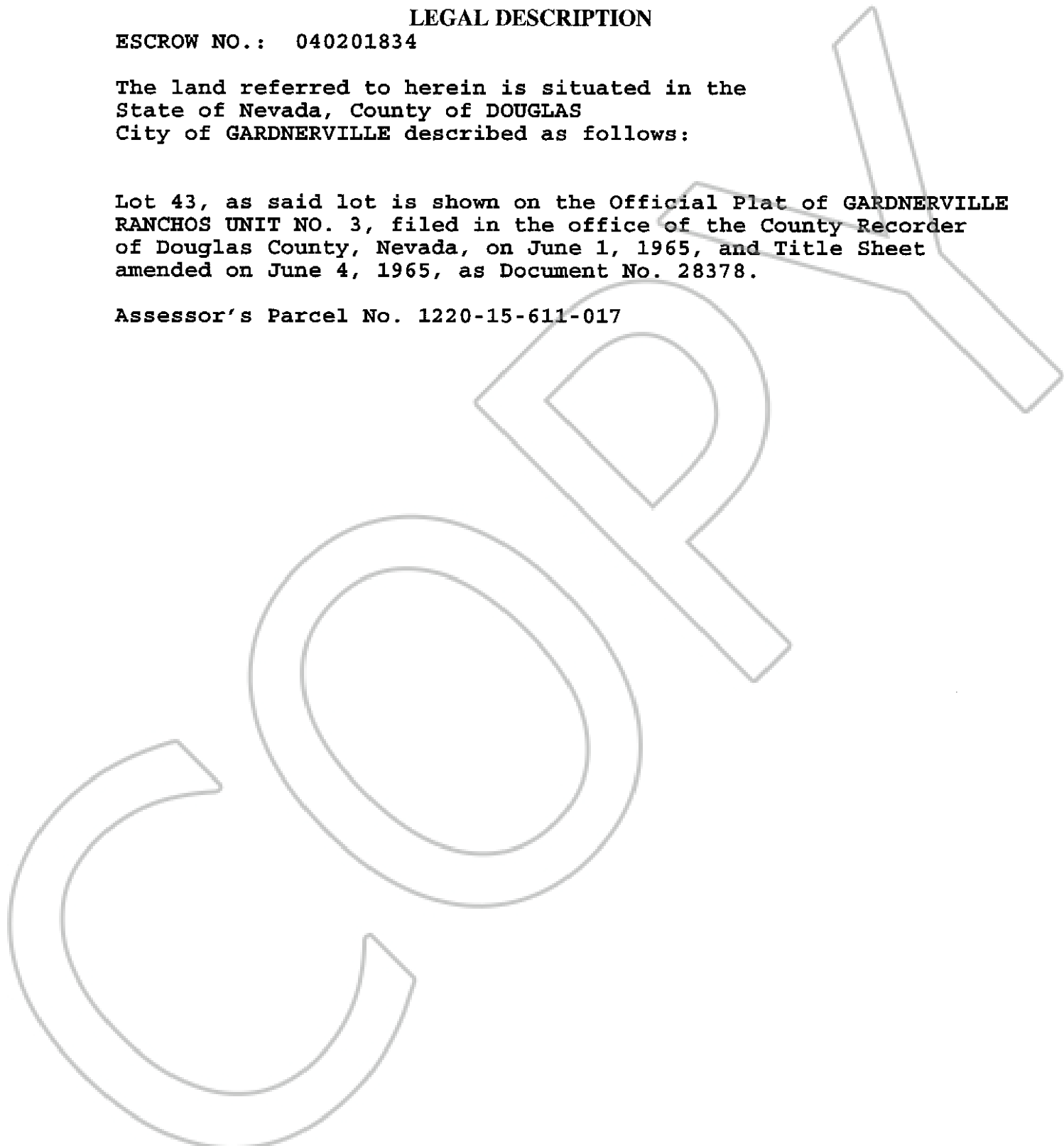

0623660

BK0904PG02539