



**EXHIBIT "A"**

**LEGAL DESCRIPTION**

**ESCROW NO.: S40802037**

**The land referred to herein is situated in the  
State of Nevada, County of DOUGLAS  
City of GARDNERVILLE described as follows:**

**Lot 944, as shown on the map of GARDNERVILLE RANCHOS UNIT  
NO. 7, filed for record in the office of the County  
Recorder of Douglas County, Nevada, on March 27, 1974, as  
Document No. 72456.**

**Assessors Parcel No. 1220-22-410-132**

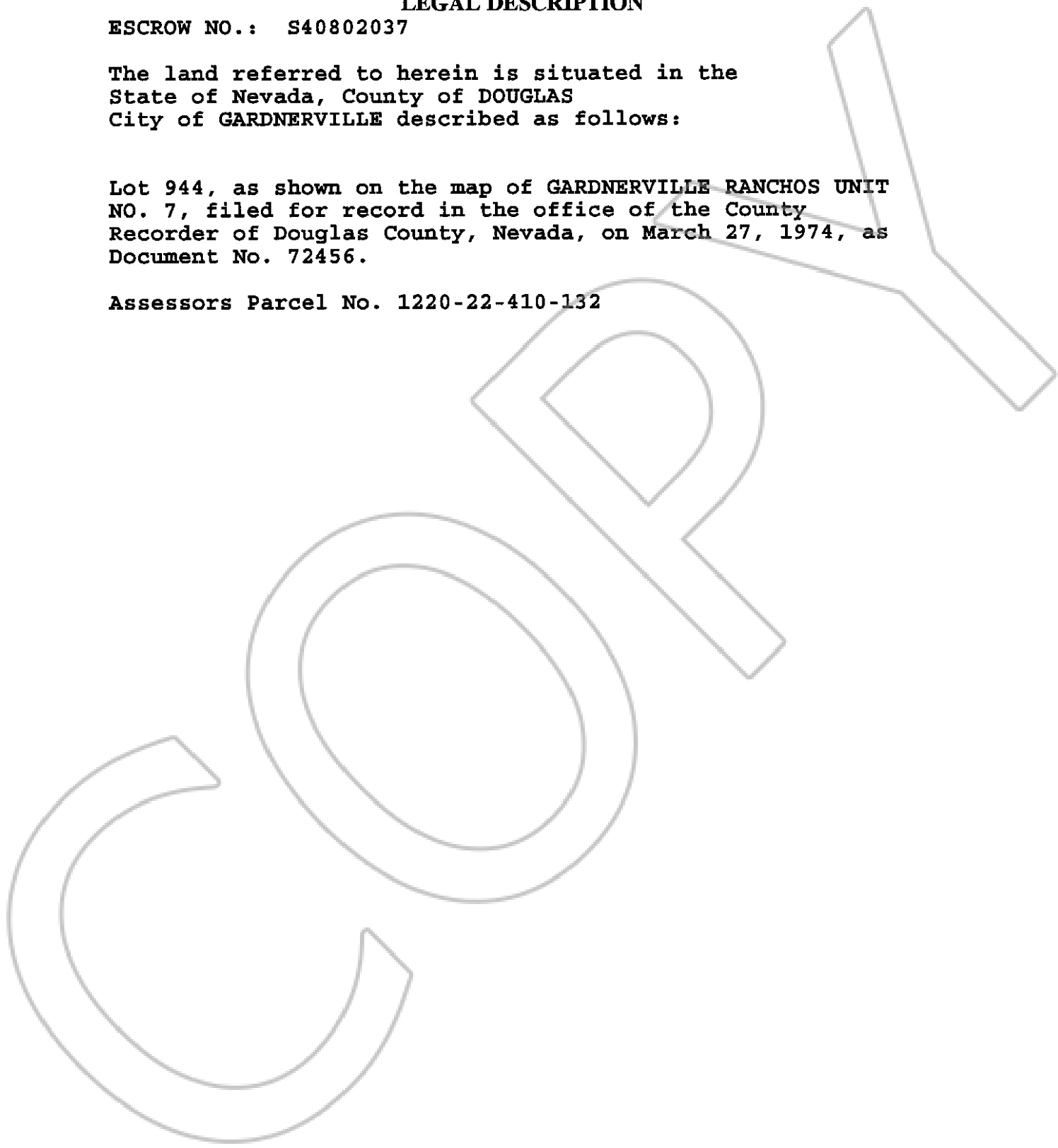

0623857

BK0904PG03729