

REQUESTED BY
WESTERN TITLE COMPANY, INC.
IN OFFICIAL RECORDS OF
DOUGLAS CO., NEVADA

2004 SEP 13 PM 3:47

WERNER CHRISTEN
RECORDER

\$19⁰⁰ PAID *KJ* DEPUTY

APN: 1318-23-218-014
RPTT \$1423.50

WHEN RECORDED MAIL TO:
Name ROBERT A. DREWELL
Street 2510 BEAUMONT PKWY
Address
City,State RENO, NV 89523
Zip

MAIL TAX STATEMENTS TO:
Name ROBERT A. DREWELL
Street 2510 BEAUMONT PKWY
Address
City,State RENO, NV 89523
Zip
Order 00090183-201- SLG
No.

(SPACE ABOVE THIS LINE FOR RECORDERS USE)

GRANT, BARGAIN AND SALE DEED

THIS INDENTURE WITNESSETH: That

FOR A VALUABLE CONSIDERATION, receipt of which is hereby acknowledged, CRAIG A. LUBBOCK, who acquired title with no vesting and LYNN LUBBOCK, his wife as to an undivided ½ interest and SCOTT M. LUBBOCK, who acquired title with vesting who was unmarried as to an undivided ½ interest, do(es) hereby GRANT(s) BARGAIN SELL and CONVEY to ROBERT A. DREWELL and ESTHER BAE, husband and wife, as joint tenants and to the heirs and assigns of such Grantee forever, all the following real property situated in the City of N/A, County of Douglas, State of Nevada bounded and described as follows:

See Exhibit A attached hereto and made a part hereof.

****THIS DEED IS BEING RECORDED IN COUNTERPART AND IS CONSIDERED ONE DOCUMENT****

TOGETHER with all tenements, hereditaments and appurtenances, if any, thereto belonging or appertaining, and any reversions, remainders, rents, issues or profits thereof.

Dated: August 5, 2004

0624013

BK0904PG04506

Craig A. Lubbock
CRAIG A. LUBBOCK

Lynn Lubbock
LYNN LUBBOCK

SCOTT M. LUBBOCK

STATE OF Nevada }
COUNTY OF Douglas } ss

This instrument was acknowledged before me on
8/26/04

by CRAIG A. LUBBOCK, LYNN LUBBOCK,
~~SCOTT M. LUBBOCK~~

[Signature]
Notary Public

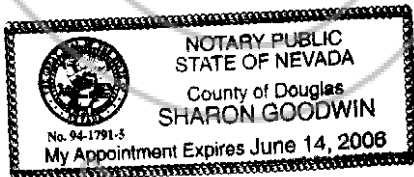

0624013

BK0904PG04507

Exhibit A

All that real property situate in the County of Douglas, State of Nevada, described as follows:

The Land referred to in this policy is situated in the State of Nevada, County of Douglas, and is described as follows:

All that certain lot, piece or parcel of land situate in the County of Douglas, State of Nevada, described as follows:

Parcel "B" as shown on that certain parcel map recorded as Document No. 76520, in Book 974 of Official records at page 740, September 24, 1974, and being further described as being a portion of Lot 60 as shown on that certain Record Map of LAKE VILLAGE, UNIT NO. 2-D, recorded as Document No. 59803 in book 101 of Official Records at Page 277.

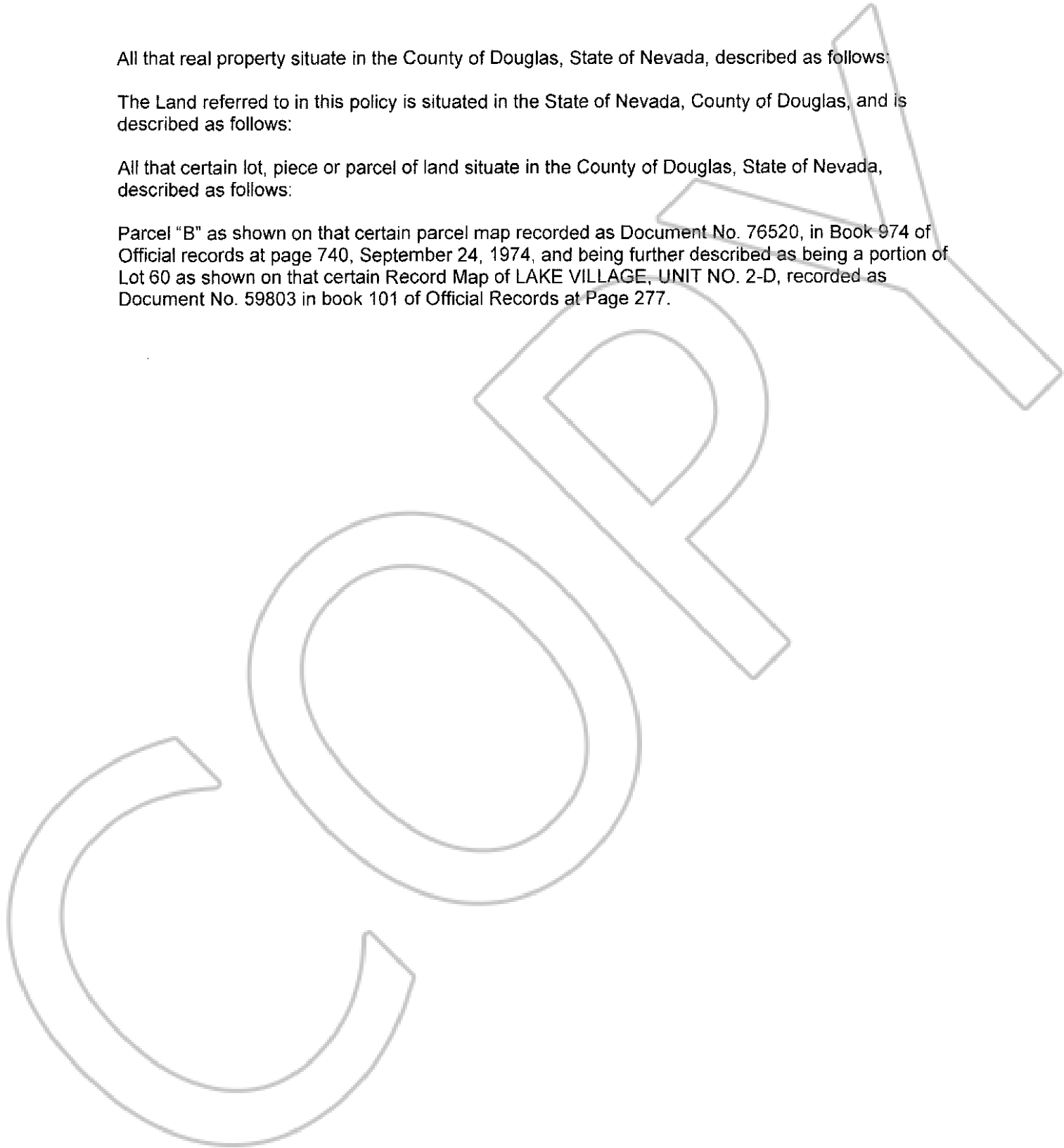

0624013
BK0904PG04508

APN: 1318-23-218-014
RPTT \$1423.50

	WHEN RECORDED MAIL TO:
Name	ROBERT A. DREWELL
Street	2510 BEAUMONT PKWY
Address	
City,State	RENO, NV 89523
Zip	
	MAIL TAX STATEMENTS TO:
Name	ROBERT A. DREWELL
Street	2510 BEAUMONT PKWY
Address	
City,State	RENO, NV 89523
Zip	
Order	00090183-201- SLG
No.	

(SPACE ABOVE THIS LINE FOR RECORDERS USE)

GRANT, BARGAIN AND SALE DEED

THIS INDENTURE WITNESSETH: That

FOR A VALUABLE CONSIDERATION, receipt of which is hereby acknowledged, CRAIG A. LUBBOCK, who acquired title with no vesting and LYNN LUBBOCK, his wife as to an undivided ½ interest and SCOTT M. LUBBOCK, who acquired title with vesting who was unmarried as to an undivided ½ interest, do(es) hereby GRANT(s) BARGAIN SELL and CONVEY to ROBERT A. DREWELL and ESTHER BAE, husband and wife, as joint tenants and to the heirs and assigns of such Grantee forever, all the following real property situated in the City of N/A, County of Douglas, State of Nevada bounded and described as follows:

See Exhibit A attached hereto and made a part hereof.

TOGETHER with all tenements, hereditaments and appurtenances, if any, thereto belonging or appertaining, and any reversions, remainders, rents, issues or profits thereof.

Dated: August 5, 2004

0624013

BK0904PG04509

CRAIG A. LUBBOCK

LYNN LUBBOCK

Scott M Lubbock

SCOTT M. LUBBOCK

STATE OF Oregon }
COUNTY OF Lane } ss

This instrument was acknowledged before me on

August 23, 2004

by ~~CRAIG A. LUBBOCK, LYNN LUBBOCK,~~
SCOTT M. LUBBOCK

Nancy A. Butler

Notary Public

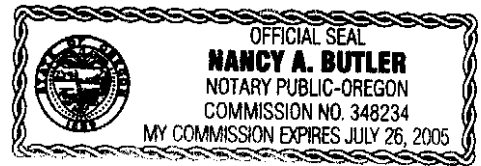

0624013

BK0904PG04510

Exhibit A

All that real property situate in the County of Douglas, State of Nevada, described as follows:

The Land referred to in this policy is situated in the State of Nevada, County of Douglas, and is described as follows:

All that certain lot, piece or parcel of land situate in the County of Douglas, State of Nevada, described as follows:

Parcel "B" as shown on that certain parcel map recorded as Document No. 76520, in Book 974 of Official records at page 740, September 24, 1974, and being further described as being a portion of Lot 60 as shown on that certain Record Map of LAKE VILLAGE, UNIT NO. 2-D, recorded as Document No. 59803 in book 101 of Official Records at Page 277.

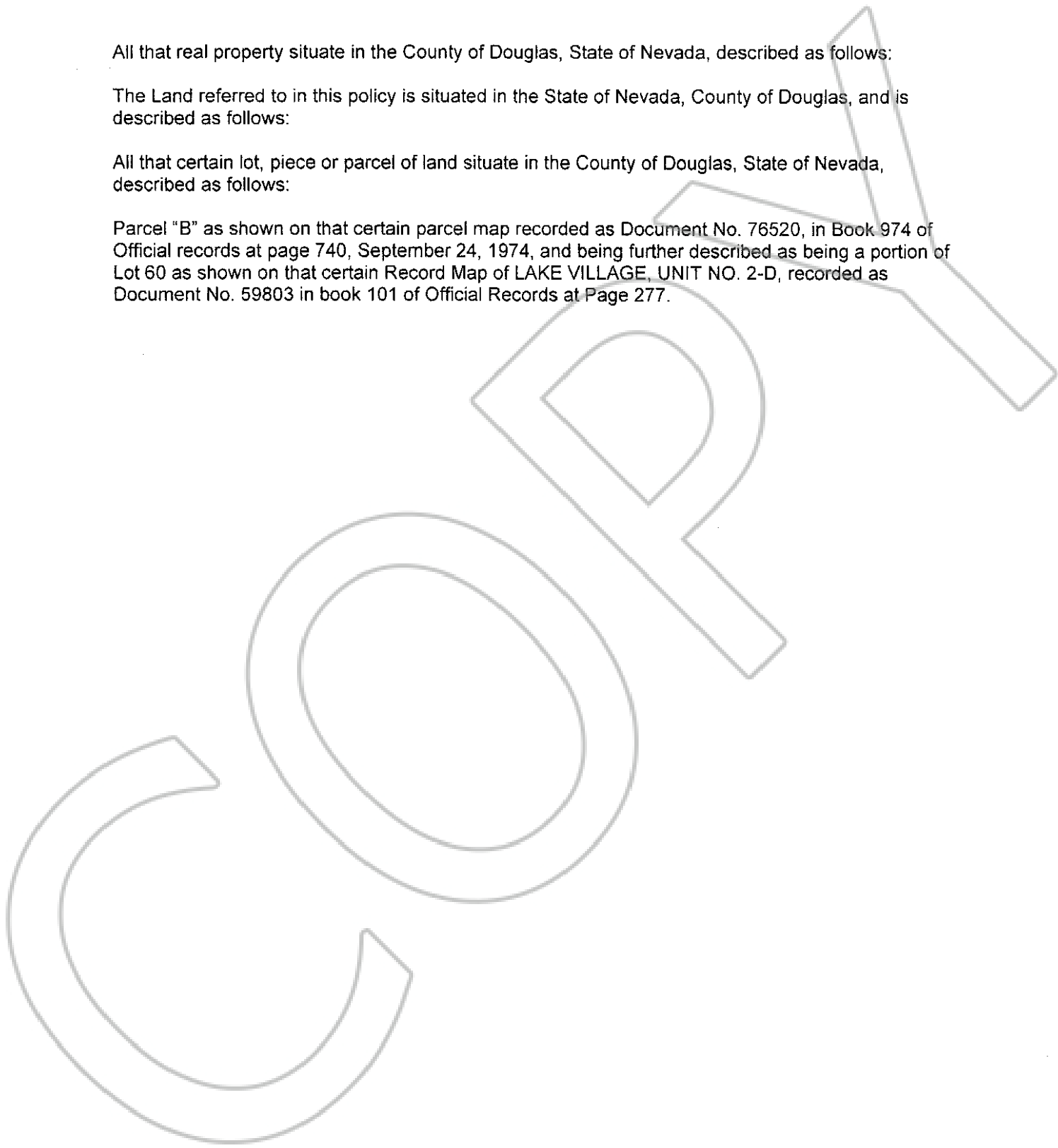

0624013
BK0904PG04511