

A.P.N. # 1320-32-211-011

R.P.T.T. \$ 663.00

ESCROW NO. 040102688

RECORDING REQUESTED BY:

MAIL TAX STATEMENTS TO:

LOGISTICS CONST MGMT LLC

WHEN RECORDED MAIL TO:

Logistics Const. Mgmt, Llc  
1105 Wisteria Drive  
Minden, Nevada 89423

REQUESTED BY  
**Stewart Title of Douglas County**  
IN OFFICIAL RECORDS OF  
DOUGLAS CO., NEVADA

2004 SEP 13 PM 4:05

WERNER CHRISTEN  
RECORDER

\$15<sup>00</sup> PAID KJ DEPUTY

(Space Above for Recorder's Use Only)

## GRANT, BARGAIN, SALE DEED

THIS INDENTURE WITNESSETH: That

KIM POSNIEN CONSTRUCTION AND DEVELOPMENT COMPANY, A  
NEVADA CORPORATION

in consideration of \$10.00, the receipt of which is hereby acknowledged, does hereby Grant, Bargain Sell  
and Convey to

LOGISTICS CONSTRUCTION MANAGEMENT, LLC.

and to the heirs and assigns of such Grantee forever, all that real property situated in the  
County of DOUGLAS State of Nevada, bounded and described as:

**SEE EXHIBIT "A" ATTACHED HERETO AND MADE A PART HEREOF**

Together with all and singular the tenements, hereditaments and appurtenances thereunto belonging or in  
anywise appertaining, and any reversions, remainders, rents, issues or profits thereof.

DATE: SEPTEMBER 10, 2004

KIM POSNIEN CONSTRUCTION AND DEV.  
COMPANY, A NEVADA CORPORATION

BY: [Signature]  
KIMBALL A. POSNIEN, PRESIDENT

This document is recorded as an  
ACCOMODTION ONLY and without  
liability for this consideration therefore, or  
as to the validity or sufficiency of said  
instrument, or for the effect of such  
recording on the title of the property  
involved.

STATE OF NEVADA }  
COUNTY OF DOUGLAS } ss.

This instrument was acknowledged before me on 9/10/04  
by KIMBALL A. POSNIEN

Signature

[Signature]

Notary Public (One Inch Margin on all sides of Document for Recorders Use Only)

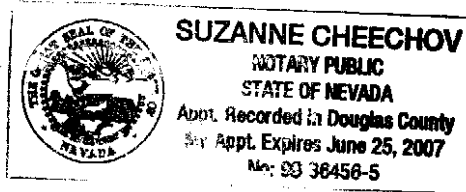

0624025

BK0904PG04631

**EXHIBIT "A"**

**LEGAL DESCRIPTION**

**ESCROW NO.: 040101497**

The land referred to herein is situated in the  
State of Nevada, County of Douglas  
City of MINDEN described as follows:

Lot 11, as shown on the Map of DESERET UNIT NO. 1, filed for  
record in the office of the County Recorder of Douglas  
County, on April 17, 1972, as File No. 58855.

Assessors Parcel No. 1320-32-211-011

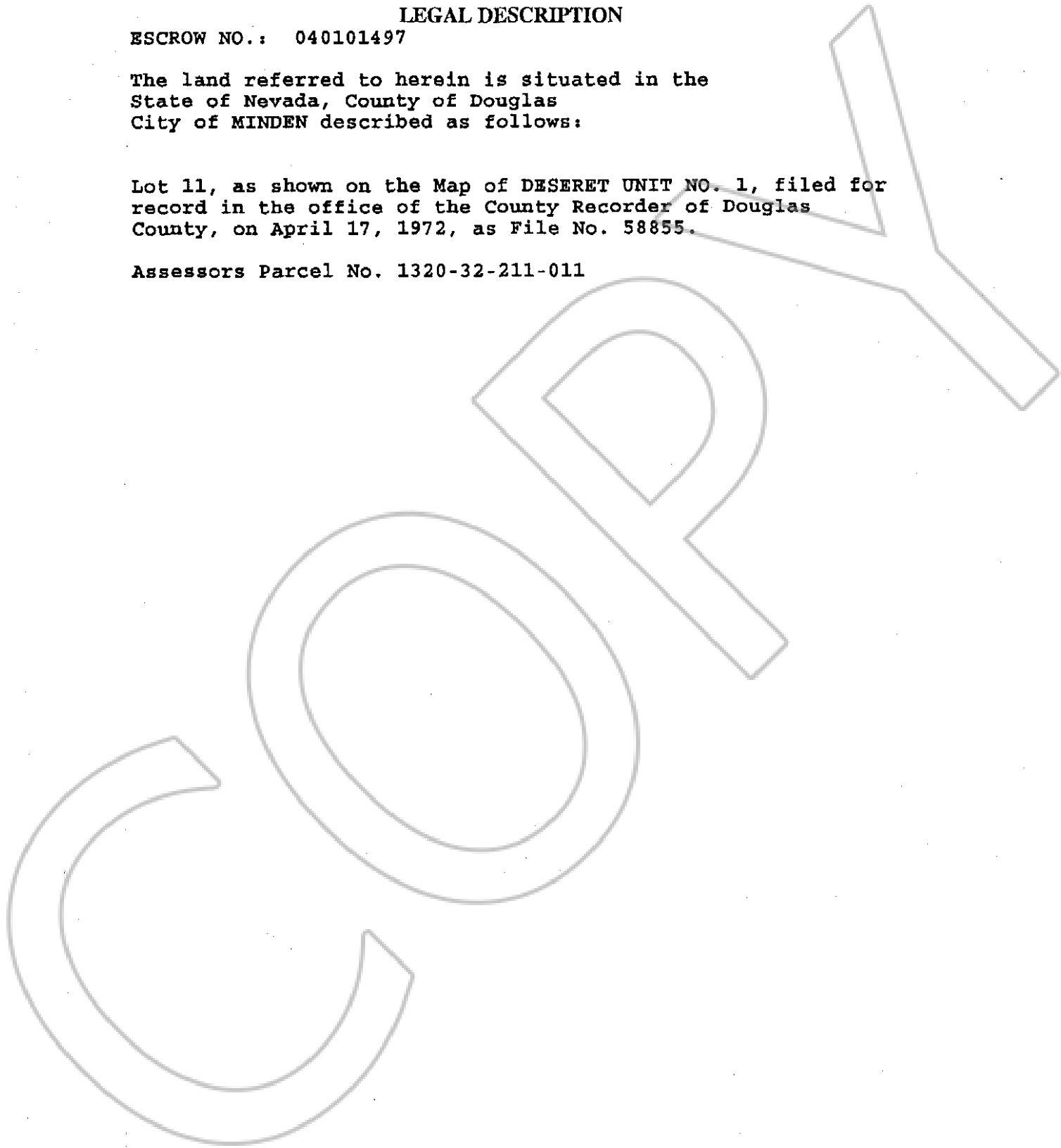

0624025

BK0904PG04632