

EXHIBIT "A"

LEGAL DESCRIPTION

ESCROW NO.: 040202478

The land referred to herein is situated in the State of Nevada, County of DOUGLAS unincorporated area described as follows:

Lot 34, in Block K, as shown on the map entitled TOPAZ RANCH ESTATES, UNIT NO. 4, filed for record November 16, 1970, in the Office of the County Recorder of Douglas County, Nevada, as Document No. 50212.

Assessor's Parcel No. 1022-16-001-119.

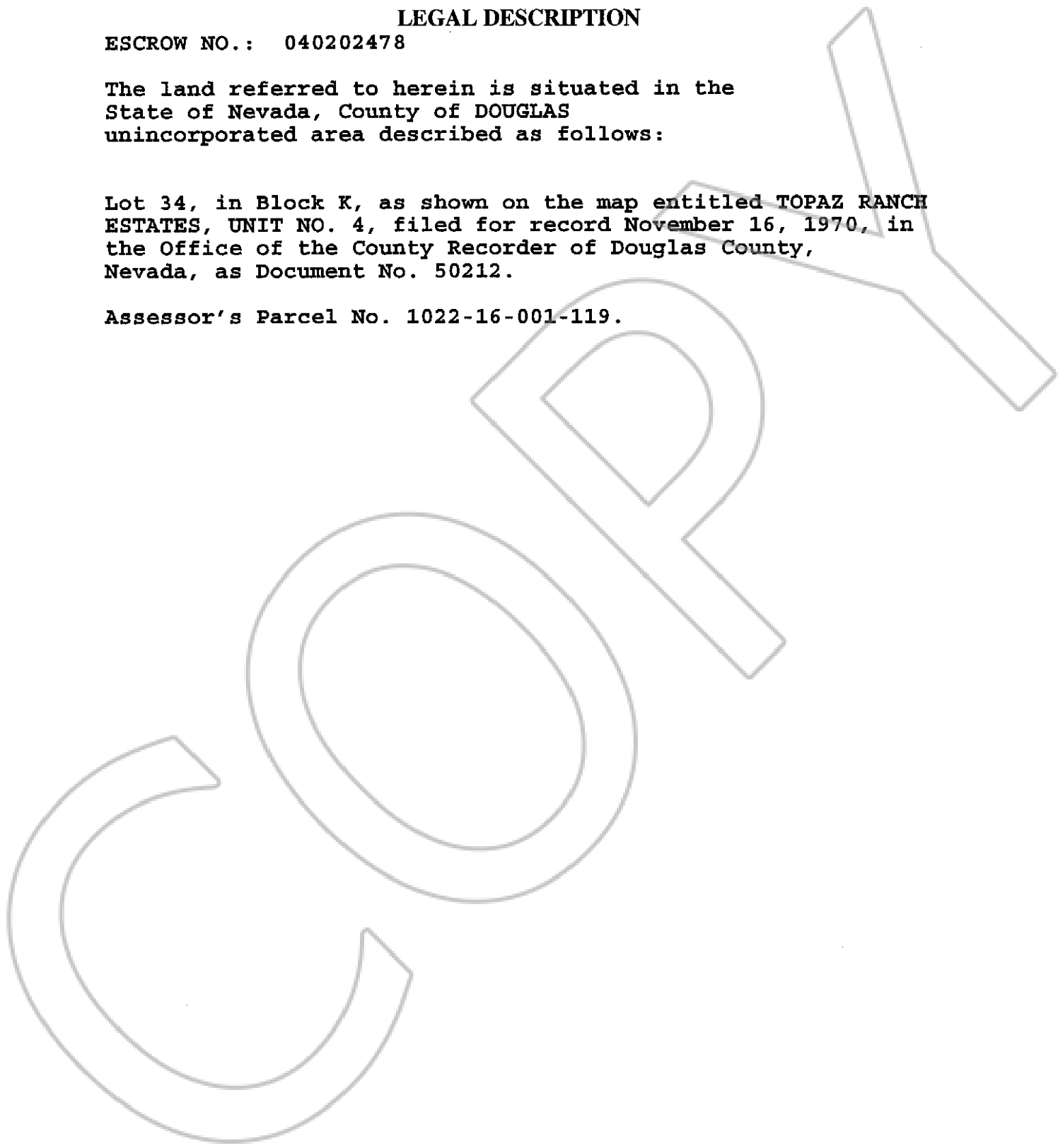

0624269

BK0904PG06079