



**EXHIBIT "A"**

**LEGAL DESCRIPTION**

**ESCROW NO.: 040201824**

The land referred to herein is situated in the  
State of Nevada, County of DOUGLAS  
City of GARDNERVILLE described as follows:

Lot 589, as shown on the official map of GARDNERVILLE RANCHOS  
UNIT NO. 6, filed for record on May 29, 1973, in the office of  
the County Recorder of Douglas County, Nevada as Document No.  
66512.

Assessors Parcel No. 1220-22-210-166

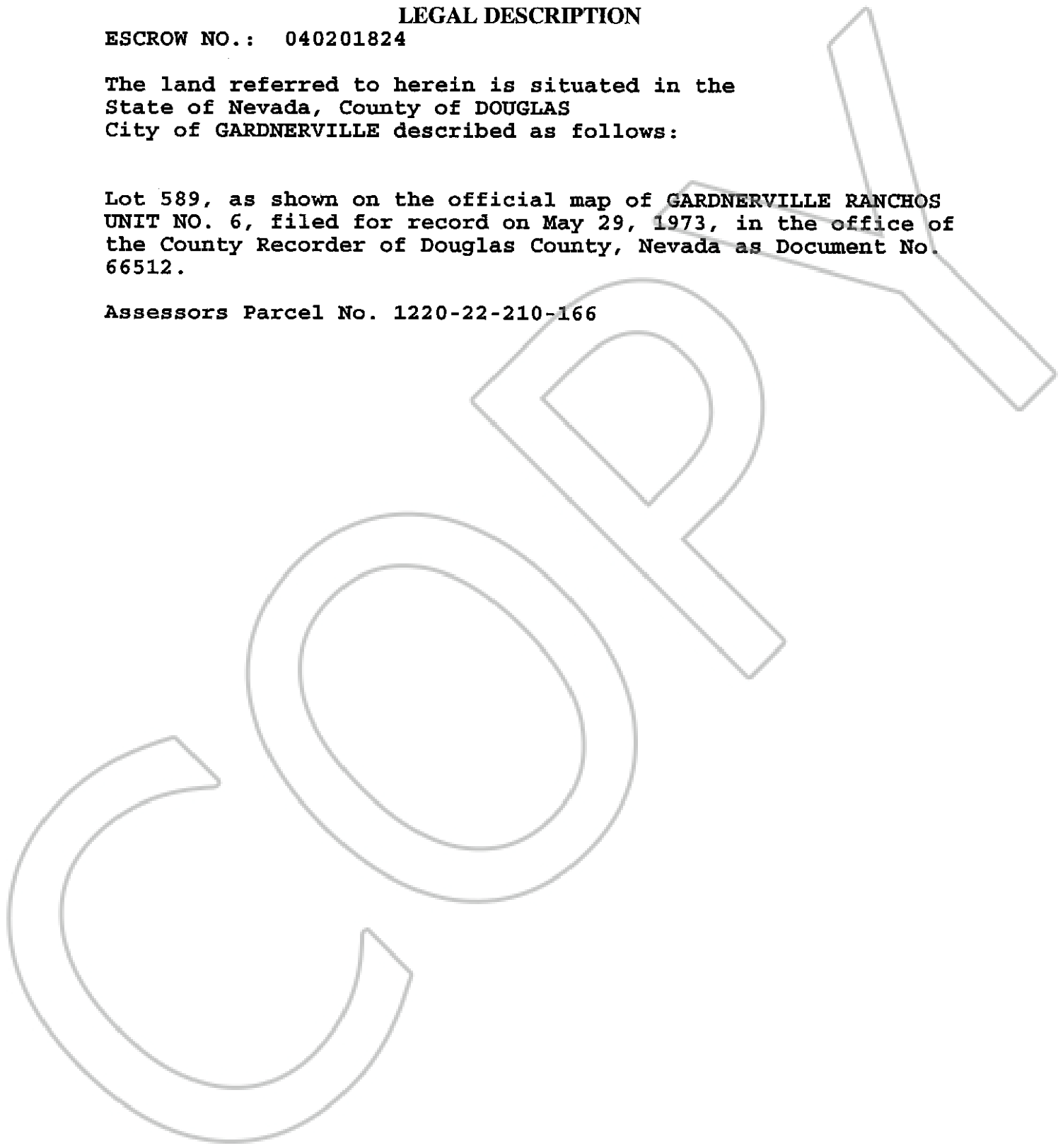

0624771

BK0904PG08628