

A.P.N. # 1220-04-515-024

R.P.T.T. \$ 865.80

ESCROW NO. 040802362

RECORDING REQUESTED BY:

STEWART TITLE COMPANY

MAIL TAX STATEMENTS TO:

SAME AS BELOW

WHEN RECORDED MAIL TO:

GRANTEE

13205 MCCARTER WAY

GRASS VALLEY, CA 95949-9767

REQUESTED BY
Stewart Title of Douglas County
IN OFFICIAL RECORDS OF
DOUGLAS CO., NEVADA

2004 SEP 23 PM 2: 52

WERNER CHRISTEN
RECORDER

\$ 150 PAID Be DEPUTY

(Space Above for Recorder's Use Only)

GRANT, BARGAIN, SALE DEED

THIS INDENTURE WITNESSETH: That **EDWARD B. SHOPE AND JOANNA C. SHOPE, HUSBAND AND WIFE**

in consideration of \$10.00, the receipt of which is hereby acknowledged, does hereby Grant, Bargain Sell and Convey to **DONALD D. ALLMANDINGER, AN UNMARRIED MAN**

and to the heirs and assigns of such Grantee forever, all that real property situated in the County of **Douglas** State of Nevada, bounded and described as:

SEE EXHIBIT "A" ATTACHED HERETO AND MADE A PART HEREOF

Together with all and singular the tenements, hereditaments and appurtenances thereunto belonging or in anywise appertaining, and any reversions, remainders, rents, issues or profits thereof.

DATE: **September 01, 2004**

Edward B. Shope
EDWARD B. SHOPE

Joanna C. Shope
JOANNA C. SHOPE

STATE OF Nevada }
COUNTY OF Douglas } SS

This instrument was acknowledged before me on 9-16-04
by EDWARD B. SHOPE and JOANNA C. SHOPE

Signature Maureen R. Lowe
Notary Public (One inch margin on all sides of document for Recorder's Use Only)

MAUREEN R. LOWE
Notary Public - State of Nevada
Appointment Number 01-67929-5
My Appt. Expires April 16, 2005

0624849

BK0904PG09062

EXHIBIT "A"

LEGAL DESCRIPTION

ESCROW NO.: 040802362

The land referred to herein is situated in the State of Nevada, County of Douglas described as follows:

Lot 33, CARSON VALLEY ESTATES UNIT NO. 3, as shown on the official map recorded in the office of the County Recorder of Douglas County, Nevada, on September 15, 1971, as Document No. 54454.

Assessor's Parcel No. 1220-04-515-024

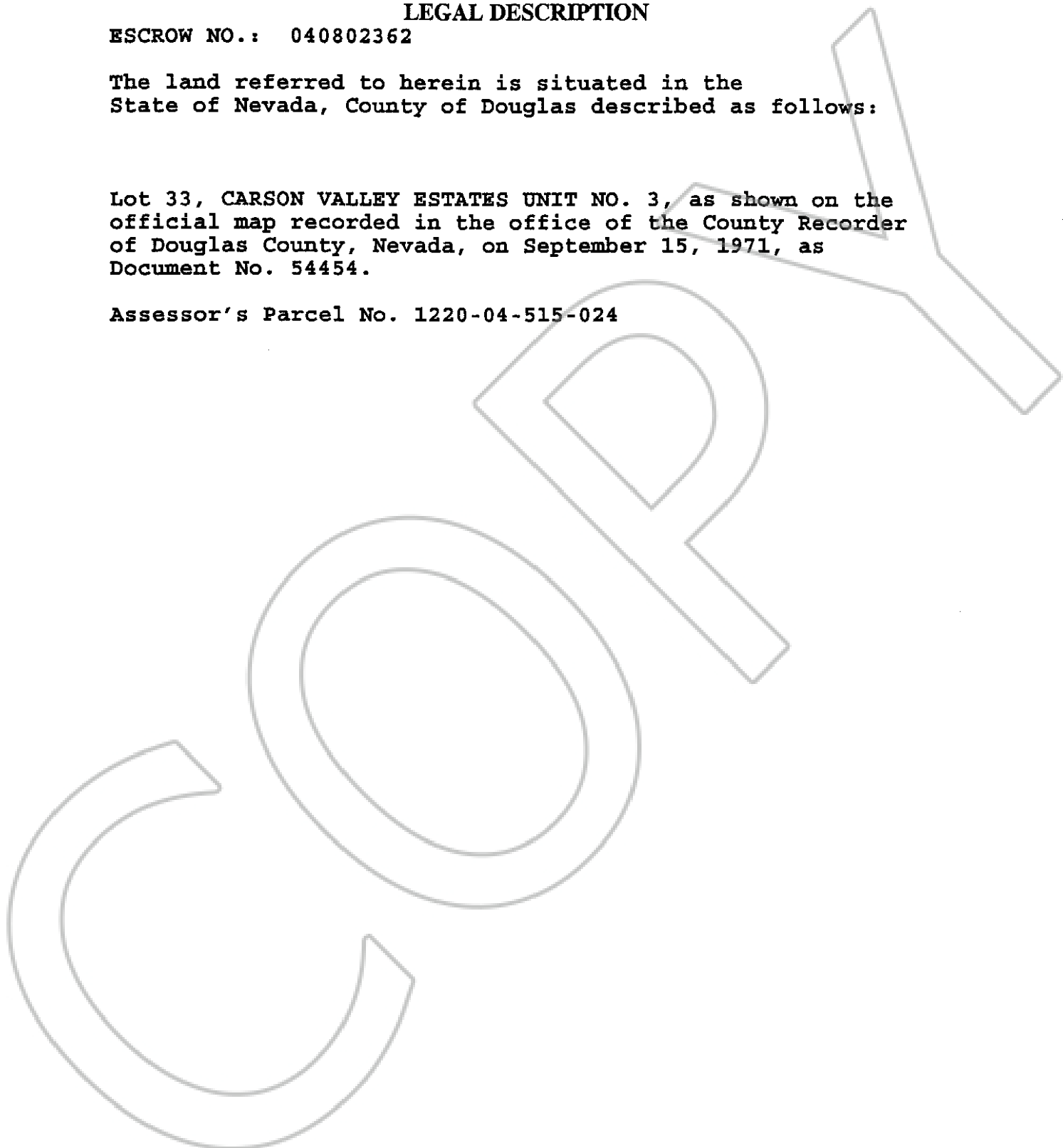

0624849

BK0904PG09063