

A.P.N. # 1022-16-001-114

R.P.T.T. \$ 657.15

ESCROW NO. 040802367

RECORDING REQUESTED BY:
STEWART TITLE COMPANY
MAIL TAX STATEMENTS TO:
SAME AS BELOW

WHEN RECORDED MAIL TO:
GRANTEE
3675 GRANITE WAY
WELLINGTON, NEVADA

REQUESTED BY
Stewart Title of Douglas County
IN OFFICIAL RECORDS OF
DOUGLAS CO., NEVADA

2004 SEP 24 PM 12:17

WERNER CHRISTEN
RECORDER

\$15⁰⁰ PAID KJ DEPUTY

(Space Above for Recorder's Use Only)

GRANT, BARGAIN, SALE DEED

THIS INDENTURE WITNESSETH: That **GUADALUPE RANGEL AND MARY RANGEL, HUSBAND AND WIFE**

in consideration of \$10.00, the receipt of which is hereby acknowledged, does hereby Grant, Bargain Sell and Convey to **CAROL L. SULWAY, an unmarried woman**

and to the heirs and assigns of such Grantee forever, all that real property situated in the County of **Douglas** State of Nevada, bounded and described as:
SEE EXHIBIT "A" ATTACHED HERETO AND MADE A PART HEREOF

Together with all and singular the tenements, hereditaments and appurtenances thereunto belonging or in anywise appertaining, and any reversions, remainders, rents, issues or profits thereof.

DATE: **September 09, 2004**

Guadalupe Rangel

GUADALUPE RANGEL

Mary Rangel

MARY RANGEL

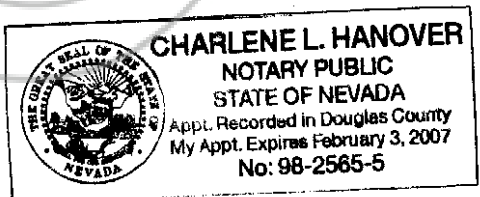

STATE OF NEVADA }
COUNTY OF DOUGLAS } ss.

This instrument was acknowledged before me on 9/20/2004,
by GUADALUPE RANGEL and MARY RANGEL

Signature *Charlene L. Hanover*
Notary Public (One inch margin on all sides of document for Recorder's Use Only)

0624973

BK0904PG09712

EXHIBIT "A"

LEGAL DESCRIPTION

ESCROW NO.: 040802367

The land referred to herein is situated in the State of Nevada, County of Douglas described as follows:

Lot 39, in Block K, as shown on the map entitled TOPAZ RANCH ESTATES, UNIT NO. 4, filed for record November 16, 1970, in the Office of the County Recorder of Douglas County, Nevada, as Document No. 50212.

Assessor's Parcel No. 1022-16-001-114

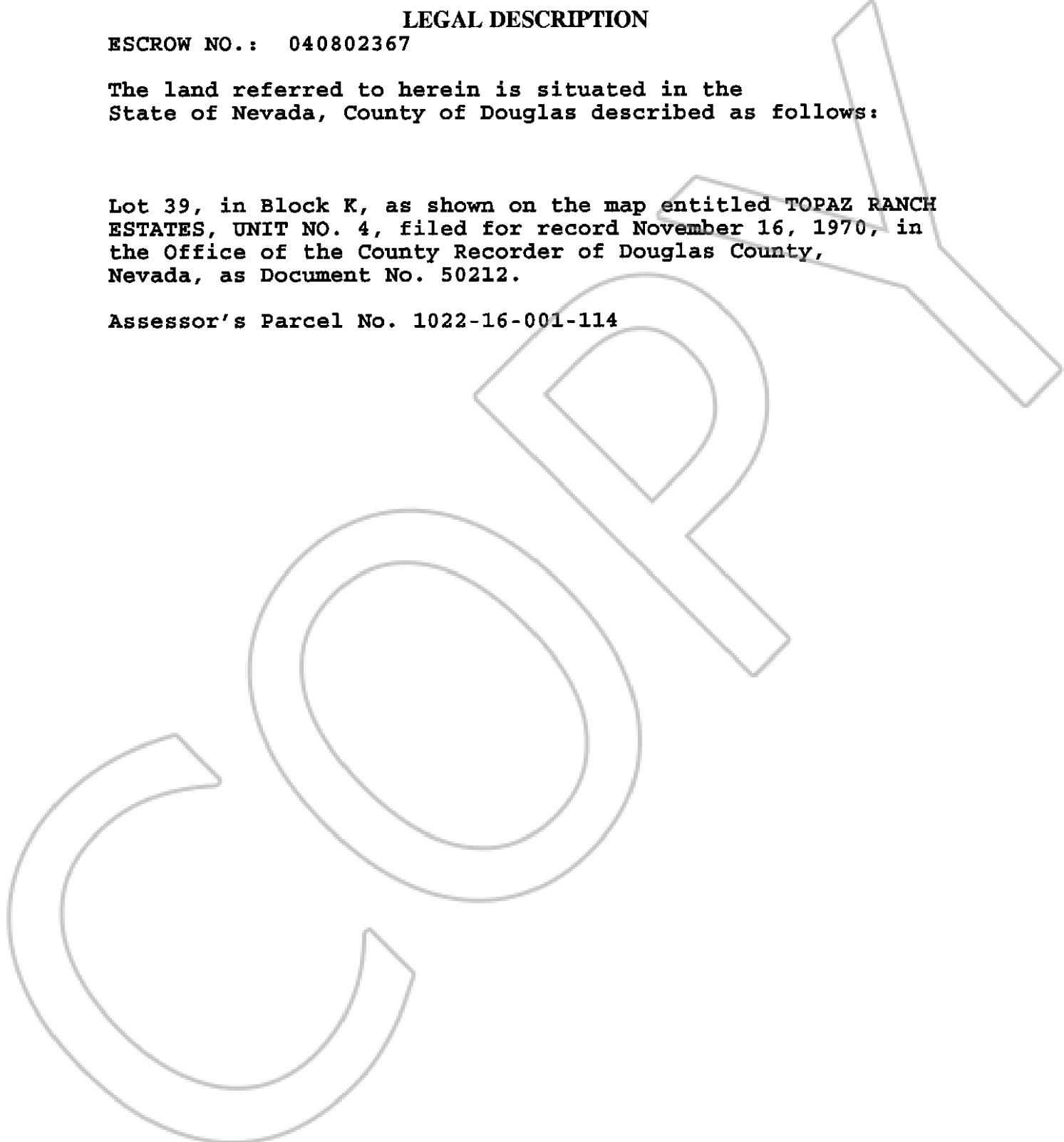

0624973
BK0904PG09713