

EXHIBIT "A"

LEGAL DESCRIPTION

ESCROW NO.: 040702737

The land referred to herein is situated in the State of Nevada, County of DOUGLAS unincorporated area described as follows:

Lot 72, as shown on the map of TOPAZ RANCH ESTATES UNIT NO. 2, filed in the Office of the County Recorder of Douglas County, Nevada, on February 20, 1967, as Document No. 35464.

Assessor's Parcel No. 1022-10-001-015.

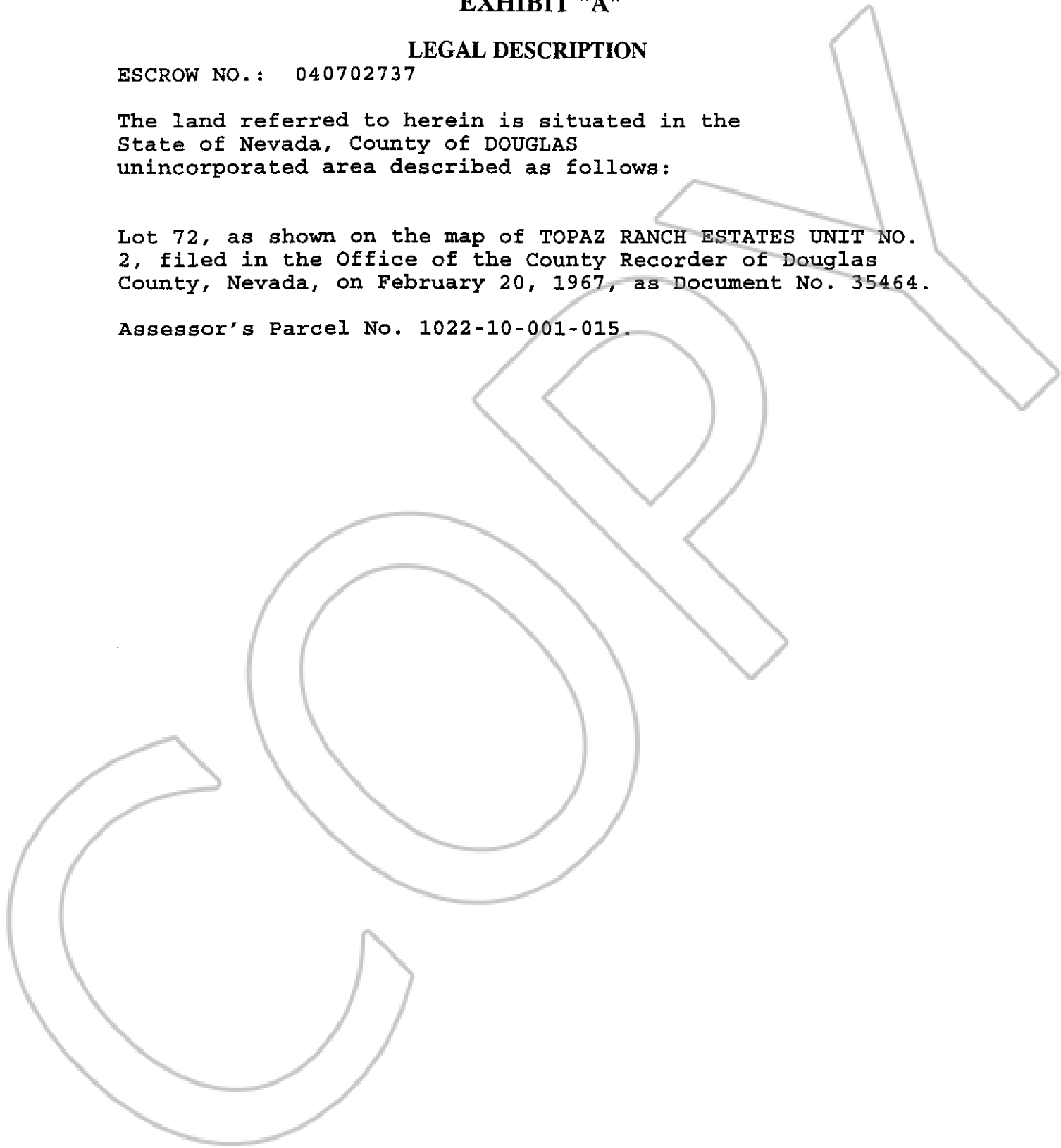

0625024

BK0904PG10083