

EXHIBIT "A"

LEGAL DESCRIPTION

The land referred to herein is situated in the State of Nevada, County of DOUGLAS described as follows:

Lot 11, Block E, as said Lot and Block are shown on the Amended map of RANCHOS ESTATES, filed in the office of the County Recorder of Douglas County, State of Nevada, on October 30, 1972, as Document No. 62493.

Assessor's Parcel No. 1220-16-210-108.

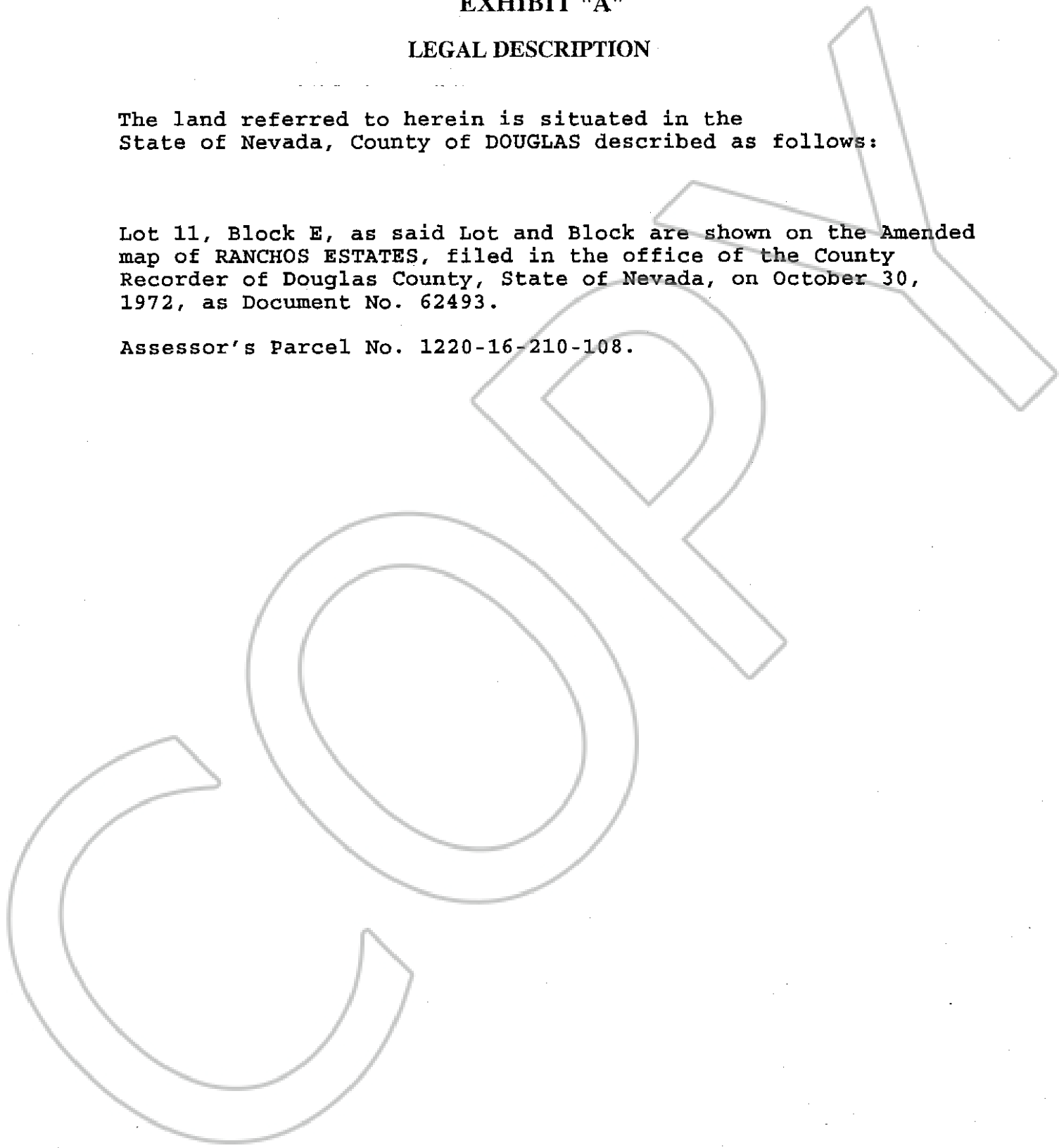

0625188

BK0904PG11050