

REQUESTED BY
WESTERN TITLE COMPANY, INC.

IN OFFICIAL RECORDS OF
DOUGLAS CO., NEVADA

APN: 1022-16-002-051

RPTT \$507.00 x Full Value Full Value less liens

2004 SEP 29 PM 3: 27

WERNER CHRISTEN
RECORDER

\$ 17⁰⁰ PAID *KJ* DEPUTY

WHEN RECORDED MAIL TO:
Name EDDY BUTLER
Street 15415 CALLE PRIMAVERA
Address
City,State GREEN VALLEY CA 91390-1019
Zip

MAIL TAX STATEMENTS TO:
Name EDDY BUTLER
Street 15415 CALLE PRIMAVERA
Address
City,State GREEN VALLEY CA 91390-1019
Zip
Order 00090350-201-LS
No.

(SPACE ABOVE THIS LINE FOR RECORDERS USE)

GRANT, BARGAIN AND SALE DEED

THIS INDENTURE WITNESSETH: That

FOR A VALUABLE CONSIDERATION, receipt of which is hereby acknowledged, ROBERT L KILBY , SURVIVING JOINT TENANT, do(es) hereby GRANT(s) BARGAIN SELL and CONVEY to EDDY BUTLER, A SINGLE MAN AND BARBARA ETHELTON, AN UNMARRIED WOMAN AS JOINT TENANTS , and to the heirs and assigns of such Grantee forever, all the following real property situated in the City of N/A, County of Douglas, State of Nevada bounded and described as follows:

See Exhibit A attached hereto and made a part hereof.

TOGETHER with all tenements, hereditaments and appurtenances, if any, thereto belonging or appertaining, and any reversions, remainders, rents, issues or profits thereof.

Dated: SEPTEMBER 22,2004

0625396

BK0904PG12294

Robert L. Kilby by Julia S. Kilby US Law ATTY in PAET.
ROBERT L KILBY

STATE OF NEVADA

COUNTY OF DOUGLAS

This instrument was acknowledged before me on
SEPTEMBER 25, 2004

by _____

Notary Public

} ss

0625396

BK0904PG12295

STATE OF NEVADA

} s.s.

COUNTY OF DOUGLAS

On SEPTEMBER 25, 2004, before me, the undersigned, a Notary Public in and for said County and State, personally appeared LESLIE S KILBY, proved to me on the basis of satisfactory evidence to be the person whose name is subscribed to the within instrument, as the Attorney in fact of ROBERT L. KILBY and acknowledged to me that HE subscribed the name of ROBERT L KILBY thereto as principal own name as Attorney in fact.

WITNESS my hand and official seal.

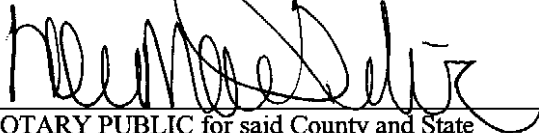

NOTARY PUBLIC for said County and State



0625396

BK0904PG12296

Exhibit A

All that real property situate in the County of Douglas, State of Nevada, described as follows:

Lot 22, in Block J, as shown on the map of TOPAZ RANCH ESTATES UNIT NO. 4, filed for record in the Office of the County Recorder of Douglas County, State of Nevada, on November 16, 1970, in Book 1 of Maps, Page 224, as Document No. 50212.

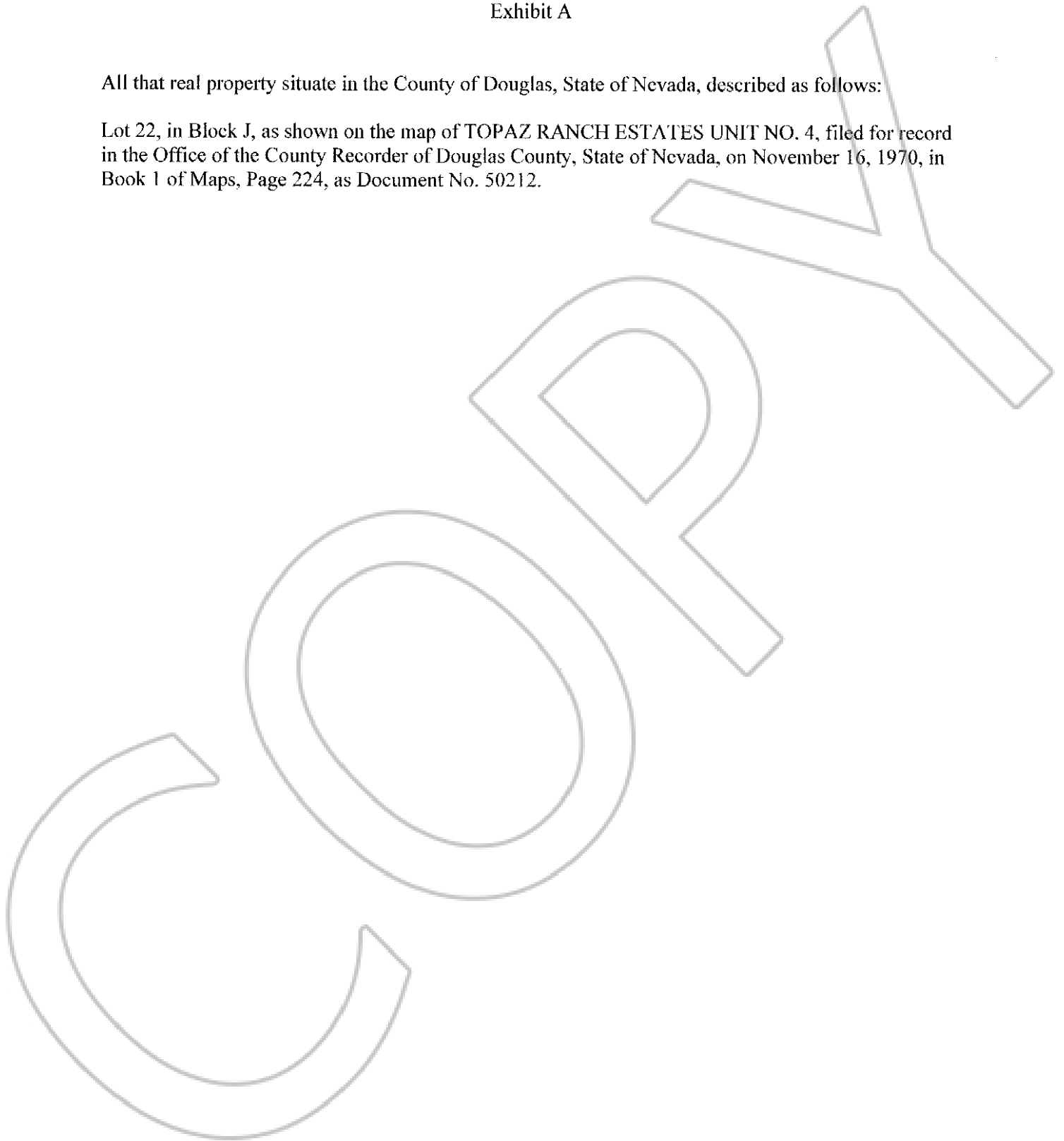

0625396

BK0904PG12297