

EXHIBIT "A"

LEGAL DESCRIPTION

ESCROW NO.: 040301921

**The land referred to herein is situated in the
State of Nevada, County of Douglas
City of GARDNERVILLE described as follows:**

**Lot 269, as shown on the official map of GARDNERVILLE
RANCHOS UNIT NO. 6, filed for record on May 29, 1973, in
the office of the County Recorder of Douglas County, Nevada
as Document No. 66512.**

Assessors Parcel No. 1220-21-510-255

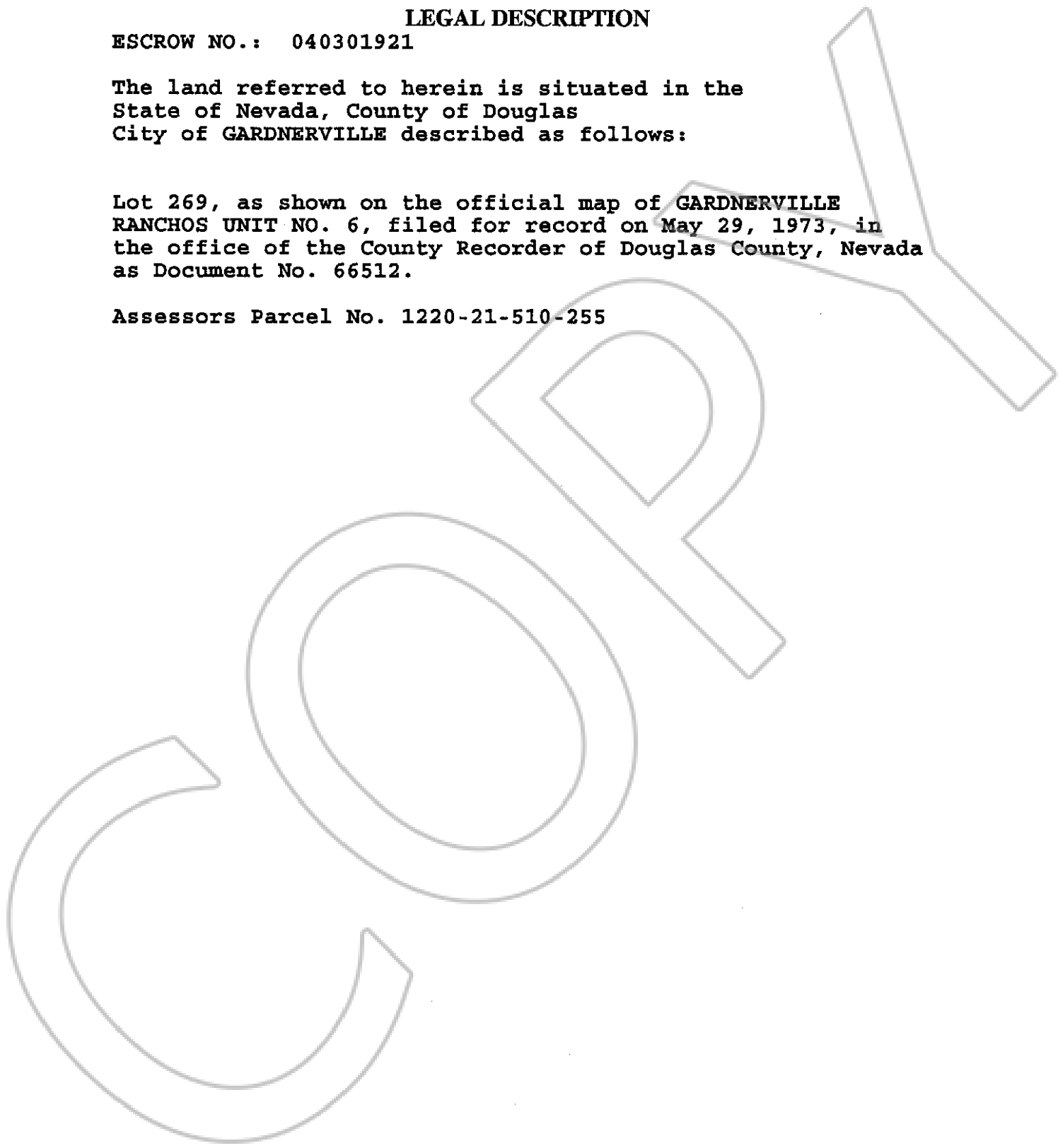

0625511
BK0904PG13040