

A.P.N. # 1320-32-113-004

R.P.T.T. \$ 2008.50

ESCROW NO. 040202461

RECORDING REQUESTED BY:
STEWART TITLE COMPANY
MAIL TAX STATEMENTS TO:
SAME AS BELOW

WHEN RECORDED MAIL TO:
Kieffer/Williams
P.O. Box 2469
Minden, NV 89423

REQUESTED BY
Stewart Title of Douglas County
IN OFFICIAL RECORDS OF
DOUGLAS CO., NEVADA

2004 OCT -1 PM 3: 22

WERNER CHRISTEN
RECORDER

\$15.00 PAID *BC* DEPUTY

(Space Above for Recorder's Use Only)

GRANT, BARGAIN, SALE DEED

THIS INDENTURE WITNESSETH: That **JOHN J. PROCACCINI AND JUDY L. PROCACCINI, HUSBAND AND WIFE AS JOINT TENANTS**

in consideration of \$10.00, the receipt of which is hereby acknowledged, does hereby Grant, Bargain Sell and Convey to **GLEN A. WILLIAMS AND CHRISTY E. KIEFFER, HUSBAND AND WIFE AS COMMUNITY PROPERTY WITH RIGHT OF SURVIVORSHIP**

and to the heirs and assigns of such Grantee forever, all that real property situated in the **unincorporated area** County of **DOUGLAS** State of Nevada, bounded and described as:
SEE EXHIBIT "A" ATTACHED HERETO AND MADE A PART HEREOF

Together with all and singular the tenements, hereditaments and appurtenances thereunto belonging or in anywise appertaining, and any reversions, remainders, rents, issues or profits thereof.

DATE: **September 13, 2004**

John J. Procaccini
JOHN J. PROCACCINI

Judy L. Procaccini
JUDY L. PROCACCINI



STATE OF Nevada }
COUNTY OF Douglas } SS

This instrument was acknowledged before me on 9-22-04
by JOHN J. PROCACCINI and JUDY L. PROCACCINI

Signature Mary H Kelsh
Notary Public (One inch margin on all sides of document for Recorder's Use Only)

0625706

BK1004PG00707

EXHIBIT "A"

LEGAL DESCRIPTION

ESCROW NO.: 040202461

The land referred to herein is situated in the State of Nevada, County of DOUGLAS unincorporated area described as follows:

Lot 9, in Block B, as said Lot and Block are shown on the Map of BELARRA SUBDIVISION, UNIT NO. 3, filed for record in the office of the County Recorder of Douglas County, State of Nevada, on September 18, 1978, as Document No. 25373.

Assessor's Parcel No. 1320-32-113-004

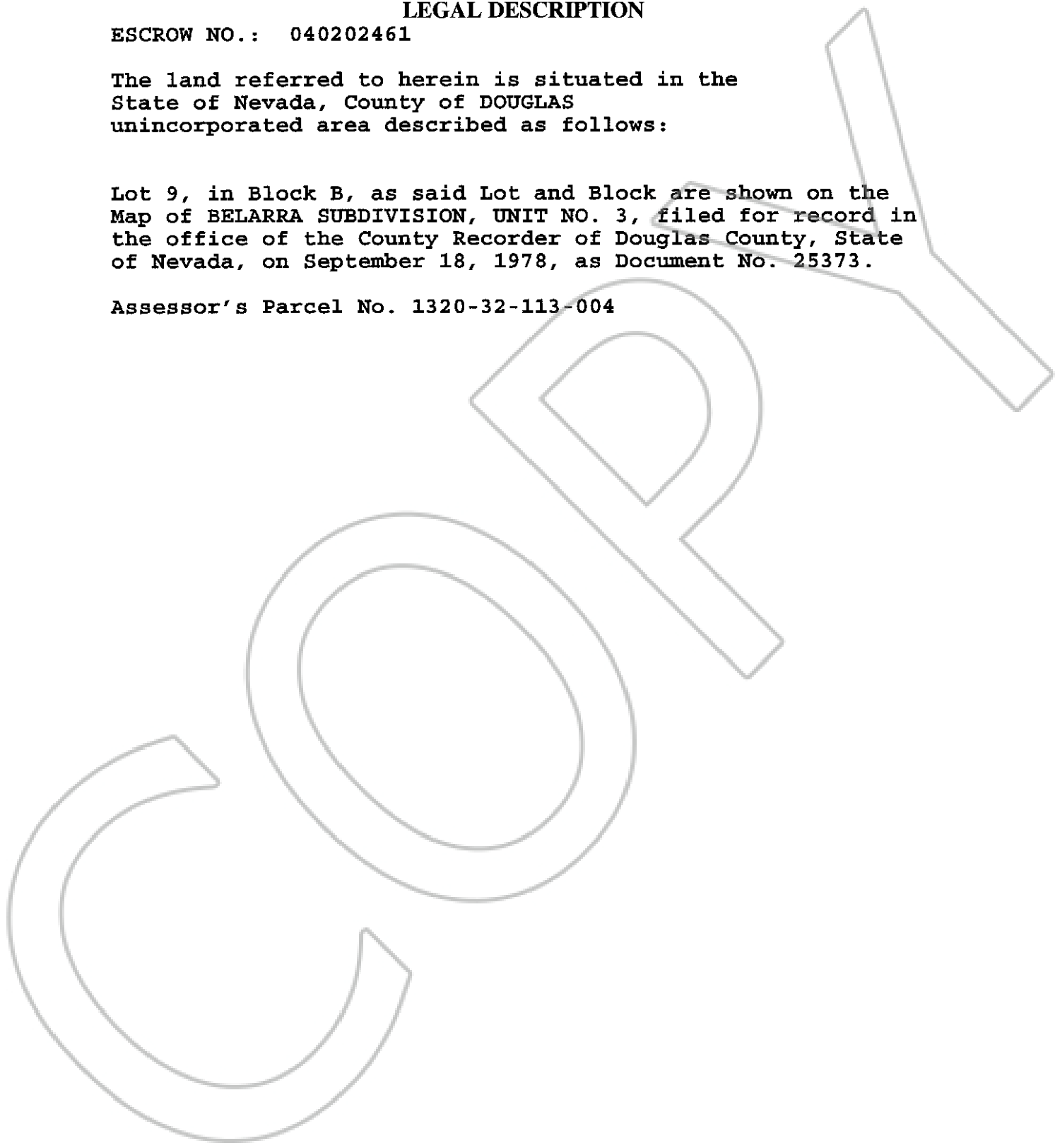

0625706

BK1004PG00708