

EXHIBIT "A"

LEGAL DESCRIPTION

ESCROW NO.: 040202464

The land referred to herein is situated in the State of Nevada, County of Douglas described as follows:

Lot 16, as shown on the map of RIVERVIEW ESTATES, filed in the Office of the Douglas County Recorder, State of Nevada, on December 15, 1965, as File No. 30403.

Assessors Parcel No. 1220-24-410-016

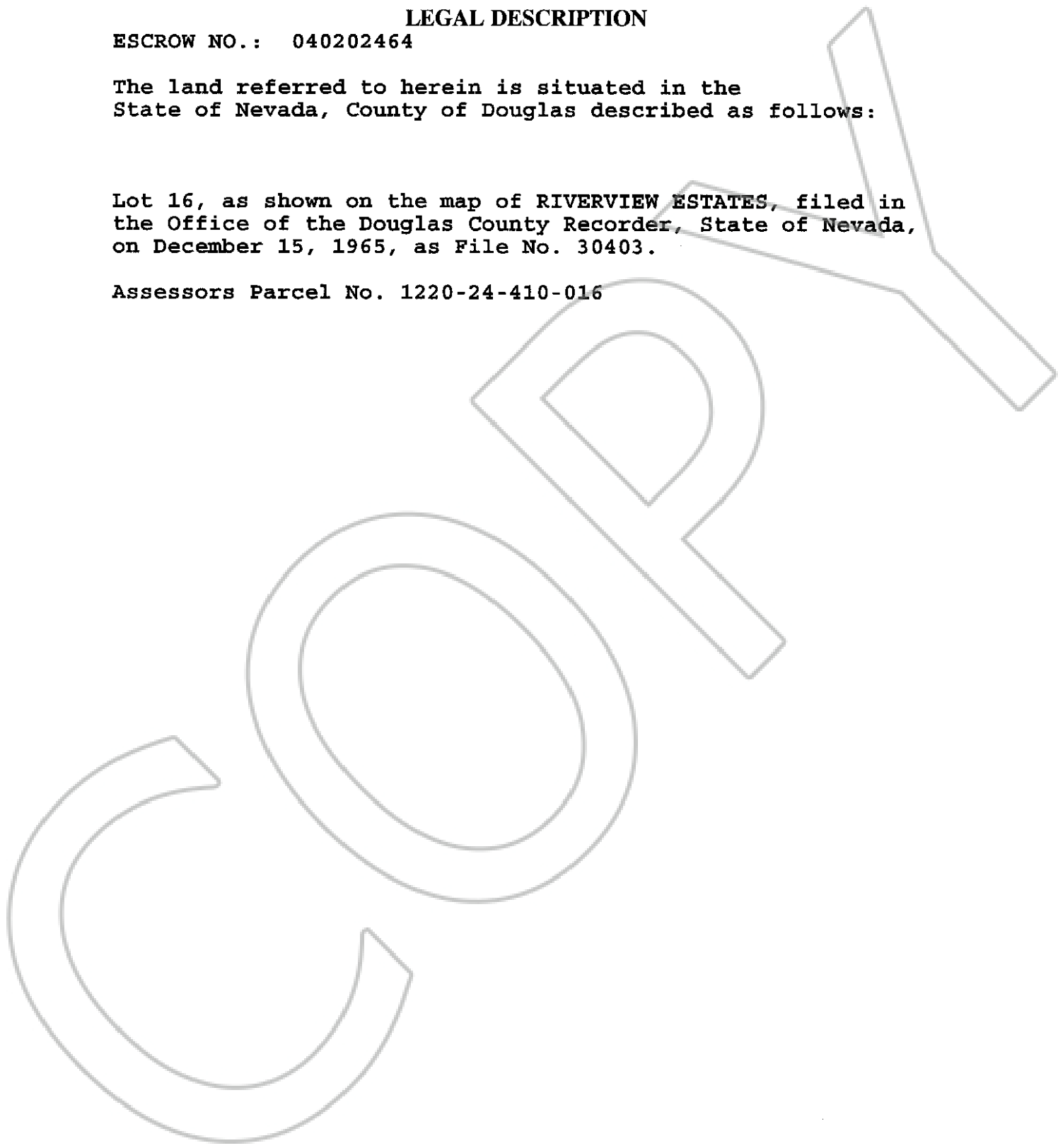

0625708
BK1004PG00729